

**USA :** Phone: 1.800.669.5430 • Fax 1.847.229.0526 • www.powerscontrols.com  
**Canada :** Phone: 1.888.208.8927 • Fax 1.888.479.2887 • www.powerscontrols.ca



Le vendeur garantit que l'équipement fabriqué par lui et couvert en vertu de cette commande ou de ce contrat est exempt de vices de matériau et de fabrication et, dans l'éventualité ou de tels vices de matériau ou de fabrication se manifesteraient, il sera réparé sans frais ou, à la discrétion du vendeur, remplacé franco à bord (FAB) de son point d'expédition d'origine (sauf si spécifié ailleurs), pourvu que ledit équipement ait été installé correctement et utilisé conformément aux instructions du vendeur et, pourvu que de tels vices ne soient pas le résultat d'une utilisation abusive ou d'une décomposition résultant d'une réaction chimique ou galvanique. LA PRÉSENTE GARANTIE EST EXPRESSE, REMPLACE ET EXCLUT TOUTE AUTRE GARANTIE OU REPRÉSENTATION EXPRESSE OU IMPLICITE. IL N'EXISTE AUCUNE GARANTIE TACITE DE QUALITÉ MARCHANDE OU D'ADAPTATION À UN BUT PARTICULIER. Le vendeur n'assume aucune responsabilité pour des réparations effectuées sur son équipement à moins qu'elles aient été effectuées par le personnel autorisé par lui ou par une autorisation écrite de lui. Le vendeur n'offre aucune garantie pour les matériaux non fabriqués par lui.

**Garantie**

**AVERTISSEMENT:** Ce produit contient des produits chimiques reconnus par l'Etat de Californie comme étant cancérogènes et pouvant provoquer des anomalies congénitales ou affecter la capacité de reproduction.  
**Pour plus d'informations:** www.watts.com/prop65

**USA:** Phone: 1.800.669.5430 • Fax 1.847.229.0526 • www.powerscontrols.com  
**Canada:** Phone: 1.888.208.8927 • Fax 1.888.479.2887 • www.powerscontrols.ca



El Vendedor garantiza que los equipos fabricados por él y cubiertos por esta orden o contrato están libres de defectos en los materiales y mano de obra y que los equipos con materiales o mano de obra defectuosos serán reparados sin cargo o a opción del Vendedor, reemplazados F.O.B. en el punto original de envío, si el Vendedor recibe una notificación por escrito de falla en el lapso de un (1) año después de la fecha de envío (a menos que se especifique en otra parte), siempre y cuando dichos equipos hayan sido correctamente instalados y utilizados de conformidad con las instrucciones del Vendedor, y siempre que dichos defectos no se deban a material o descomposición por acción química o galvanica. ESTA GARANTIA EXPRESA REEMPLAZA Y EXCLUYE CUALQUIER OTRA GARANTIA, GARANTIA GRATUITA O PROMESA, EXPRESA O IMPLICITAS. NO EXISTEN GARANTIAS IMPLICITAS DE COMERCIALIZACION O DE IDONEIDAD PARA UN PROPÓSITO EN PARTICULAR. El Vendedor no asume ninguna responsabilidad por las reparaciones hechas a los equipos del Vendedor salvo que se realicen por personal autorizado por el Vendedor o con autorización escrita del Vendedor. El Vendedor no otorga ninguna garantía con respecto a los materiales no fabricados por él.

**Garantía**

**ADVERTENCIA:** Este producto contiene sustancias químicas que en el Estado de California se conocen como causantes de cáncer y malformaciones u otros daños reproductivos.  
**Para más información:** www.watts.com/prop65

**USA:** Phone: 1.800.669.5430 • Fax 1.847.229.0526 • www.powerscontrols.com  
**Canada:** Phone: 1.888.208.8927 • Fax 1.888.479.2887 • www.powerscontrols.ca



The Seller warrants that the equipment manufactured by it and covered by this order or contract is free from defects in material and workmanship and, without charge, equipment found to be defective in material or workmanship will be repaired, or at Seller's option replaced F.O.B. original point of shipment, if written notice of failure is received by Seller within one (1) year after date of shipment (unless specifically noted elsewhere), provided said equipment has been properly installed, operated in accordance with the Seller's instructions, and provided such defects are not due to abuse or decomposition by chemical or galvanic action. THIS EXPRESS WARRANTY IS IN LIEU OF AND EXCLUDES ALL OTHER WARRANTIES, GUARANTEES, OR REPRESENTATIONS, EXPRESS OR IMPLIED, THERE ARE NO IMPLIED WARRANTIES OF MERCHANTABILITY OR OF FITNESS FOR A PARTICULAR PURPOSE. The Seller assumes no responsibility for repairs made on the Seller's equipment unless done by the Seller's authorized personnel, or by written authority from the Seller. The Seller makes no guarantee with respect to material not manufactured by it.

**Warranty**

**WARNING:** This product contains chemicals known to the State of California to cause cancer and birth defects or other reproductive harm.  
**For more information:** www.watts.com/prop65

**⚠ WARNING**  
 Read this Manual BEFORE using this equipment. Failure to read and follow all safety and use information can result in death, serious personal injury, property damage, or damage to the equipment. Keep this Manual for future reference.

**⚠ WARNING**  
**FAILURE TO COMPLY WITH PROPER INSTALLATION AND MAINTENANCE INSTRUCTIONS COULD CONTRIBUTE TO THE VALVE FAILURE, RESULTING IN INJURY AND/OR DEATH.**  
**TO ENSURE THE ACCURATE AND RELIABLE OPERATION OF THIS PRODUCT, IT IS ESSENTIAL TO:**

- Properly design the system to minimize pressure and temperature variations.
- Conduct an annual maintenance program to ensure proper operation of all critical components.
- This valve is not factory preset and can be adjusted to deliver scalding temperatures. **Check outlet temperature to ensure it does not exceed 105°F (41°C).** Make sure temperature limit stop is properly re-set to maximum 105°F (41°C) following valve maintenance or repair. Tampering with limit stop in any way may result in scalding temperature causing serious bodily harm and/or death.

**⚠ WARNING**  
**Need for Periodic Inspection: Periodic inspection by a licensed contractor is recommended. Corrosive water conditions, and/or unauthorized adjustments or repair could render the valve ineffective for service intended. Regular checking and cleaning of the valve's internal components and check stops helps assure maximum life and proper product function. Frequency of cleaning and inspection depends upon local water conditions.**

**Capacity Table\* ■**

Min. Flow to ASSE 1070	C <sub>v</sub>	10psi (69 kPa)	20psi (138 kPa)	30psi (207 kPa)	45psi (310 kPa)	60psi (414 kPa)
0.5 gpm 1.89 lpm	0.316	1.00 gpm 3.78 lpm	1.41 gpm 5.34 lpm	1.73 gpm 6.55 lpm	2.12 gpm 8.03 lpm	2.45 gpm 9.27 lpm

\*Less aerator & outlet temperature of 105°F (41°C)

**Specifications ■**

Connections .....	3/8" compression inlets with checks
Maximum Operating Pressure .....	125psi (861 kPa)
Maximum Hot Water Temperature .....	194°F (90°C)
Minimum Hot Water Supply Temp. ....	5°F (3°C) Above Set-Point
Temperature Adjustment Range .....	60 - 120°F (15 - 49°C)
Minimum Flow .....	0.5 gpm (2.2 lpm)
Cold Water Inlet Temperature Range .....	39 - 80°F (4 - 27°C)
Hot Water Inlet Temperature Range .....	120 - 180°F (49 - 82°C)
Listing .....	ASSE 1070, IAPMO cUPC
Approval Standards .....	ASSE 1070, CSA B125.3, NSF 61 Section 9 Annex G

**Installation Instructions ■**

1. Flush all piping thoroughly before installing.
2. The installation and field adjustment of TempTAP™ faucet is the responsibility of the installer and shall be carried out in accordance with the following steps.
3. Attach faucet threaded rod to faucet body.

**For 4" centers (Series 115)**

1. Place gasket and threaded rod under the base plate. Place base plate over the hole making sure boss is on the back.
2. Place washers on the threaded rod and tighten with wing nuts.
3. Install sleeve on the base plate. Split on the sleeve should be on the back.
4. Position Faucet with O-ring on the base plate. Boss on the plate goes into the notch on the faucet body.
5. Install supply tubes with check valves to hot and cold inlets. Inlets are marked "H" and "C" underneath the faucet body. Make sure O-rings are in place.

**⚠ WARNING**  
**SUPPLY TUBES –HAND TIGHTEN ONLY!** Over tightening , using lubricants or exposure to corrosive materials can damage supply tube threads and cause failure, leaking, or flood and property damage.

6. Install washer and tighten with mounting nut.
7. Make sure faucet is centered and facing forward before final tightening.
8. Connect inlet tubes to water supplies.
9. With the handle in "off" position, turn on water supplies and check for leaks.
10. Turn faucet to hot and cold water position to flush the line thoroughly. Install aerator.

**Installation Instructions (cont.) ■**

**For single hole (Series 105)**

1. Install threaded rod on the faucet body.
2. Position faucet body with o-ring on the sink.
3. Install washer and tighten with mounting nut.
4. Install supply tubes with check valves to hot and cold inlets. Inlets are marked "H" and "C" underneath the faucet body. Make sure O-rings are in place.

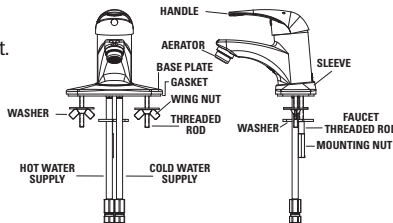

**⚠ WARNING**  
**SUPPLY TUBES –HAND TIGHTEN ONLY!** Over tightening , using lubricants or exposure to corrosive materials can damage supply tube threads and cause failure, leaking, or flood and property damage.

5. Make sure faucet is centered and facing forward before final tightening.
6. Connect inlet tubes to water supplies.
7. With the handle in "off" position, turn on water supplies and check for leaks.
8. Turn faucet to hot and cold water position to flush the line thoroughly. Install aerator.

**Temperature Adjustment ■**

Maximum temperature setting adjustment must be set on the job to no greater than 105°F (41°C).

1. Remove handle by unscrewing set screw with allen wrench provided. Remove shroud.
2. Loosen two high temperature limit stop screws.
3. Replace handle and rotate handle clockwise to desired outlet temperature.
4. Remove handle and slide high temperature limit stop on inner bonnet ring, sliding it counter clockwise until it contacts cartridge lever.

**⚠ WARNING** Do not exceed temperature above 105°F (41°C)

5. Tighten high temperature limit stop with two screws.
6. Install shroud and handle.
7. Turn handle to maximum hot position and verify temperature setting.

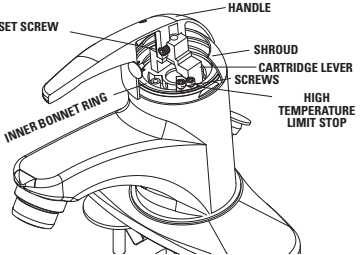

**Part List ■**

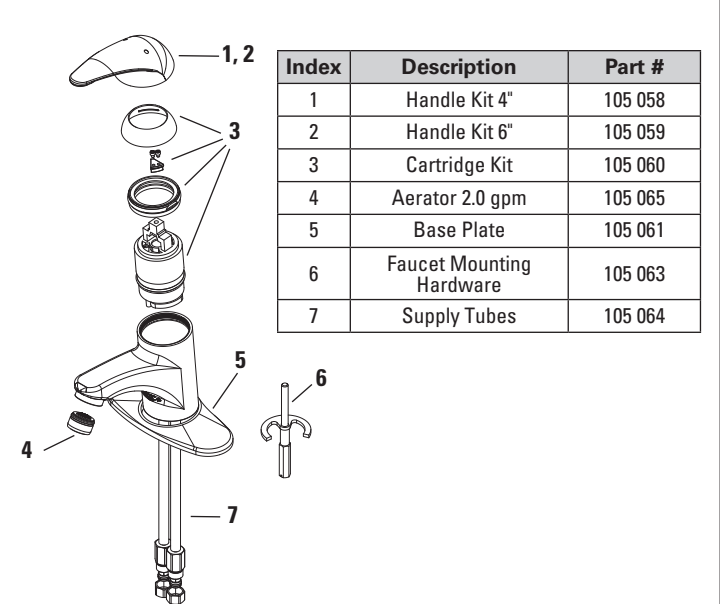

Index	Description	Part #
1	Handle Kit 4"	105 058
2	Handle Kit 6"	105 059
3	Cartridge Kit	105 060
4	Aerator 2.0 gpm	105 065
5	Base Plate	105 061
6	Faucet Mounting Hardware	105 063
7	Supply Tubes	105 064

**Troubleshooting ■**

**Faucet Drip**  
 Remove cartridge and clean sealing areas on cartridge and the faucet body. Reassemble and reset outlet temperature (refer to temperature adjustment section)

**Outlet temperature is too hot or too cold**  
 Check temperature limit stop setting (refer to temperature adjustment section)

**The flow of water is insufficient or completely shutoff**  
 Check that supply line valves are open. Remove aerator and clean.

