

Price List

Specialty Products / Strainers / Check Valves / Butterfly Valves

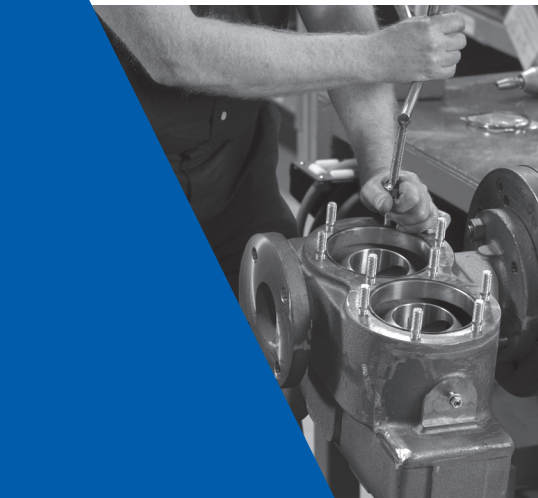
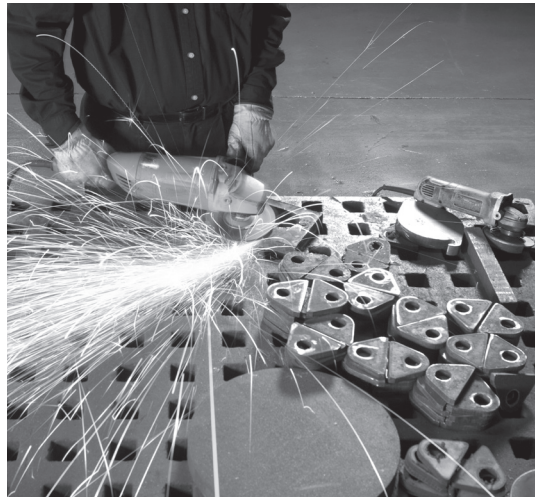

Effective May 9, 2022

All prices supersede previous issues, are temporary and subject to change without notice.

Trademarks:

- Viton® is a trademark of DuPont Performance Elastomers, L.L.C.
- Teflon® is a trademark of E. I du Pont de Nemours and Company Corporation
- Rilsan® is a trademark of Arkema Corporation
- Monel® is a trademark of Inco Alloys International, Inc.
- Inconel® is a trademark of Inco Alloys International, Inc.
- Stellite® is a trademark of Deloro Stellite Holdings Corporation
- Kynar® is a trademark of Arkema, Inc.
- Halar® is a trademark of Ausimont USA, Inc.
- Hypalon® is a trademark of Dupont Performance Elastomers L.L.C.

Mueller Steam Specialty

Standard Terms and Conditions of Sale 2-3

Strainers

Y-Strainers Iron Body	4-5
Y-Strainer Bronze Body	6-7
Y-Strainer Carbon Steel Body	8-15
Y-Strainer Stainless Steel Body	16-18
Simplex Basket Strainers Cast Iron Body.....	19-20
Simplex Basket Strainer Ductile Iron Body	21
Simplex Basket Strainer Bronze Body	21
Simplex Basket Strainer Carbon Steel Body	22-23
Simplex Basket Strainer Stainless Steel Body	24-25
Duplex Basket Strainer Cast Iron Body	26
Duplex Basket Strainer Bronze Body	27
Duplex Basket Strainer Carbon Steel Body	28-29
Duplex Basket Strainer Stainless Steel.....	30-31
Duplex Basket Strainer Spare Parts.....	32
Replacement Baskets for	
304SS Screens and Baskets	33
125, 125F Knobs	33
Replacement Gaskets	34

Specialty Products

Turbine Meter Strainers	35
UL Fireline Strainers.....	35
Temporary Strainers	36
Fabricated Strainers.....	37-38
Suction Diffusers	39-41
Control Chek®	42
Line Blind	43
LOCXEND® Grooved End Products.....	44-45

Check Valves

Double Disc Wafer Type	46-52
How to Order Sure Check™	46
Sure Check™ Cast Iron Body	47
Sure Check™ Cast Ductile Iron Body	48
Sure Check™ Bronze Body	49
Sure Check™ Carbon Steel Body	50-51
Sure Check™ Stainless Steel Body	52
CHEXTER™ Valve	53
Cast Iron	53
Carbon Steel	54-56
Stainless Steel	56
Silent Check Valve	57-65
How to Order Silent Check Valve.....	57
Center Guided Silent Check	
Cast Iron Body.....	58-61
Center Guided Silent Check	
Bronze Body.....	61
Center Guided Silent Check	
Cast Carbon Steel Body.....	62-63
Center Guided Silent Check	
Stainless Steel Body.....	64-65

Butterfly Valves

How to Order Butterfly Valves Model 88	66
Butterfly Valves Model 88	67

List and Net Price Adders

List Price Adders	
Basket Strainers Screens Adder - SS316.....	69
“Y” Strainers - 316 Stainless Steel Screen Adders.....	69
150 and 200 Mesh Lined Screen Adders - 304SS.....	70
“Y” Strainers - 1/4" Perforated screen 304SS	70
Basket Strainers - 1/4" Perforated screen 304SS.....	70
Monel Screen Adders for Basket Strainers.....	71
Monel Screen Adders For Y-Strainers.....	71
Net Price Adders	
Drilled Tapped and Plugged Gauge Ports	72
NACE Certification MR01-75.....	72
PMI Testing (Using Niton XER Portable Analyzer)	72
Oxygen Cleaning	73

Standard Terms And Conditions Of Sale

- 1. GENERAL**
- A. Written quotations are firm for a period of thirty days after date unless cancelled by the seller in writing prior to acceptance by the purchaser. Verbal quotations are subject to acceptance within 24 hours unless within that period they are confirmed in writing by the seller. Stenographic and clerical errors are subject to correction.
- B. All orders resulting from written or verbal quotations or from published price lists or literature are subject to written acceptance by an authorized individual at our office in St. Pauls, N.C.
- C. Quotations are made and orders will be accepted on a firm price basis, provided the orders are released and scheduled for shipment within a period of 5 months after the date of the order. Orders released for shipment longer than 5 months from the inception date are subject to the prices in effect on the date of shipment.
- D. Contracts or orders having penalty clauses for failure to meet shipment are not acceptable unless specifically approved in writing by an authorized individual at our office in St. Pauls, N.C.
- E. Delivery promises are based on conditions at the time of quoting and are subject to change for causes beyond the seller's control. Under no circumstance will the seller be liable for consequential damages due to failure to fulfill a delivery promise.
- F. All quotations are subject to an increase equal in amount of tax that the seller may be required to collect or pay upon the sale of the material quoted.
- G. We reserve the right to alter dimensions without notice. Send for certified drawings.
- H. Non-standard, special, and fabricated orders cannot be cancelled after acceptance by seller unless agreed upon in writing by the seller and the buyer shall be liable for up to the full purchase price in any stage of completion.
- I. The buyer shall be responsible to provide the seller with all specifications, drawings, and other data pertinent to use and acceptance of the product(s) prior to acceptance of the order by the seller. Acceptance of any changes as offered by the seller or as requested by the buyer must be in writing by the buyer before work can begin. The seller will not be responsible for any incidental or consequential damages resulting from compliant or non compliant product.
- 2. WARRANTY**
- Seller warrants each of the products and parts sold hereunder, under normal use and service, and subject to user's compliance with any operation instructions and other directions given by seller, to be free from defects in materials or workmanship for a period of one year from date of shipment from the seller's plant. Seller's liability under this warranty shall be limited, at seller's option, to repairing or replacing any such defective products F.O.B. seller's plant, St. Pauls, North Carolina, and reimbursing purchaser's shipping costs, subject to the following: (1) timely receipt of purchaser's written notice that such products are defective, (2) seller's written authorization to purchaser for the return of such products, (3) the return of such products to seller with shipping charges prepaid and (4) seller's inspection of and confirmation that such products are defective in materials or workmanship. If seller's inspection shows that the products returned are defective due to dirt, rust, or any foreign material not attributable to seller, improper usage, over tightening on thread, abuse or incorrect reassembly in the field or other cause not due to seller's improper manufacture, seller will, subject to purchaser's written authorization, repair or replace such products at cost. Seller's factory inspection and testing reports will be made available to purchaser upon request. THIS WARRANTY IS IN LIEU OF ANY OTHER WARRANTIES, EXPRESS OR IMPLIED, INCLUDING ANY IMPLIED WARRANTY OF FITNESS OR MERCHANTABILITY. SELLER SHALL NOT BE LIABLE FOR ANY SPECIAL, INCIDENTAL OR CONSEQUENTIAL DAMAGES. NO REPRESENTATIVE OR SELLER HAS AUTHORITY TO MAKE ANY REPRESENTATIONS OR WARRANTIES EXCEPT AS STATED HEREIN.
- 3. PATENTS**
- A. On parts or assemblies supplied by the seller which are made under its own patents, the seller will hold harmless the purchaser from any patent infringement suit or suits, Provided the seller is notified in writing within 10 days after any such claim is made and defense of any suit instituted against the purchaser therefor.
- B. In case the part assembly is in such suit to constitute infringement and its use by the purchaser in the manner intended by the seller is enjoined the seller will at his expense and at his option, either (1) procure for the purchaser the right to continue use, or (2) replace with non-infringing parts or assemblies or (3) make modifications to avoid infringing or (4) remove said part or assembly and refund the purchase price, transportation, and installation costs thereof. The foregoing states the seller's entire liability to the purchaser with respect to patent infringement by said part or assembly.
- 4. CANCELLATION**
- Any order or part thereof may be canceled by the purchaser upon written notice to the seller prior to 30 days before completion. Upon receipt of a cancellation notice, all work on the order or part thereof being cancelled will be stopped as promptly as reasonably possible and the purchaser will be liable for a cancellation charge computed on the basis of established prices for all completed items and for the full cost incurred by the seller up to the time of work stoppage plus 15% on incomplete items, plus a charge for packing and storing but less credit similarly computed for all standard items that can be used at that time to fill other orders and for the balance of the material as scrap.
- 5. FREIGHT ALLOWANCE**
- All shipments are F.O.B Factory.
- 6. PACKAGING**
- All material will be packed for domestic shipment without additional charge. Export shipments will be subject to additional charge for special overseas packaging. Additional charge may be imposed if required to package in accordance with government or military specifications or standards or for long time storage.
- 7. SPECIAL PRODUCTS**
- Orders for special or modified products are non-cancelable. In the event that the customer cancels an order for such products, Watts shall charge the customer an amount equal to Watts' costs and expenses incurred in performing the purchase order prior to receipt of notice of cancellation.
- 8. TERMS**
- Net 30 days from date of invoice unless otherwise agreed upon by both the seller and purchaser. Past due accounts are subject to 1% service charge per month (18% per annum).
- 9. EXPORT ORDERS**
- Special credit terms or conditions may be supplied to orders from customers located outside of the Continental United States. Please consult an authorized individual at our office in St. Pauls, N.C.
- 10. TITLE**
- Delivery of material to the carrier, consigned to the purchaser or as the purchaser may direct, will constitute transfer of title, ownership, possession and property in and to the material at such point of delivery, and such carrier will thereafter be deemed to be acting for the purchaser and the material will thereafter be at the purchaser's risk.
- 11. RETURNS**
- All claims must be made in writing within 10 days after receipt of goods. No materials may be returned to the factory without written permission being given by an authorized individual at our office in St. Pauls, N.C. A copy of the seller's authorization for return must be attached to the returned material.
- 12. MINIMUM BILLING**
- Minimum billing for complete unit will be \$100.00 net.

General Price Information

Attempting to establish list prices for all items, perforations, meshes and materials we carry would create a lengthy and confusing price sheet. As an example, we stock bodies in WC6, WC9, WC1, B-61 bronze, 304 stainless steel, Alloy 20, Hastelloy, nickel, and monel. We also stock perforated metals and meshes in many exotic materials with openings ranging from 5 microns to 1 inch.

In addition to special materials, we also fabricate strainers and check valves to your specifications. We invite inquiries.

All prices are F.O.B. St. Pauls, NC, and are subject to change without notice. Quotations are for prompt acceptance and are also subject to change without notice. See page 2 of this catalog for complete STANDARD TERMS AND CONDITIONS OF SALE.

Catalog weights and dimensions are approximate. Apply for certified drawings from the factory.

Special Price Information For Baskets & Screens

We maintain a large inventory of special materials, meshes, and perforations.

For military specification strainers or BuShip drawing items, please consult the factory.

Tagging

Special tagging is available including corrosion resistant tags. Consult our factory for prices.

Iron Body

Model 758

Class 125

Iron Body ASTM A126 Gr. B – Flanged Ends 125#

MODEL	STD. SCREEN		SIZE		LIST PRICE (Standard only)	ADDERS (ADD TO STANDARD LIST PRICE)				WEIGHT		ORDER CODE (Standard only)	ORDER CODE Import
	Material	Size	Inches	mm		ALT. SCREEN		PLUGGED BLOWOFF		lb.	kg		
						Mesh	Mesh Lined Perf	IRON	BRASS				
758	304SS Perf	0.062	3/4	20	\$605.00	N/A	\$57.25	\$6.75	\$17.50	9	4.05	M6707451	
			1	25	\$605.00	N/A	\$57.25	\$6.75	\$17.50	10	4.5	M6707452	
			1-1/4	32	\$605.00	N/A	\$57.25	\$6.75	\$17.50	13	5.85	M6700674	
			1-1/2	40	\$620.00	N/A	\$58.50	\$7.00	\$18.00	13	5.85	M6700761	
			2	50	\$428.50	N/A	\$82.00	\$6.75	\$17.50	17	7.65	M6701471	M6706955
			2-1/2	65	\$488.50	N/A	\$118.00	\$6.75	\$17.50	30	13.5	M6701637	M6706956
			3	80	\$563.50	N/A	\$139.00	\$6.75	\$17.50	36	16.2	M6702406	M6706957
			4	100	\$933.00	N/A	\$259.50	\$6.75	\$17.50	68	30.6	M6703016	M6706958
		0.125	5	125	\$1,458.00	N/A	\$573.00	\$11.50	\$33.00	102	45.9	M6703401	M6706959
			6	150	\$1,871.00	N/A	\$573.50	\$11.50	\$33.25	150	67.5	M6703745	M6706960
			8	200	\$3,135.00	N/A	\$1,004.00	\$11.50	\$33.25	270	121.5	M6704218	M6706961
			10	250	\$5,705.00	N/A	\$1,339.00	\$11.50	\$33.25	370	166.5	M6704619	M6706962
			12	300	\$8,564.00	N/A	\$1,901.00	\$11.50	\$33.25	605	272.25	M6705077	M6706963
			14	350	\$15,809.00	N/A	\$2,620.00	\$11.50	\$33.25	863	388.35	M6705362	M6707970
			16	400	\$22,434.00	N/A	POA*	POA*	POA*	1380	621	M6705580	M6707971
			18-24	450	POA*	N/A	POA*	POA*	POA*	CF	CF	CF	

Also available as Import to 16" Specify 758-N

Model 758-SW

Class 125

Iron Body – ASTM A126 Gr. B – Flanged Ends – 125# – Swing

Type Clamp Cover

MODEL	SIZE		LIST PRICE (Standard only)
	Inches	mm	
758-SW	1-1/2 – 8	40 - 200	POA*

Model 758-HC

Class 125

Iron Body – ASTM A126 Gr. B – Flanged Ends – 125# – Hinge

Type Cover

MODEL	SIZE		LIST PRICE (Standard only)
	Inches	mm	
758-HC	10 – 24	250 - 450	POA*

Model 251

Class 300

Duct Iron Body – Screwed Ends – 300#

MODEL	STD. SCREEN		SIZE		LIST PRICE (Standard only)	ADDERS (ADD TO STANDARD LIST PRICE)				WEIGHT		ORDER CODE (Standard only)
	Material	Size	Inches	mm		ALT. SCREEN		PLUGGED BLOWOFF		lb.	kg	
						Mesh	Mesh Lined Perf	CS				
251-DI	304SS Perf	0.062	1/4	6	\$612.00	N/A	\$15.75	\$13.75		2	0.9	M6726962
			3/8	10	\$612.00	N/A	\$15.75	\$13.75		2	0.9	M6700120
			1/2	15	\$612.00	N/A	\$15.75	\$13.75		2	0.9	M6700145
			3/4	20	\$477.00	N/A	\$22.50	\$13.75		2.5	1.1	M6700196
			1	25	\$683.00	N/A	\$40.75	\$13.75		4	1.80	M6700567
			1-1/4	32	\$808.50	N/A	\$42.75	\$13.75		5	2.2	M6700656
			1-1/2	40	\$839.00	N/A	\$55.75	\$13.75		7.5	3.4	M6700721
			2	50	\$1,347.00	N/A	\$81.25	\$13.75		12.0	5.4	M6701338
			2-1/2	96	\$3,841.00	N/A	\$104.50	\$20.50		22	10.0	M6701568
			3	80	\$4,357.00	N/A	\$137.50	\$20.50		33	15.0	M6702251

Optional Perforated Screens:

List prices for perforated 304SS are our standard perforations - .033, .045, .062, .125, .156
For perforations larger or smaller, Prices on Application (POA*), Call Factory (CF)

Iron Body

Model 11M

Class 250

Iron Body – ASTM A126 Gr. B – Screwed Ends – FNPT – 4" Has Bolted Cap

MODEL	STD. SCREEN		SIZE		LIST PRICE (Standard only)	ADDERS (ADD TO STANDARD LIST PRICE)		WEIGHT		ORDER CODE (Standard only)	ORDER CODE Import	
	Material	Size	Inches	mm		ALT. SCREEN		PLUGGED BLOWOFF IRON	lb.			kg
						Perf. Only	Mesh Lined Perf					
11M	304SS Mesh	20 Std., 30 Opt.	1/4	8	\$45.75	\$9.75	\$16.00	\$7.00	1.3	0.6	M6700101	M6700102
			3/8	10	\$45.75	\$9.75	\$16.00	\$7.00	1.3	0.6	M6700116	M6700117
			1/2	15	\$45.75	\$9.75	\$16.00	\$7.00	1.8	0.8	M6700137	M6700138
			3/4	20	\$53.25	\$13.75	\$22.50	\$7.00	2.8	1.2	M6700188	M6700189
			1	25	\$69.50	\$18.50	\$40.75	\$7.00	4	2	M6700555	M6700556
			1-1/4	32	\$97.50	\$22.50	\$43.00	\$7.00	6.3	3	M6700646	M6700647
			1-1/2	40	\$133.00	\$35.00	\$55.75	\$7.00	10.5	5	M6700700	M6700701
			2	50	\$199.00	\$43.00	\$81.50	\$7.00	15	7	M6701296	M6701297
	304SS Perf	0.062	2-1/2	65	\$391.50	N/A	\$104.50	\$9.75	25	11	M6701553	M670321
			3	80	\$563.00	N/A	\$137.50	\$9.75	36	16	M6702195	M6707320
			4	100	\$2,208.00	N/A	\$255.00	\$9.75	70	32	M6702808	M6746587

Also available as Import Specify 11M-N

Model 752

Class 250

Iron Body – ASTM A126 Gr. B – Flanged Ends – 250#

MODEL	STD. SCREEN		SIZE		LIST PRICE (Standard only)	ADDERS (ADD TO STANDARD LIST PRICE)		WEIGHT		ORDER CODE (Standard only)	ORDER CODE Import	
	Material	Size	Inches	mm		ALT. SCREEN		PLUGGED BLOWOFF IRON	lb.			kg
						Mesh	Mesh Lined Perf					
752	304SS Perf	0.062	3/4	20	POA*	N/A	\$57.00	\$6.75	CF	CF	M6700224	-
			1	25	POA*	N/A	\$57.00	\$6.75	CF	CF	M6700597	-
			1-1/4	32	POA*	N/A	\$57.00	\$6.75	CF	CF	M6735653	-
			1-1/2	40	POA*	N/A	\$57.00	\$6.75	24	11	M6700759	-
			2	50	\$620.00	N/A	\$82.00	\$6.75	26	12	M6701470	M6733087
			2-1/2	65	\$703.00	N/A	\$118.00	\$6.75	40	18	M6701636	M6733088
			3	80	\$844.00	N/A	\$139.00	\$6.75	59	27	M6702405	M6733089
			4	100	\$1,341.00	N/A	\$259.50	\$6.75	93	42	M6703015	M6733090
		0.125	5	125	\$2,146.00	N/A	\$573.50	\$11.50	146	66	M6703400	M6733091
			6	150	\$2,368.00	N/A	\$573.50	\$11.50	194	87	M6703744	M6733092
			8	200	\$4,378.00	N/A	\$1,004.00	\$11.50	316	142	M6704217	M6733093
			10	250	\$8,193.00	N/A	\$1,339.00	\$11.50	475	214	M6704618	M6733094
			12	300	\$12,196.00	N/A	\$1,901.00	\$11.50	750	338	M6705076	M6733095
			14-24	350	POA*	N/A	\$2,620.00	\$11.50	CF	CF	-	-

Also available as Import to 12" Specify 752-N

Optional Perforated Screens:

List prices for perforated 304SS are our standard perforations - .033, .045, .062, .125, .156
For perforations larger or smaller, Prices on Application (POA), Call Factory (CF)

Bronze Body

Model LF351

Class 125

LF Bronze Body – ASTM C87800MOD – Screwed Ends – FNPT

MODEL	STD. SCREEN		SIZE		LIST PRICE (Standard only)	ADDERS (ADD TO STANDARD LIST PRICE)				WEIGHT		ORDER CODE (Standard only)
	Material	Size	Inches	mm		ALT. SCREEN		PLUGGED BLOWOFF		lb.	kg	
						Perf. Only	Mesh Lined Perf	IRON	BRASS			
LF351	304SS Mesh	20 Mesh or 30 Mesh	1/4	8	\$100.50	\$9.00	\$14.50	N/A	CF	0.75	0.3	M6744395
			3/8	10	\$100.50	\$9.00	\$14.50	N/A	CF	0.75	0.3	M6744396
		1/2	15	\$100.50	\$9.00	\$14.50	N/A	CF	0.75	0.3	M6743767	
		3/4	20	\$123.50	\$12.50	\$20.75	N/A	CF	1.38	0.6	M6743768	
		1	25	\$182.50	\$17.00	\$37.50	N/A	CF	2.13	1.0	M6743769	
		1-1/4	32	\$290.00	\$20.75	\$39.50	N/A	CF	3.13	1.4	M6743770	
		1-1/2	40	\$391.00	\$32.00	\$51.25	N/A	CF	4.5	2.0	M6743771	
		2	50	\$512.50	\$39.50	\$74.75	N/A	CF	7	3.2	M6743772	
	304SS Perf	.062 Perf	2-1/2	65	\$1,544.00	N/A	\$96.00	N/A	CF	16	7.3	M6743773
			3	80	\$2,998.00	N/A	\$126.00	N/A	CF	34	15.4	M6741811

Also available as Import Specify LF351-N

Model LF352

Class 250

LF Bronze Body – ASTM C87800MOD - Screwed Ends – FNPT

MODEL	STD. SCREEN		SIZE		LIST PRICE (Standard only)	ADDERS (ADD TO STANDARD LIST PRICE)				WEIGHT		ORDER CODE (Standard only)
	Material	Size	Inches	mm		ALT. SCREEN		PLUGGED BLOWOFF		lb.	kg	
						Perf. Only	Mesh Lined Perf	IRON	BRASS			
LF352	304SS Mesh	20 Mesh or 30 Mesh	3/8	10	\$132.50	\$9.00	\$14.50	N/A	CF	1.13	0.5	M6744161
			1/2	15	\$132.50	\$9.00	\$14.50	N/A	CF	1.13	0.5	M6732313
		3/4	20	\$193.00	\$12.50	\$20.75	N/A	CF	1.75	0.8	M6732314	
		1	25	\$266.00	\$17.00	\$37.50	N/A	CF	2.75	1.2	M6732315	
		1-1/4	32	\$409.50	\$20.75	\$39.50	N/A	CF	4.5	2.0	M6732316	
		1-1/2	40	\$531.00	\$32.00	\$51.25	N/A	CF	6	2.7	M6732317	
		2	50	\$847.50	\$39.50	\$74.75	N/A	CF	8	3.6	M6732318	
		304SS Perf	.062 Perf	2-1/2	65	\$1,942.00	N/A	\$96.00	N/A	CF	16	7.3
	3			80	\$3,422.00	N/A	\$126.50	N/A	CF	34	15.4	M6732320

Also available as Import Specify LF352-N

Model LF358

Class 125

LF Bronze Body – ASTM C87800MOD - Solder Ends

MODEL	STD. SCREEN		SIZE		LIST PRICE (Standard only)	ADDERS (ADD TO STANDARD LIST PRICE)				WEIGHT		ORDER CODE (Standard only)
	Material	Size	Inches	mm		ALT. SCREEN		PLUGGED BLOWOFF		lb.	kg	
						Mesh	Mesh Lined Perf	IRON	BRASS			
LF358	304SS Mesh	20 Mesh or 30 Mesh	3/8	10	\$99.00	\$9.00	\$14.50	N/A	CF	1.13	0.5	-
			1/2	15	\$106.50	\$9.00	\$14.50	N/A	CF	1.13	0.5	M6732321
		3/4	20	\$141.50	\$12.50	\$20.75	N/A	CF	1.75	0.8	M6732322	
		1	25	\$188.00	\$17.00	\$37.50	N/A	CF	2.75	1.2	M6732323	
		1-1/4	32	\$338.00	\$20.75	\$39.50	N/A	CF	4.5	2.0	M6732324	
		1-1/2	40	\$415.50	\$32.00	\$51.25	N/A	CF	6	2.7	M6732325	
		2	50	\$584.00	\$39.50	\$74.75	N/A	CF	8	3.6	M6732326	
		304SS Perf	.062 Perf	2-1/2	65	\$2,117.00	N/A	\$96.00	N/A	CF	16	7.3
	3			80	\$3,172.00	N/A	\$126.00	N/A	CF	34	15.4	M6743907

Also available as Import Specify LF358-N

*The wetted surface of this product contacted by consumable water contains less than 0.25% of lead by weight.

Optional Perforated Screens:

List prices for perforated 304SS are our standard perforations - .033, .045, .062, .125, .156
For perforations larger or smaller, Prices on Application (POA*), Call Factory (CF)

Bronze Body

Model 352-1/2M **Class 125**

Bronze Body – ASTM B62 – Silbraze Ends

POA*

Model 851M **Class 150**

AL-BZ Body – ASTM B148 – Flanged Ends – 150# –
Bolted Cover

POA*

Model 852 **Class 300**

AL-BZ Body – ASTM B148 – Flanged Ends – 300# –
Bolted Cover

POA*

Optional Perforated Screens:
List prices for perforated 304SS are our standard perforations - .033, .045, .062, .125, .156
For perforations larger or smaller, Prices on Application (POA*), Call Factory (CF)

Carbon Steel Body

Model 581

Class 600

Cast Steel Body – ASTM WCB – Screwed Ends – FNPT – Gasketed Cap

MODEL	STD. SCREEN		SIZE		LIST PRICE (Standard only)	ADDERS (ADD TO STANDARD LIST PRICE)			WEIGHT		ORDER CODE (Standard only)	ORDER CODE Import
	Material	Size	Inches	mm		ALT. SCREEN		PLUGGED BLOWOFF STEEL	lb.	kg		
						Mesh	Mesh Lined Perf					
581CS	304SS Perf	.062 Perf	1/4	8	\$154.50	N/A	\$14.50	\$9.00	2	0.9	M6700109	M6700110
			3/8	10	\$154.50	N/A	\$14.50	\$9.00	2	0.9	M6700131	M6700132
			1/2	15	\$154.50	N/A	\$14.50	\$9.00	2	0.9	M6700164	M6726964
			3/4	20	\$180.50	N/A	\$20.75	\$9.00	3	1.4	M6700220	M6726967
			1	25	\$238.50	N/A	\$37.50	\$9.00	5	2.3	M6700592	M6727131
			1-1/4	32	\$323.50	N/A	\$39.50	\$9.00	7	3.2	M6700670	M6700670
			1-1/2	40	\$399.50	N/A	\$51.25	\$9.00	10	4.5	M6700754	M6726148
			2	50	\$511.50	N/A	\$74.75	\$9.00	15	6.8	M6701410	M6727230

Also available as Import Specify 581CS-N

Model 582

Class 600

Cast Steel Body ASTM WCB – Socket Weld Ends – Gasketed Cap

MODEL	STD. SCREEN		SIZE		LIST PRICE (Standard only)	ADDERS (ADD TO STANDARD LIST PRICE)			WEIGHT		ORDER CODE (Standard only)	ORDER CODE Import
	Material	Size	Inches	mm		ALT. SCREEN		PLUGGED BLOWOFF STEEL	lb.	kg		
						Mesh	Mesh Lined Perf					
582CS	304SS Perf	.062 Perf	1/4	8	\$154.50	N/A	\$14.50	\$9.00	2	0.9	M6700112	-
			3/8	10	\$154.50	N/A	\$14.50	\$9.00	2	0.9	M6700134	-
			1/2	15	\$154.50	N/A	\$14.50	\$9.00	2	0.9	M6700166	M6726414
			3/4	20	\$180.50	N/A	\$20.75	\$9.00	3	1.4	M6700222	M6726141
			1	25	\$238.50	N/A	\$37.50	\$9.00	5	2.3	M6700594	M6726142
			1-1/4	32	\$323.50	N/A	\$39.50	\$9.00	7	3.2	M6700672	M6726436
			1-1/2	40	\$399.50	N/A	\$51.25	\$9.00	10	4.5	M6700757	M6727144
			2	50	\$511.50	N/A	\$74.75	\$9.00	15	6.8	M6701412	M6726143

Also available as Import Specify 582CS-N

Model 861

Class 600

Cast Steel Body – ASTM WCB – Screwed Ends – FNPT – Gasketed Cap

MODEL	STD. SCREEN		SIZE		LIST PRICE (Standard only)	ADDERS (ADD TO STANDARD LIST PRICE)			WEIGHT		ORDER CODE (Standard only)
	Material	Size	Inches	mm		ALT. SCREEN		PLUGGED BLOWOFF STEEL	lb.	kg	
						Mesh	Mesh Lined Perf				
861	304SS Perf	.062 Perf	1/4	8	\$593.00	N/A	\$14.50	\$9.00	3	1.4	M6700114
			3/8	10	\$593.00	N/A	\$14.50	\$9.00	4	1.8	M6700135
			1/2	15	\$593.00	N/A	\$14.50	\$9.00	7	3.2	M6700173
			3/4	20	\$619.00	N/A	\$20.75	\$9.00	10	4.5	M6700237
			1	25	\$724.50	N/A	\$37.50	\$9.00	16	7.3	M6700619
			1-1/4	32	\$918.50	N/A	\$39.50	\$9.00	22	10.0	M6700686
			1-1/2	40	\$1,190.00	N/A	\$51.25	\$9.00	43	19.5	M6700778
			2	50	\$1,579.00	N/A	\$74.75	\$9.00	43	19.5	M6701515

Optional Perforated Screens:

List prices for perforated 304SS are our standard perforations - .033, .045, .062, .125, .156
For perforations larger or smaller, Prices on Application (POA*), Call Factory (CF)

Carbon Steel Body

Model 861-BC

Class 600

Cast Steel Body – ASTM WCB – Screwed Ends – FNPT – Bolted Cover

MODEL	STD. SCREEN		SIZE		LIST PRICE (Standard only)	ADDERS (ADD TO STANDARD LIST PRICE)			WEIGHT		ORDER CODE (Standard only)
	Material	Size	Inches	mm		ALT. SCREEN		PLUGGED BLOWOFF STEEL	lb.	kg	
						Mesh	Mesh Lined Perf				
861-BC	304SS Perf	.062 Perf	1/2	15	\$1,201.00	N/A	\$14.50	\$9.00	3	1.4	M6700174
			3/4	20	\$1,320.00	N/A	\$20.75	\$9.00	4	1.8	M6700238
			1	25	\$1,623.00	N/A	\$37.50	\$9.00	7	3.2	M6700620
			1-1/4	32	\$2,186.00	N/A	\$39.50	\$9.00	10	4.5	M6700687
			1-1/2	40	\$2,424.00	N/A	\$51.25	\$9.00	16	7.3	M6700779
			2	50	\$2,731.00	N/A	\$74.75	\$9.00	22	10.0	M6701516
			2-1/2	65	\$4,195.00	N/A	\$96.00	\$16.50	42	19.1	M6701659
			3	80	\$4,582.00	N/A	\$126.50	\$16.50	43	19.5	M6702444

Model 862

Class 600

Cast Steel Body – ASTM WCB – Socket Weld Ends – Gasketed Cap

MODEL	STD. SCREEN		SIZE		LIST PRICE (Standard only)	ADDERS (ADD TO STANDARD LIST PRICE)			WEIGHT		ORDER CODE (Standard only)
	Material	Size	Inches	mm		ALT. SCREEN		PLUGGED BLOWOFF STEEL	lb.	kg	
						Mesh	Mesh Lined Perf				
862	304SS Perf	.062 Perf	1/4	8	POA*	N/A	\$14.50	\$9.00	1	0.5	–
			3/8	10	POA*	N/A	\$14.50	\$9.00	1	0.5	M6733277
			1/2	15	\$654.00	N/A	\$14.50	\$9.00	2	0.9	M6700178
			3/4	20	\$680.50	N/A	\$20.75	\$9.00	4	1.8	M6700242
			1	25	\$794.50	N/A	\$37.50	\$9.00	6	2.7	M6700624
			1-1/4	32	\$1,006.00	N/A	\$39.50	\$9.00	8	3.6	M6700690
			1-1/2	40	\$1,314.00	N/A	\$51.25	\$9.00	10	4.5	M6700783
			2	50	\$1,736.00	N/A	\$74.75	\$9.00	14	6.4	M6701519

Model 862-BC

Class 600

Cast Steel Body – ASTM WCB – Socket Weld Ends – Bolted Cover

MODEL	STD. SCREEN		SIZE		LIST PRICE (Standard only)	ADDERS (ADD TO STANDARD LIST PRICE)			WEIGHT		ORDER CODE (Standard only)
	Material	Size	Inches	mm		ALT. SCREEN		PLUGGED BLOWOFF STEEL	lb.	kg	
						Mesh	Mesh Lined Perf				
862-BC	304SS Perf	.062 Perf	1/2	15	\$1,201.00	N/A	\$14.50	\$9.00	3	1.4	M6700179
			3/4	20	\$1,320.00	N/A	\$20.75	\$9.00	4	1.8	M6700243
			1	25	\$1,500.00	N/A	\$37.50	\$9.00	7	3.2	M6700625
			1-1/4	32	\$2,398.00	N/A	\$39.50	\$9.00	10	4.5	M6700691
			1-1/2	40	\$2,672.00	N/A	\$51.25	\$9.00	16	7.3	M6700784
			2	50	\$2,998.00	N/A	\$74.75	\$9.00	22	10.0	M6701520
			2-1/2	65	\$4,582.00	N/A	\$96.00	\$16.50	42	19.1	M6701661
			3	80	\$5,108.00	N/A	\$126.50	\$16.50	43	19.5	M6702446

Optional Perforated Screens:

List prices for perforated 304SS are our standard perforations - .033, .045, .062, .125, .156
For perforations larger or smaller, Prices on Application (POA*), Call Factory (CF)

Carbon Steel Body

Model 863M Class 1500

Carbon Steel Body – ASTM WCB – Screwed Ends – FNPT –

• Bolted Cover (above 1") • Screwed cap (up to 1")

MODEL	STD. SCREEN		SIZE		LIST PRICE (Standard only)	ADDERS (ADD TO STANDARD LIST PRICE)				WEIGHT		ORDER CODE (Standard only)
	Material	Size	Inches	mm		ALT. SCREEN		PLUGGED BLOWOFF		lb.	kg	
						Mesh	Mesh Lined Perf	STEEL	BRASS			
863M	304SS Perf	.062 Perf	1/2	15	\$873.50	N/A	\$14.50	\$9.00	N/A	15	6.8	M6700184
			3/4	20	\$1,077.00	N/A	\$20.75	\$9.00	N/A	15	6.8	M6700248
			1	25	\$1,395.00	N/A	\$37.50	\$9.00	N/A	22.5	10.2	M6700631
			1-1/4	32	\$3,128.00	N/A	\$39.50	\$9.00	N/A	24	10.9	M6700692
			1-1/2	40	\$3,262.00	N/A	\$51.25	\$9.00	N/A	24	10.9	M6700788
			2	50	\$3,807.00	N/A	\$74.75	\$9.00	N/A	32	14.5	M6701523

Model 864M Class 1500

Carbon Steel Body – ASTM WCB – Socket Weld Ends –

• Bolted Cover (above 1") • Screwed cap (up to 1")

MODEL	STD. SCREEN		SIZE		LIST PRICE (Standard only)	ADDERS (ADD TO STANDARD LIST PRICE)				WEIGHT		ORDER CODE (Standard only)
	Material	Size	Inches	mm		ALT. SCREEN		PLUGGED BLOWOFF		lb.	kg	
						Mesh	Mesh Lined Perf	STEEL	BRASS			
864M	304SS Perf	.062 Perf	1/2	15	\$873.50	N/A	\$14.50	\$9.00	N/A	15	6.8	M6700186
			3/4	20	\$1,077.00	N/A	\$20.75	\$9.00	N/A	15	6.8	M6700249
			1	25	\$1,395.00	N/A	\$37.50	\$9.00	N/A	22.5	10.2	M6700633
			1-1/4	32	\$3,049.00	N/A	\$39.50	\$9.00	N/A	24	10.9	–
			1-1/2	40	\$3,262.00	N/A	\$51.25	\$9.00	N/A	24	10.9	M6700789
			2	50	\$3,807.00	N/A	\$74.75	\$9.00	N/A	32	14.5	M6701524

Model 865 Class 2500

Carbon Steel Body – ASTM WCB – Screwed Ends – FNPT – Bolted Cover

POA*

Model 866 Class 2500

Carbon Steel Body – ASTM WCB – Socket Weld Ends – Bolted Cover

POA*

Optional Perforated Screens:

List prices for perforated 304SS are our standard perforations - .033, .045, .062, .125, .156
For perforations larger or smaller, Prices on Application (POA*), Call Factory (CF)

Carbon Steel Body

Model 781

Class 150

Carbon Steel Body – ASTM WCB – Flanged Ends – 150#

MODEL	STD. SCREEN		SIZE		LIST PRICE (Standard only)	ADDERS (ADD TO STANDARD LIST PRICE)				WEIGHT		ORDER CODE		
	Material	Size	Inches	mm		ALT. SCREEN		PLUGGED BLOWOFF		lb.	kg	(Standard only)	Import	
						Mesh	Mesh Lined Perf	IRON	STEEL					
781	304SS Perf	0.062	1/2	15	\$1,189.00	N/A	\$16.50	N/A	\$18.00	5.5	2.5	M6707456		
			3/4	20	\$1,328.00	N/A	\$23.25	N/A	\$18.00	10.3	4.6	M6707457		
			1	25	\$1,342.00	N/A	\$42.25	N/A	\$18.00	10.3	4.6	M6707458	M6755562	
			1-1/4	32	\$1,369.00	N/A	\$45.00	N/A	\$18.00	9.8	4.4	M6707459	N/A	
			1-1/2	40	\$1,379.00	N/A	\$58.50	N/A	\$18.00	12.5	5.7	M6707455	N/A	
			2	50	\$1,379.00	N/A	\$84.00	N/A	\$18.00	16.0	7.3	M6701495	M6726137	
			2-1/2	65	\$1,515.00	N/A	\$121.00	N/A	\$18.00	27.0	12.2	M6701644	M6727783	
			3	80	\$1,593.00	N/A	\$142.50	N/A	\$18.00	30.0	13.6	M6702428	M6726125	
		4	100	\$2,612.00	N/A	\$266.00	N/A	\$18.00	51.0	23.1	M6703033	M6726144		
		0.125	5	125	\$4,198.00	N/A	\$587.50	N/A	\$42.25	81.0	36.7	M6703404	M6727784	
			6	150	\$4,654.00	N/A	\$587.50	N/A	\$42.25	109.0	49.4	M6703754	M6726128	
			8	200	\$7,879.00	N/A	\$1,029.00	N/A	\$42.25	190.0	86.2	M6704226	M6727785	
			10	250	\$11,772.00	N/A	\$1,372.00	N/A	\$42.25	266.0	120.7	M6704622	M6729511	
			12	300	\$17,367.00	N/A	\$1,949.00	N/A	\$42.25	422.0	191.4	M6705079	M6736447	
			14-24	350	POA*	N/A	POA*	N/A	POA*	CF	CF			

Also available as Import to 12" Specify 781CS-N

Model 781-WE

Class 150

Carbon Steel Body – ASTM WCB – Butt Weld Ends – 150#

MODEL	STD. SCREEN		SIZE		LIST PRICE (Standard only)	ADDERS (ADD TO STANDARD LIST PRICE)				WEIGHT		ORDER CODE		
	Material	Size	Inches	mm		ALT. SCREEN		PLUGGED BLOWOFF		lb.	kg	(Standard only)		
						Mesh	Mesh Lined Perf	IRON	STEEL					
781WE	304SS Perf	0.062	1/2	15	\$1,341.00	N/A	\$16.50	N/A	\$18.00	3	1.4	–		
			3/4	20	\$1,496.00	N/A	\$23.25	N/A	\$18.00	9	4.1	–		
			1	25	\$1,548.00	N/A	\$42.25	N/A	\$18.00	9	4.1	M6707465		
			1-1/4	32	\$1,548.00	N/A	\$45.00	N/A	\$18.00	12	5.4	–		
			1-1/2	40	\$1,603.00	N/A	\$58.50	N/A	\$18.00	13	5.9	M6727672		
			2	50	\$1,603.00	N/A	\$84.00	N/A	\$18.00	10	4.5	M6701496		
			2-1/2	65	\$1,817.00	N/A	\$121.00	N/A	\$18.00	14	6.4	M6701645		
			3	80	\$1,914.00	N/A	\$142.50	N/A	\$18.00	21	9.5	M6702429		
		4	100	\$3,272.00	N/A	\$266.00	N/A	\$18.00	42	19.1	M6703034			
		0.125	5	125	\$3,441.00	N/A	\$587.50	N/A	\$42.25	60	27.2	–		
			6	150	\$5,597.00	N/A	\$587.50	N/A	\$42.25	115	52.2	M6703755		
			8	200	\$9,470.00	N/A	\$1,029.00	N/A	\$42.25	180	81.6	M6704227		
			10	250	\$14,153.00	N/A	\$1,372.00	N/A	\$42.25	290	131.5	M6704623		
			12	300	\$20,881.00	N/A	\$1,949.00	N/A	\$42.25	460	208.7	M6727577		
			14-24	350	POA*	N/A	POA*	N/A	POA*	CF	CF			

Optional Perforated Screens:

List prices for perforated 304SS are our standard perforations - .033, .045, .062, .125, .156
For perforations larger or smaller, Prices on Application (POA*), Call Factory (CF)

Carbon Steel Body

Model 782

Class 300

Carbon Steel Body – ASTM WCB – Flanged Ends – 300#

MODEL	STD. SCREEN		SIZE		LIST PRICE (Standard only)	ADDERS (ADD TO STANDARD LIST PRICE)				WEIGHT		ORDER CODE (Standard only)
	Material	Size	Inches	mm		ALT. SCREEN		PLUGGED BLOWOFF		lb.	kg	
						Mesh	Mesh Lined Perf	IRON	STEEL			
782	304SS Perf	0.062	1/2	15	\$1,505.00	N/A	\$16.50	N/A	\$18.00	5.5	2.5	M6727673
			3/4	20	\$2,036.00	N/A	\$23.25	N/A	\$18.00	12.25	5.6	M6707470
			1	25	\$1,807.00	N/A	\$42.25	N/A	\$18.00	13	5.9	M6707471
			1-1/4	32	\$1,978.00	N/A	\$45.00	N/A	\$18.00	18.25	8.3	M6707472
			1-1/2	40	\$2,003.00	N/A	\$58.50	N/A	\$18.00	18	8.2	M6707473
			2	50	\$2,003.00	N/A	\$84.00	N/A	\$18.00	22	10.0	M6701499
			2-1/2	65	\$2,010.00	N/A	\$121.00	N/A	\$18.00	32	14.5	M6701648
			3	80	\$2,067.00	N/A	\$142.50	N/A	\$18.00	49	22.2	M6702432
		4	100	\$3,101.00	N/A	\$266.00	N/A	\$18.00	90	40.8	M6703037	
		0.125	5	125	\$5,020.00	N/A	\$587.50	N/A	\$42.25	120	54.4	M6703406
			6	150	\$5,859.00	N/A	\$587.50	N/A	\$42.25	175	79.4	M6703758
			8	200	\$10,594.00	N/A	\$1,029.00	N/A	\$42.25	300	136.1	M6704229
			10	250	\$18,122.00	N/A	\$1,372.00	N/A	\$42.25	440	199.6	M6704625
			12	300	\$28,426.00	N/A	\$1,790.00	N/A	\$38.75	650	294.8	M6705081
			14-24	–	POA*	N/A	POA*	N/A	POA*	CF	CF	–

Also available as Import to 10" Specify 782CS-N

Model 782-WE

Class 300

Carbon Steel Body – ASTM WCB – Butt Weld Ends – 300#

MODEL	STD. SCREEN		SIZE		LIST PRICE (Standard only)	ADDERS (ADD TO STANDARD LIST PRICE)				WEIGHT		ORDER CODE (Standard only)
	Material	Size	Inches	mm		ALT. SCREEN		PLUGGED BLOWOFF		lb.	kg	
						Mesh	Mesh Lined Perf	IRON	STEEL			
782WE	304SS Perf	0.062	1/2	15	\$1,505.00	N/A	\$16.50	N/A	\$18.00	3	1.4	M6730585
			3/4	20	\$1,807.00	N/A	\$23.25	N/A	\$18.00	9	4.1	M6730586
			1	25	\$1,807.00	N/A	\$42.25	N/A	\$18.00	9	4.1	M6727674
			1-1/4	32	\$1,978.00	N/A	\$45.00	N/A	\$18.00	12	5.4	M6707472
			1-1/2	40	\$1,953.00	N/A	\$58.50	N/A	\$18.00	13	5.9	–
			2	50	\$2,003.00	N/A	\$84.00	N/A	\$18.00	10	4.5	M6701500
			2-1/2	65	\$2,010.00	N/A	\$121.00	N/A	\$18.00	14	6.4	M6701649
			3	80	\$2,067.00	N/A	\$142.50	N/A	\$18.00	21	9.5	M6702433
		4	100	\$3,101.00	N/A	\$266.00	N/A	\$18.00	42	19.1	M6703038	
		0.125	5	125	\$4,661.00	N/A	\$587.50	N/A	\$42.25	60	27.2	–
			6	150	\$5,859.00	N/A	\$587.50	N/A	\$42.25	115	52.2	M6703759
			8	200	\$9,836.00	N/A	\$1,029.00	N/A	\$42.25	180	81.6	–
			10	250	\$16,826.00	N/A	\$1,372.00	N/A	\$42.25	290	131.5	–
			12	300	\$30,941.00	N/A	\$1,949.00	N/A	\$42.25	460	208.7	M6705082
			14-24	350	POA*	N/A	POA*	N/A	POA*	CF	CF	–

Optional Perforated Screens:

List prices for perforated 304SS are our standard perforations - .033, .045, .062, .125, .156

For perforations larger or smaller, Prices on Application (POA*), Call Factory (CF)

Carbon Steel Body

Model 764

Class 600

Carbon Steel Body – ASTM WCB – Flanged Ends – 600#

MODEL	STD. SCREEN		SIZE		LIST PRICE (Standard only)	ADDERS (ADD TO STANDARD LIST PRICE)				WEIGHT		ORDER CODE (Standard only)
	Material	Size	Inches	mm		ALT. SCREEN		PLUGGED BLOWOFF		lb.	kg	
						Mesh	Mesh Lined Perf	IRON	STEEL			
764	304SS Perf	0.062	1/2	15	\$1,643.00	N/A	\$16.50	N/A	\$18.00	6	2.7	M6700171
			3/4	20	\$2,074.00	N/A	\$23.25	N/A	\$18.00	12	5.4	M6700229
			1	25	\$2,074.00	N/A	\$42.25	N/A	\$18.00	12	5.4	M6700602
			1-1/4	32	\$2,774.00	N/A	\$45.00	N/A	\$18.00	19	8.6	M6700677
			1-1/2	40	\$2,799.00	N/A	\$58.50	N/A	\$18.00	27	12.2	M6700766
			2	50	\$2,885.00	N/A	\$84.00	N/A	\$18.00	40	18.1	M6701482
			2-1/2	65	\$4,008.00	N/A	\$121.00	N/A	\$18.00	60	27.2	M6701641
			3	80	\$4,382.00	N/A	\$142.50	N/A	\$18.00	78	35.4	M6702415
		4	100	\$7,842.00	N/A	\$266.00	N/A	\$18.00	160	72.6	M6703024	
		0.125	5	125	\$11,469.00	N/A	\$587.50	N/A	\$42.25	254	115.2	–
			6	150	\$15,604.00	N/A	\$587.50	N/A	\$42.25	364	165.1	M6703752
			8	200	\$24,395.00	N/A	\$1,029.00	N/A	\$42.25	670	303.9	M3704222
			10	250	\$40,273.00	N/A	\$1,372.00	N/A	\$42.25	1090	494.4	–

Also available as Import Specify 764-N

Model 764-WE

Class 600

Carbon Steel Body – ASTM WCB – Butt Weld Ends – 600#

POA*

Model 765M

Class 900

Carbon Steel Body – ASTM WCB – Flanged Ends – 900#

POA*

Model 765M-WE

Class 900

Carbon Steel Body – ASTM WCB – Butt Weld Ends – 900#

POA*

Model 766M

Class 1500

Carbon Steel Body – ASTM WCB – Flanged Ends – 1500#

POA*

Model 766M-WE

Class 1500

Carbon Steel Body – ASTM WCB – Butt Weld Ends – 1500#

POA*

Model 767

Class 2500

Carbon Steel Body – ASTM WCB – BFlanged Ends – 2500#

POA*

Model 767-WE

Class 2500

Carbon Steel Body – ASTM WCB – Butt Weld Ends – 2500#

POA*

Optional Perforated Screens:

List prices for perforated 304SS are our standard perforations - .033, .045, .062, .125, .156
For perforations larger or smaller, Prices on Application (POA*), Call Factory (CF)

Carbon Steel Body

Model 581-SS Class 600

Stainless Steel Body – ASTM A351 CF8M – Screwed Ends – FNPT – Gasketed Cap

MODEL	STD. SCREEN		SIZE		LIST PRICE (Standard only)	ADDERS (ADD TO STANDARD LIST PRICE)				WEIGHT		ORDER CODE (Standard only)
	Material	Size	Inches	mm		ALT. SCREEN		PLUGGED BLOWOFF		lb.	kg	
						Mesh	Mesh Lined Perf	SS	BRASS			
581SS	304SS Perf	.062 Perf	1/4	8	\$321.50	N/A	\$14.50	\$16.50	N/A	2	0.9	M6700111
			3/8	10	\$321.50	N/A	\$14.50	\$16.50	N/A	2	0.9	M6700133
			1/2	15	\$338.00	N/A	\$14.50	\$16.50	N/A	2	0.9	M6700165
			3/4	20	\$413.50	N/A	\$20.75	\$31.25	N/A	3	1.4	M6700221
			1	25	\$612.50	N/A	\$37.50	\$31.25	N/A	5	2.3	M6700593
			1-1/4	32	\$741.00	N/A	\$39.50	\$37.50	N/A	7	3.2	M6700671
			1-1/2	40	\$1,069.00	N/A	\$51.25	\$37.50	N/A	10	4.5	M6700756
			2	50	\$1,587.00	N/A	\$74.75	\$57.50	N/A	15	6.8	M6701411

Also available as Import Specify 581SS-N

Model 582-SS Class 600

Stainless Steel Body – ASTM A351 CF8M – Socket Weld Ends – Gasketed Cap

MODEL	STD. SCREEN		SIZE		LIST PRICE (Standard only)	ADDERS (ADD TO STANDARD LIST PRICE)				WEIGHT		ORDER CODE (Standard only)
	Material	Size	Inches	mm		ALT. SCREEN		PLUGGED BLOWOFF		lb.	kg	
						Mesh	Mesh Lined Perf	SS	BRASS			
582SS	304SS Perf	.062 Perf	1/4	8	\$321.50	N/A	\$14.50	\$16.50	N/A	2	0.9	M6700113
			3/8	10	\$321.50	N/A	\$14.50	\$16.50	N/A	2	0.9	M6735421
			1/2	15	\$338.00	N/A	\$14.50	\$16.50	N/A	2	0.9	M6700167
			3/4	20	\$413.50	N/A	\$20.75	\$31.25	N/A	3	1.4	M6700223
			1	25	\$612.50	N/A	\$37.50	\$31.25	N/A	5	2.3	M6700595
			1-1/4	32	\$741.00	N/A	\$39.50	\$37.50	N/A	7	3.2	M6700673
			1-1/2	40	\$1,069.00	N/A	\$51.25	\$37.50	N/A	10	4.5	M6700758
			2	50	\$1,587.00	N/A	\$74.75	\$57.50	N/A	15	6.8	M6701413

Also available as Import Specify 582SS-N

Model 861-SS Class 600

Stainless Steel Body – ASTM A351 CF8M – Screwed Ends – FNPT – Screwed Cap

MODEL	STD. SCREEN		SIZE		LIST PRICE (Standard only)	ADDERS (ADD TO STANDARD LIST PRICE)				WEIGHT		ORDER CODE (Standard only)
	Material	Size	Inches	mm		ALT. SCREEN		PLUGGED BLOWOFF		lb.	kg	
						Mesh	Mesh Lined Perf	SS	BRASS			
861SS	304SS Perf	.062 Perf	1/4	8	\$857.00	N/A	\$14.50	\$16.50	N/A	3	1.4	M6700115
			3/8	10	\$857.00	N/A	\$14.50	\$16.50	N/A	4	1.8	M6700136
			1/2	15	\$857.00	N/A	\$14.50	\$16.50	N/A	7	3.2	M6700175
			3/4	20	\$971.00	N/A	\$20.75	\$31.25	N/A	10	4.5	M6700239
			1	25	\$1,236.00	N/A	\$37.50	\$31.25	N/A	16	7.3	M6700621
			1-1/4	32	\$1,501.00	N/A	\$39.50	\$37.50	N/A	22	10.0	M6700688
			1-1/2	40	\$2,063.00	N/A	\$51.25	\$37.50	N/A	43	19.5	M6700780
			2	50	\$2,821.00	N/A	\$74.75	\$57.50	N/A	43	19.5	M6701517

Model 862-SS Class 600

Stainless Steel Body – ASTM A351 CF8M – Socket Weld Ends – Screwed Cap

MODEL	STD. SCREEN		SIZE		LIST PRICE (Standard only)	ADDERS (ADD TO STANDARD LIST PRICE)				WEIGHT		ORDER CODE (Standard only)
	Material	Size	Inches	mm		ALT. SCREEN		PLUGGED BLOWOFF		lb.	kg	
						Mesh	Mesh Lined Perf	SS	BRASS			
862SS	304SS Perf	.062 Perf	1/4	8	\$795.00	N/A	\$14.50	\$16.50	N/A	3	1.4	-
			3/8	10	\$795.00	N/A	\$14.50	\$16.50	N/A	4	1.8	-
			1/2	15	\$795.00	N/A	\$14.50	\$16.50	N/A	7	3.2	M6700180
			3/4	20	\$901.00	N/A	\$20.75	\$31.25	N/A	10	4.5	M6700244
			1	25	\$1,147.00	N/A	\$37.50	\$31.25	N/A	16	7.3	M6700626
			1-1/4	32	\$1,392.00	N/A	\$39.50	\$37.50	N/A	22	10.0	M6727139
			1-1/2	40	\$1,915.00	N/A	\$51.25	\$37.50	N/A	43	19.5	M6700786
			2	50	\$2,619.00	N/A	\$74.75	\$57.50	N/A	43	19.5	M6701521

Optional Perforated Screens:

List prices for perforated 304SS are our standard perforations - .033, .045, .062, .125, .156
For perforations larger or smaller, Prices on Application (POA*), Call Factory (CF)

Carbon Steel Body

Model 861-SS-BC

Class 600

Stainless Steel Body – ASTM A351 CF8M – Screwed Ends – FNPT – Bolted Cover

MODEL	STD. SCREEN		SIZE		LIST PRICE (Standard only)	ADDERS (ADD TO STANDARD LIST PRICE)				WEIGHT		ORDER CODE (Standard only)
	Material	Size	Inches	mm		ALT. SCREEN		PLUGGED BLOWOFF		lb.	kg	
						Mesh	Mesh Lined Perf	SS	BRASS			
861SS-BC	304SS Perf	.062 Perf	1/2	15	\$1,412.00	N/A	\$14.50	\$16.50	N/A	3	1.4	M6700176
			3/4	20	\$1,552.00	N/A	\$14.50	\$16.50	N/A	4	1.8	M6700240
			1	25	\$1,763.00	N/A	\$14.50	\$16.50	N/A	7	3.2	M6700622
			1-1/4	32	\$2,908.00	N/A	\$20.75	\$31.25	N/A	10	4.5	M6700689
			1-1/2	40	\$3,392.00	N/A	\$37.50	\$31.25	N/A	16	7.3	M6700781
			2	50	\$4,493.00	N/A	\$39.50	\$37.50	N/A	22	10.0	M6734867
			2-1/2	65	\$6,517.00	N/A	\$51.25	\$37.50	N/A	43	19.5	M6701660
			3	80	\$7,045.00	N/A	\$74.75	\$57.50	N/A	43	19.5	M6702445

Model 862-SS-BC

Class 600

Stainless Steel Body – ASTM A351 CF8M – Socket Weld Ends – Bolted Cover

MODEL	STD. SCREEN		SIZE		LIST PRICE (Standard only)	ADDERS (ADD TO STANDARD LIST PRICE)				WEIGHT		ORDER CODE (Standard only)
	Material	Size	Inches	mm		ALT. SCREEN		PLUGGED BLOWOFF		lb.	kg	
						Mesh	Mesh Lined Perf	SS	BRASS			
862SS-BC	304SS Perf	.062 Perf	1/2	15	\$1,412.00	N/A	\$14.50	\$16.50	N/A	3	1.4	M6700181
			3/4	20	\$1,552.00	N/A	\$14.50	\$16.50	N/A	4	1.8	M6700245
			1	25	\$1,763.00	N/A	\$14.50	\$16.50	N/A	7	3.2	M6700627
			1-1/4	32	\$2,700.00	N/A	\$20.75	\$31.25	N/A	10	4.5	–
			1-1/2	40	\$3,392.00	N/A	\$37.50	\$31.25	N/A	16	7.3	M6700787
			2	50	\$4,493.00	N/A	\$39.50	\$37.50	N/A	22	10.0	M6701522
			2-1/2	65	\$6,517.00	N/A	\$51.25	\$37.50	N/A	42	19.1	M6731113
			3	80	\$7,045.00	N/A	\$74.75	\$57.50	N/A	43	19.5	M6702447

Model 863-M-SS

Class 1500

Stainless Steel Body – ASTM A351 CF8M – Screwed Ends – FNPT – Bolted Cover

POA*

Model 864-M-SS

Class 1500

Stainless Steel Body – ASTM A351 CF8M – Socket Weld Ends – Bolted Cover

POA*

Model 865-SS

Class 2500

Stainless Steel Body – ASTM A351 CF8M – Screwed Ends – FNPT – Bolted Cover

POA*

Model 866-SS

Class 2500

Stainless Steel Body – ASTM A351 CF8M – Socket Weld Ends – Bolted Cover

POA*

Optional Perforated Screens:

List prices for perforated 304SS are our standard perforations - .033, .045, .062, .125, .156
For perforations larger or smaller, Prices on Application (POA*), Call Factory (CF)

Stainless Steel Body

Model 781SS

Class 150

Stainless Steel Body – ASTM A351 CF8M – Flanged Ends – 150#

MODEL	STD. SCREEN		SIZE		LIST PRICE (Standard only)	ADDERS (ADD TO STANDARD LIST PRICE)				WEIGHT		ORDER CODE	
	Material	Size	Inches	mm		ALT. SCREEN		PLUGGED BLOWOFF		lb.	kg	(Standard only)	Import
						Mesh	Mesh Lined Perf	IRON	SS				
781SS	304SS Perf	0.062	1/2	15	\$1,886.00	N/A	\$16.50	N/A	\$7.00	5	2.3	M6707460	–
			3/4	20	\$2,128.00	N/A	\$23.25	N/A	\$12.50	9	4.1	M6707461	–
			1	25	\$2,157.00	N/A	\$42.25	N/A	\$13.75	10	4.5	M6707462	–
			1-1/4	32	\$2,387.00	N/A	\$45.00	N/A	\$19.25	14	6.4	M6707463	–
			1-1/2	40	\$2,481.00	N/A	\$58.50	N/A	\$23.25	17	7.7	M6707464	–
			2	50	\$2,109.00	N/A	\$84.00	N/A	\$22.00	16	7.3	M6701497	M6726539
			2-1/2	65	\$3,061.00	N/A	\$121.00	N/A	\$36.75	27	12.2	M6701646	M6727786
			3	80	\$3,971.00	N/A	\$142.50	N/A	\$40.75	30	13.6	M6702430	M6726483
		4	100	\$6,326.00	N/A	\$266.00	N/A	\$69.25	51	23.1	M6703035	M6726540	
		0.125	5	125	\$10,351.00	N/A	\$587.50	N/A	\$110.00	81	36.7	M6703405	M6746265
			6	150	\$12,150.00	N/A	\$587.50	N/A	\$148.00	109	49.4	M6703756	M6726524
			8	200	\$17,439.00	N/A	\$1,029.00	N/A	\$257.50	190	86.2	M6704228	M6727787
			10	250	\$25,295.00	N/A	\$1,372.00	N/A	\$360.50	266	120.7	M6704624	–
			12	300	\$37,941.00	N/A	\$1,949.00	N/A	\$571.50	422	191.4	M6705080	M6746128
14-24	350		POA*	N/A	POA*	N/A	POA*	CF	CF	–	–		

Also available as Import Specify 781SS-N

Model 781SS-WE

Class 150

Stainless Steel Body – ASTM A351 CF8M – Butt Weld Ends – 150#

MODEL	STD. SCREEN		SIZE		LIST PRICE (Standard only)	ADDERS (ADD TO STANDARD LIST PRICE)				WEIGHT		ORDER CODE	
	Material	Size	Inches	mm		ALT. SCREEN		PLUGGED BLOWOFF		lb.	kg	(Standard only)	
						Mesh	Mesh Lined Perf	IRON	SS				
781SSWE	304SS Perf	0.062	1/2	15	\$1,886.00	N/A	\$16.50	N/A	\$4.50	3	1.4	M6732269	
			3/4	20	\$2,128.00	N/A	\$23.25	N/A	\$12.50	9	4.1	M6732328	
			1	25	\$2,157.00	N/A	\$42.25	N/A	\$12.50	9	4.1	M6707468	
			1-1/4	32	\$2,387.00	N/A	\$45.00	N/A	\$16.50	12	5.4	M6732511	
			1-1/2	40	\$2,481.00	N/A	\$58.50	N/A	\$18.00	13	5.9	M6707469	
			2	50	\$2,109.00	N/A	\$84.00	N/A	\$13.75	10	4.5	M6701498	
			2-1/2	65	\$3,171.00	N/A	\$121.00	N/A	\$19.25	14	6.4	M6701647	
			3	80	\$4,123.00	N/A	\$142.50	N/A	\$28.75	21	9.5	M6702431	
		4	100	\$6,517.00	N/A	\$266.00	N/A	\$57.00	42	19	M6703036		
		0.125	5	125	\$9,965.00	N/A	\$587.50	N/A	\$81.25	60	27	–	
			6	150	\$12,650.00	N/A	\$587.50	N/A	\$156.00	115	52	M6703757	
			8	200	\$16,902.00	N/A	\$1,029.00	N/A	\$244.00	180	82	–	
			10	250	\$24,460.00	N/A	\$1,372.00	N/A	\$392.50	290	132	–	
			12	300	\$36,469.00	N/A	\$1,949.00	N/A	\$622.50	460	209	–	
14-24	350		POA*	N/A	POA*	N/A	POA*	CF	CF	–			

Optional Perforated Screens:

List prices for perforated 304SS are our standard perforations - .033, .045, .062, .125, .156
For perforations larger or smaller, Prices on Application (POA*), Call Factory (CF)

Stainless Steel Body

Model 782SS

Class 300

Stainless Steel Body – ASTM A351 CF8M – Flanged Ends – 300#

MODEL	STD. SCREEN		SIZE		LIST PRICE (Standard only)	ADDERS (ADD TO STANDARD LIST PRICE)				WEIGHT		ORDER CODE (Standard only)
	Material	Size	Inches	mm		ALT. SCREEN		PLUGGED BLOWOFF		lb.	kg	
						Mesh	Mesh Lined Perf	IRON	SS			
782SS	304SS Perf	0.062	1/2	15	\$2,570.00	N/A	\$16.50	N/A	\$18.00	5	2.3	M6707474
			3/4	20	\$3,779.00	N/A	\$23.25	N/A	\$18.00	12	5.4	M6707475
			1	25	\$3,847.00	N/A	\$42.25	N/A	\$18.00	13	5.9	M6707476
			1-1/2	40	\$3,200.00	N/A	\$58.50	N/A	\$18.00	22	10.0	M6707477
			2	50	\$3,200.00	N/A	\$84.00	N/A	\$18.00	22	10.0	M6701501
			2-1/2	65	\$4,148.00	N/A	\$121.00	N/A	\$18.00	35	15.9	M6701650
			3	80	\$4,361.00	N/A	\$142.50	N/A	\$18.00	49	22	M6702434
			4	100	\$7,738.00	N/A	\$266.00	N/A	\$18.00	84	38	M6703039
		0.125	5	125	\$12,280.00	N/A	\$587.50	N/A	\$42.25	114	52	–
			6	150	\$12,737.00	N/A	\$587.50	N/A	\$42.25	169	77	M6703760
			8	200	\$20,902.00	N/A	\$1,029.00	N/A	\$42.25	280	127	–
			10	250	\$30,524.00	N/A	\$1,372.00	N/A	\$42.25	425	193	–
			12	300	\$47,442.00	N/A	\$1,949.00	N/A	\$42.25	656	298	–
			14-24	–	POA*	N/A	POA*	N/A	POA*	CF	CF	–

Also available as Import Specify 782SS-N

Model 782SS-WE

Class 300

Stainless Steel Body – ASTM A351 CF8M – Butt Weld Ends – 300#

MODEL	STD. SCREEN		SIZE		LIST PRICE (Standard only)	ADDERS (ADD TO STANDARD LIST PRICE)				WEIGHT		ORDER CODE (Standard only)
	Material	Size	Inches	mm		ALT. SCREEN		PLUGGED BLOWOFF		lb.	kg	
						Mesh	Mesh Lined Perf	IRON	SS			
782SS-WE	304SS Perf	0.062	1/2	15	\$2,340.00	N/A	\$16.50	N/A	\$18.00	3	1.4	–
			3/4	20	\$3,507.00	N/A	\$23.25	N/A	\$18.00	9	4.1	–
			1	25	\$3,845.00	N/A	\$42.25	N/A	\$18.00	9	4.1	M6734548
			1-1/2	40	\$3,196.00	N/A	\$58.50	N/A	\$18.00	13	5.9	M6707478
			2	50	\$2,967.00	N/A	\$84.00	N/A	\$18.00	10	4.5	–
			2-1/2	65	\$3,998.00	N/A	\$121.00	N/A	\$18.00	14	6.4	–
			3	80	\$4,529.00	N/A	\$142.50	N/A	\$18.00	21	9.5	M6733051
			4	100	\$8,032.00	N/A	\$266.00	N/A	\$18.00	42	19.1	M6727396
		0.125	5	125	\$12,749.00	N/A	\$587.50	N/A	\$42.25	60	27.2	–
			6	150	\$12,280.00	N/A	\$587.50	N/A	\$42.25	115	52.2	–
			8	200	\$21,708.00	N/A	\$1,029.00	N/A	\$42.25	180	81.6	–
			10	250	\$31,699.00	N/A	\$1,372.00	N/A	\$42.25	290	131.5	–
			12	300	\$49,266.00	N/A	\$1,949.00	N/A	\$42.25	460	208.7	–
			14-24	350	POA*	N/A	POA*	N/A	POA*	CF	CF	–

Optional Perforated Screens:

List prices for perforated 304SS are our standard perforations - .033, .045, .062, .125, .156
For perforations larger or smaller, Prices on Application (POA*), Call Factory (CF)

Stainless Steel Body

Model 764SS

Class 600

Stainless Steel Body – ASTM A351 CF8M – Flanged Ends – 600#

MODEL	STD. SCREEN		SIZE		LIST PRICE (Standard only)	ADDERS (ADD TO STANDARD LIST PRICE)				WEIGHT		ORDER CODE (Standard only)
	Material	Size	Inches	mm		ALT. SCREEN		PLUGGED BLOWOFF		lb.	kg	
						Mesh	Mesh Lined Perf	IRON	316SS			
764SS	304SS Perf	0.062	1/2	15	\$2,639.00	N/A	\$16.50	N/A	\$18.00	6	2.7	M6700172
			3/4	20	\$3,205.00	N/A	\$23.25	N/A	\$18.00	12	5.4	–
			1	25	\$3,510.00	N/A	\$42.25	N/A	\$18.00	13	5.9	M6700605
			1-1/4	32	\$5,339.00	N/A	\$45.00	N/A	\$18.00	16	7.3	–
			1-1/2	40	\$6,326.00	N/A	\$58.50	N/A	\$18.00	27	12.2	M6727146
			2	50	\$6,326.00	N/A	\$84.00	N/A	\$18.00	39	17.7	M6727146
			2-1/2	65	\$8,626.00	N/A	\$121.00	N/A	\$18.00	60	27.2	M6701643
			3	80	\$10,061.00	N/A	\$142.50	N/A	\$18.00	75	34.0	M6702418
		0.125	4	100	\$18,015.00	N/A	\$266.00	N/A	\$18.00	160	72.6	M6703027
			5	125	\$25,973.00	N/A	\$587.50	N/A	\$42.25	260	117.9	–
			6	150	\$35,641.00	N/A	\$587.50	N/A	\$42.25	360	163.3	M6735532

Also available as Import Specify 764SS-N

Model 764SS-WE

Class 600

Stainless Steel Body – ASTM A351 CF8M – Butt Weld Ends

POA*

Model 765M-SS

Class 900

Stainless Steel Body – ASTM A351 CF8M – Flanged Ends – 900#

POA*

Model 765M-SS-WE

Class 900

Stainless Steel Body – ASTM A351 CF8M – Butt Weld Ends

POA*

Model 766M-SS

Class 1500

Stainless Steel Body – ASTM A351 CF8M – Flanged Ends – 1500#

POA*

Model 766M-SS-WE

Class 1500

Stainless Steel Body – ASTM A351 CF8M – Butt Weld Ends

POA*

Model 767SS

Class 2500

Stainless Steel Body – ASTM A351 CF8M – Flanged Ends – 2500#

POA*

Model 767SS-WE

Class 2500

Stainless Steel Body – ASTM A351 CF8M – Butt Weld Ends

POA*

Optional Perforated Screens:

List prices for perforated 304SS are our standard perforations - .033, .045, .062, .125, .156
For perforations larger or smaller, Prices on Application (POA*), Call Factory (CF)

Simplex Basket Strainers

Iron Body

Model 125

Class 125

Iron Body Basket Strainer – ASTM A126 Gr. B – Screwed Ends – FNPT – Knob Type Cover

MODEL	STD. BASKET		SIZE		LIST PRICE (Standard only)	ADDERS (ADD TO STANDARD LIST PRICE)		WEIGHT		ORDER CODE (Standard only)	ORDER CODE Import
	Material	Size	Inches	mm		ALT. SCREEN		lb.	kg		
						Mesh	Mesh Lined Perf				
125	304SS Perf	0.062	3/8	10	\$341.00	N/A	\$15.00	5	2.3	-	
			1/2	15	\$379.00	N/A	\$15.00	5	2.3	M6700142	M6733116
			3/4	20	\$481.00	N/A	\$21.25	4	1.8	M6700193	M6733117
			1	25	\$491.00	N/A	\$38.75	6	2.7	M6700561	M6733118
			1-1/4	32	\$641.50	N/A	\$41.50	10	4.5	M6700650	
			1-1/2	40	\$706.50	N/A	\$53.75	10	4.5	M6700704	M6733119
			2	50	\$844.50	N/A	\$77.25	19	8.6	M6701301	M6733120
			2-1/2	65	\$1,127.00	N/A	\$111.00	28	12.7	M6701555	M6733121
			3	80	\$1,371.00	N/A	\$131.00	47	21.3	M6702198	M6733122

Also available as Import Specify 125-N

Model 125F

Class 125

Iron Body Basket Y Strainer – ASTM A126 Gr. B – Flanged Ends – 125# – Knob Type Cover

MODEL	STD. BASKET		SIZE		LIST PRICE (Standard only)	ADDERS (ADD TO STANDARD LIST PRICE)		WEIGHT		ORDER CODE (Standard only)	ORDER CODE Import
	Material	Size	Inches	mm		ALT. SCREEN		lb.	kg		
						Mesh	Mesh Lined Perf				
125F	304SS Perf	0.062	3/4	20	\$728.50	N/A	\$21.25	9	4.1	M6709317	
			1	25	\$728.50	N/A	\$38.75	9	4.1	M6700563	M6753363
			1-1/4	32	\$909.50	N/A	\$41.50	15	6.8	M6700652	M6753364
			1-1/2	40	\$1,089.00	N/A	\$53.75	15	6.8	M6700707	M6744247
			2	50	\$1,303.00	N/A	\$77.25	26	11.8	M6701304	M6747481
			2-1/2	65	\$1,760.00	N/A	\$111.00	38	17	M6701556	M6752446
			3	80	\$1,842.00	N/A	\$131.00	62	28	M6702201	M6744608
			4	100	\$2,816.00	N/A	\$244.50	118	54	M6702811	M6753365
		0.125	5	125	\$4,276.00	N/A	\$540.00	170	77	M6703339	M6753366
			6	150	\$5,460.00	N/A	\$540.00	266	121	M6703543	M6742720
			8	200	\$9,873.00	N/A	\$945.00	518	235	M6704037	M6753367
			10	250	\$21,690.00	N/A	\$1,260.00	1110	503	M6704488	M6753368
			12 - 18	300	POA*	N/A	\$1,790.00	CF	CF	-	

Also available as import to 10" Specify 125F-N

Optional Perforated Screens:

List prices for perforated 304SS are our standard perforations - .033, .045, .062, .125, .156
For perforations larger or smaller, Prices on Application (POA*), Call Factory (CF)

Iron Body

Model 155M

Class 125

Iron Body Basket Y Strainer – ASTM A126 Gr. B – Flanged Ends – 125# – Clamp Type Cover

MODEL	STD. BASKET		SIZE		LIST PRICE (Standard only)	ADDERS (ADD TO STANDARD LIST PRICE)		WEIGHT		ORDER CODE (Standard only)	ORDER CODE Import
	Material	Size	Inches	mm		Mesh	Mesh Lined Perf	lb.	kg		
155M	304SS Perf	0.045	2	50	\$999.50	N/A	\$102.00	35	16	M6701310	M6701311
			2-1/2	65	\$1,032.00	N/A	\$111.00	32	15	M6701560	M6701561
			3	80	\$1,143.00	N/A	\$131.00	40	18	M6702206	M6702207
			4	100	\$1,598.00	N/A	\$244.50	70	32	M6702815	M6702816
	Consult Factory	5	125	\$2,146.00	N/A	\$540.00	108	49	M6703341	M6703342	
		6	150	\$2,675.00	N/A	\$519.00	136	62	M6703546	M6703547	
		8	200	\$4,330.00	N/A	\$945.00	218	99	M6704041	M6704042	
		10	250	\$7,724.00	N/A	\$1,261.00	396	180	M6704492	M6704493	
		12	300	\$13,391.00	N/A	\$1,790.00	720	327	M6704988	M6704989	
		14	350	\$19,590.00	N/A	\$2,467.00	990	449	M6705309		
		16 - 24	–	POA*	N/A	POA*	CF	CF	–		

Also available as Import to 14" Specify 155M-N

Model 165

Class 125

Iron Body Basket Strainer – ASTM A126 Gr. B – Flanged Ends – 125# – Bolted Cover

MODEL	STD. BASKET		SIZE		LIST PRICE (Standard only)	ADDERS (ADD TO STANDARD LIST PRICE)		WEIGHT		ORDER CODE (Standard only)	ORDER CODE Import
	Material	Size	Inches	mm		Mesh	Mesh Lined Perf	lb.	kg		
165	304SS Perf	0.062	2	50	\$810.50	N/A	\$102.50	32	15	M6701313	M6701314
			2-1/2	65	\$975.50	N/A	\$111.00	28	13	M6701562	M6701563
			3	80	\$1,023.00	N/A	\$131.00	37	17	M6702209	M6702210
			4	100	\$1,340.00	N/A	\$244.50	63	29	M6702817	M6702818
	Consult Factory	0.125	5	125	\$1,934.00	N/A	\$540.00	98	44	M6703343	M6703344
			6	150	\$2,277.00	N/A	\$519.00	122	55	M6703548	M6703549
			8	200	\$3,700.00	N/A	\$945.00	198	90	M6704043	M6704044
			10	250	\$7,094.00	N/A	\$1,261.00	350	159	M6704494	M6704495
			12	300	\$11,472.00	N/A	\$1,790.00	716	325	M6704990	M6704991
			14	350	\$14,922.00	N/A	\$2,467.00	1010	458	M6705310	

Also available as Import to 14" Specify 165-N

Optional Perforated Screens:

List prices for perforated 304SS are our standard perforations - .033, .045, .062, .125, .156
For perforations larger or smaller, Prices on Application (POA*), Call Factory (CF)

Ductile Iron Body

Model 166-DI Class 250

Ductile Iron Strainer – ASTM A395 – Flanged Ends – 250# – Bolted Cover

MODEL	STD. SCREEN		SIZE		LIST PRICE (Standard only)	ADDERS (ADD TO STANDARD LIST PRICE)		WEIGHT		ORDER CODE (Standard only)
	Material	Size	Inches	mm		ALT. SCREEN		lb.	kg	
						Mesh	Mesh Lined Perf			
166-DI	304SS Perf	0.062	2	50	\$1,755.00	N/A	\$102.00	40	18	M6701315
			2-1/2	65	\$1,853.00	N/A	\$111.00	30	14	M6709312
			3	80	\$2,080.00	N/A	\$131.00	52	24	M6709307
			4	100	\$2,855.00	N/A	\$244.50	90	41	M6702820
		0.125	5	125	\$3,567.00	N/A	\$540.00	128	58	M6735113
			6	150	\$4,582.00	N/A	\$519.00	224	102	M6709309
			8	200	\$7,045.00	N/A	\$945.00	240	109	M6709310
			10	250	\$11,842.00	N/A	\$1,261.00	460	209	M6709311
			12	300	\$22,876.00	N/A	\$1,790.00	854	387	–
			14	350	\$31,687.00	N/A	\$2,467.00	1182	536	M6735616
			16	–	POA*	N/A	POA*	CF	CF	–

Bronze Body

Model 125-B Class 150

Bronze Body – ASTM B62 – Screwed Ends – FNPT – 150# – Knob Type Cover

POA*

Model 125F-B Class 150

Bronze Body – ASTM B62 – Flanged Ends – 150# – Knob Type Cover

POA*

Model 165-B Class 150

Bronze Body – ASTM B62 – Flanged Ends – 150# – Bolted Cover

POA*

Model 126F-B Class 300

Bronze Body – ASTM B62 – Flanged Ends – 300# – Bolted Cover

POA*

Model 166-B Class 300

Bronze Body – ASTM B62 – Flanged Ends – 300# – Bolted Cover

POA*

Optional Perforated Screens:

List prices for perforated 304SS are our standard perforations - .033, .045, .062, .125, .156
For perforations larger or smaller, Prices on Application (POA*), Call Factory (CF)

Carbon Steel Body

Model 125-CS

Class 150

Carbon Steel Basket Strainer – ASTM WCB – Screwed Ends – FNPT – Knob Type Cover

MODEL	STD. BASKET		SIZE		LIST PRICE (Standard only)	ADDERS (ADD TO STANDARD LIST PRICE)		WEIGHT		ORDER CODE (Standard only)
	Material	Size	Inches	mm		Mesh	Mesh Lined Perf	lb.	kg	
125-CS	304SS Perf	0.062	3/8	10	\$575.00	N/A	\$15.00	5	2.3	–
			1/2	15	\$619.00	N/A	\$15.00	5	2.3	M6700143
			3/4	20	\$619.00	N/A	\$21.25	5	2.3	M6700194
			1	25	\$831.00	N/A	\$38.75	7	3.2	M6700562
			1-1/4	32	\$1,236.00	N/A	\$41.50	12	5.4	M6700653
			1-1/2	40	\$1,236.00	N/A	\$53.75	12	5.4	M6700705
			2	50	\$1,721.00	N/A	\$77.25	23	10.4	M6701302
			2-1/2	65	\$2,468.00	N/A	\$111.00	34	15.4	–
3	80	\$3,172.00	N/A	\$131.00	51	23.1	M6702199			

Model 125F-CS

Class 150

Carbon Steel Basket Strainer – ASTM WCB – Flanged Ends – 150# – Knob Type Cover

MODEL	STD. BASKET		SIZE		LIST PRICE (Standard only)	ADDERS (ADD TO STANDARD LIST PRICE)		WEIGHT		ORDER CODE (Standard only)
	Material	Size	Inches	mm		Mesh	Mesh Lined Perf	lb.	kg	
125F-CS	304SS Perf	0.062	3/4	20	\$1,393.00	N/A	\$21.25	10	4.5	–
			1	25	\$1,501.00	N/A	\$38.75	10	4.5	M6700564
			1-1/4	32	\$1,236.00	N/A	\$41.50	16	7.3	M6700653
			1-1/2	40	\$2,557.00	N/A	\$53.75	16	7.3	M6700708
			2	50	\$3,172.00	N/A	\$77.25	25	11.3	M6701305
			2-1/2	65	\$2,468.00	N/A	\$111.00	41	19	–
			3	80	\$5,108.00	N/A	\$131.00	65	29	M6702202
			4	100	\$7,222.00	N/A	\$244.50	135	61	M6702813
		0.125	5	125	POA*	N/A	POA*	CF	CF	–
			6	150	\$13,205.00	N/A	\$540.00	270	122	M6703544
			8	200	\$21,126.00	N/A	\$945.00	497	225	M6704038
			10	250	\$42,247.00	N/A	\$1,260.00	1045	474	M6704489
			12 - 18	300	POA*	N/A	POA*	CF	CF	–

Model 185

Class 150

Carbon Steel Basket Strainer – ASTM WCB – Flanged Ends – 150# – Bolted Cover

MODEL	STD. BASKET		SIZE		LIST PRICE (Standard only)	ADDERS (ADD TO STANDARD LIST PRICE)		WEIGHT		ORDER CODE	ORDER CODE
	Material	Size	Inches	mm		Mesh	Mesh Lined Perf	lb.	kg	(Standard only)	Import
185	304SS Perf	0.062	1-1/2	40	\$1,837.00	N/A	\$53.75	23	10.4	M6700713	M6753211
			2	50	\$1,943.00	N/A	\$77.25	34	15.4	M6701316	M6753143
			2-1/2	65	\$2,429.00	N/A	\$111.00	34	15	M6701565	M6701566
			3	80	\$3,056.00	N/A	\$131.00	46	21	M6702214	M6702215
			4	100	\$4,028.00	N/A	\$244.50	70	32	M6702821	M6702822
		0.125	5	125	\$5,562.00	N/A	\$540.00	108	49	M6727435	M6753212
			6	150	\$7,016.00	N/A	\$540.00	168	76	M6703552	M6753213
			8	200	\$9,677.00	N/A	\$945.00	234	106	M6704047	M6753214
			10	250	\$14,466.00	N/A	\$1,261.00	402	182	M6704497	M6753215
			12	300	\$26,960.00	N/A	\$1,790.00	692	314	M6704992	M6753216
			14 - 18	–	POA*	N/A	POA*	CF	CF	–	–

Also available as Import Specify Specify 185-N

Optional Perforated Screens:

List prices for perforated 304SS are our standard perforations - .033, .045, .062, .125, .156
For perforations larger or smaller, Prices on Application (POA*), Call Factory (CF)

Carbon Steel Body

Model 126F-CS

Class 300

Carbon Steel Basket Strainer – ASTM WCB – Flanged Ends – 300# – Knob Type Cover

MODEL	STD. BASKET		SIZE		LIST PRICE (Standard only)	ADDERS (ADD TO STANDARD LIST PRICE)		WEIGHT		ORDER CODE (Standard only)
	Material	Size	Inches	mm		ALT. SCREEN		lb.	kg	
						Mesh	Mesh Lined Perf			
126F-CS	304SS Perf	0.062	3/4	20	\$2,535.00	N/A	\$21.25	11	5	–
			1	25	\$2,731.00	N/A	\$38.75	11	5	M6709318
			1-1/4	32	\$3,762.00	N/A	\$41.25	19	9	–
			1-1/2	40	\$4,053.00	N/A	\$53.75	19	9	M6732656
			2	50	\$5,108.00	N/A	\$77.25	29	13	M6727694
			2-1/2	65	\$2,468.00	N/A	\$111.00	45	20	M6701557
			3	80	\$7,574.00	N/A	\$131.00	75	34	M6737883
			4	100	\$10,742.00	N/A	\$244.50	153	69	M6707633
		0.125	5	126	POA*	N/A	POA*	CF	CF	–
			6	150	\$19,894.00	N/A	\$540.00	310	141	M6708226
			8	200	\$24,295.00	N/A	\$945.00	555	252	M6740853
			10	250	\$41,545.00	N/A	\$1,260.00	1282	582	M6733285
			12 - 18	300	POA*	N/A	POA*	CF	CF	–

Model 186

Class 300

Carbon Steel Basket Strainer – ASTM WCB – Flanged Ends – 300# – Bolted Cover

MODEL	STD. BASKET		SIZE		LIST PRICE (Standard only)	ADDERS (ADD TO STANDARD LIST PRICE)		WEIGHT		ORDER CODE (Standard only)
	Material	Size	Inches	mm		ALT. SCREEN		lb.	kg	
						Mesh	Mesh Lined Perf			
186	304SS Perf	0.062	1-1/4	32	\$2,613.00	N/A	\$41.25	23	10.4	–
			1-1/2	40	\$3,164.00	N/A	\$53.75	23	10.4	M6700715
			2	50	\$3,164.00	N/A	\$77.25	34	15.4	M6701318
			2-1/2	65	\$3,567.00	N/A	\$111.00	40	18	M6734887
			3	80	\$4,273.00	N/A	\$131.00	54	24	M6702217
			4	100	\$5,944.00	N/A	\$244.50	86	39	M6702824
		0.125	5	126	\$8,091.00	N/A	\$540.00	121	55	–
			6	150	\$10,387.00	N/A	\$540.00	196	89	M6703554
			8	200	\$13,295.00	N/A	\$945.00	292	132	M6704049
			10	250	\$22,137.00	N/A	\$1,260.00	460	209	M6704498
			12	300	\$44,887.00	N/A	\$1,790.00	790	358	M6704993
			14 - 18	–	POA*	N/A	POA*	CF	CF	–

Optional Perforated Screens:

List prices for perforated 304SS are our standard perforations - .033, .045, .062, .125, .156
For perforations larger or smaller, Prices on Application (POA*), Call Factory (CF)

Stainless Steel Body

Model 125-SS

Class 150

Stainless Steel Basket Strainer – ASTM A351 CF8M – Screwed Ends – FNPT – Knob Type Cover

MODEL	STD. BASKET		SIZE		LIST PRICE (Standard only)	ADDERS (ADD TO STANDARD LIST PRICE)		WEIGHT		ORDER CODE (Standard only)
	Material	Size	Inches	mm		ALT. SCREEN		lb.	kg	
						Mesh	Mesh Lined Perf			
125-SS	304SS Perf	0.062	3/8	10	\$780.00	N/A	\$15.00	5	2.3	M6700119
			1/2	15	\$780.00	N/A	\$15.00	5	2.3	M6700144
			3/4	20	\$799.50	N/A	\$21.25	5	2.3	M6700195
			1	25	\$1,049.00	N/A	\$38.75	7	3.2	M6700566
			1-1/4	32	\$1,632.00	N/A	\$41.50	12	5.4	M6700655
			1-1/2	40	\$1,632.00	N/A	\$53.75	12	5.4	M6700710
			2	50	\$2,424.00	N/A	\$77.25	23	10.4	M6701307
			2-1/2	65	\$3,430.00	N/A	\$111.00	33	15	M6734457
			3	80	\$4,731.00	N/A	\$131.00	51	23	M6702204

Also available as Import Specify 125SS-N

Model 125F-SS

Class 150

Stainless Steel Basket Strainer – ASTM A351 CF8M – • Flanged Ends – 150# – Knob Type Cover

MODEL	STD. BASKET		SIZE		LIST PRICE (Standard only)	ADDERS (ADD TO STANDARD LIST PRICE)		WEIGHT		ORDER CODE (Standard only)
	Material	Size	Inches	mm		ALT. SCREEN		lb.	kg	
						Mesh	Mesh Lined Perf			
125F-SS	304SS Perf	0.062	3/4	20	\$2,233.00	N/A	\$21.25	10	4.5	M6709316
			1	25	\$2,345.00	N/A	\$38.75	16	7.3	M6700565
			1-1/4	32	\$1,632.00	N/A	\$41.50	16	7.3	M6700655
			1-1/2	40	\$3,959.00	N/A	\$53.75	25	11.3	M6700709
			2	50	\$7,698.00	N/A	\$77.25	41	19	M6701306
			2-1/2	65	\$7,517.00	N/A	\$111.00	65	29	M6701558
			3	80	\$7,698.00	N/A	\$131.00	135	61	M6701306
			4	100	\$12,087.00	N/A	\$244.50	190	86	M6702814
		0.125	5	125	\$17,004.00	N/A	POA*	270	CF	M6729938
			6	150	\$24,206.00	N/A	\$540.00	497	225	M6703545
			8	200	\$35,207.00	N/A	\$945.00	1045	474	M6704039
			10	250	\$58,072.00	N/A	\$1,260.00	1045	474	M6730694
			12 - 18	300	POA*	N/A	POA*	CF	CF	-

Also available as Import Specify 125FSS-N

Model 185-SS

Class 150

Stainless Steel Basket Strainer – ASTM A351 CF8M – • Flanged Ends – 150# – Bolted Cover

MODEL	STD. BASKET		SIZE		LIST PRICE (Standard only)	ADDERS (ADD TO STANDARD LIST PRICE)		WEIGHT		ORDER CODE (Standard only)
	Material	Size	Inches	mm		ALT. SCREEN		lb.	kg	
						Mesh	Mesh Lined Perf			
185-SS	304SS Perf	0.062	1-1/2	40	\$3,290.00	N/A	\$53.75	23	10.4	M6700714
			2	50	\$3,784.00	N/A	\$77.25	35	15.9	M6701317
			2-1/2	65	\$4,310.00	N/A	\$111.00	41	19	M6701567
			3	80	\$5,270.00	N/A	\$131.00	51	23	M6702216
			4	100	\$9,104.00	N/A	\$244.50	78	35	M6702823
		0.125	5	125	\$9,739.00	N/A	\$540.00	108	49	M6703347
			6	150	\$11,889.00	N/A	\$540.00	153	69	M6703553
			8	200	\$16,524.00	N/A	\$945.00	239	108	M6704048
			10	250	\$29,562.00	N/A	\$1,260.00	402	182	-
			12-18	-	POA*	N/A	POA*	CF	CF	-

Also available as Import Specify 185SS-N

Optional Perforated Screens:

List prices for perforated 304SS are our standard perforations - .033, .045, .062, .125, .156
For perforations larger or smaller, Prices on Application (POA*), Call Factory (CF)

Stainless Steel Body

Model 126F-SS Class 300

Stainless Steel Basket Strainer – ASTM A351 CF8M – • Flanged Ends – 300# – Bolted Cover

MODEL	STD. BASKET		SIZE		LIST PRICE (Standard only)	ADDERS (ADD TO STANDARD LIST PRICE)		WEIGHT		ORDER CODE (Standard only)
	Material	Size	Inches	mm		ALT. SCREEN		lb.	kg	
						Mesh	Mesh Lined Perf			
126F-SS	304SS Perf	0.062	3/4	20	\$2,831.00	N/A	\$21.25	11	5	–
			1	25	\$3,050.00	N/A	\$38.75	11	5	M6740971
			1-1/4	32	\$5,069.00	N/A	\$41.25	19	9	–
			1-1/2	40	\$5,069.00	N/A	\$53.75	19	9	–
			2	50	\$8,407.00	N/A	\$77.25	29	13	M6708212
			2-1/2	65	\$8,743.00	N/A	\$111.00	45	20	–
			3	80	\$10,547.00	N/A	\$131.00	75	34	M6738370
			4	100	\$15,958.00	N/A	\$244.50	153	69	–
		0.125	5	126	POA*	N/A	POA*	CF	CF	–
			6	150	\$23,471.00	N/A	\$540.00	310	141	–
			8	200	\$43,716.00	N/A	\$945.00	555	252	–
			10	250	\$65,350.00	N/A	\$1,260.00	1282	582	M6735052
			12 - 18	300	POA*	N/A	POA*	CF	CF	–

Model 186-SS Class 300

Stainless Steel Basket Strainer – ASTM A351 CF8M – • Flanged Ends – 300# – Bolted Cover

MODEL	STD. BASKET		SIZE		LIST PRICE (Standard only)	ADDERS (ADD TO STANDARD LIST PRICE)		WEIGHT		ORDER CODE (Standard only)
	Material	Size	Inches	mm		ALT. SCREEN		lb.	kg	
						Mesh	Mesh Lined Perf			
186-SS	304SS Perf	0.062	1-1/2	40	\$4,433.00	N/A	\$53.75	30	13.6	–
			2	50	\$5,254.00	N/A	\$77.25	42	19	M6701319
			2-1/2	65	\$5,525.00	N/A	\$111.00	47	21	–
			3	80	\$7,544.00	N/A	\$131.00	64	29	M6702218
			4	100	\$12,614.00	N/A	\$244.50	100	45	M6702825
		0.125	5	126	\$12,823.00	N/A	\$540.00	143	65	–
			6	150	\$21,500.00	N/A	\$540.00	197	89	M6703555
			8	200	\$21,608.00	N/A	\$945.00	289	131	–
			10	250	\$42,021.00	N/A	\$1,260.00	460	209	–
			12 - 18	300	POA*	N/A	POA*	CF	CF	–

Optional Perforated Screens:

List prices for perforated 304SS are our standard perforations - .033, .045, .062, .125, .156
For perforations larger or smaller, Prices on Application (POA*), Call Factory (CF)

Cast Iron Body

Model 791S-AH

Class 125

Cast Iron Duplex Strainer – ASTM A126 Gr. B - 316SS Balls, PTFE Seats –

Screwed Ends – FNPT - Knob Type Cover Through 2-1/2"

MODEL	STD. BASKET		SIZE		LIST PRICE (Standard only)	ADDERS (ADD TO STANDARD LIST PRICE)		WEIGHT		ORDER CODE (Standard only)
	Material	Size	Inches	mm		ALT. SCREEN		lb.	kg	
						Mesh	Mesh Lined Perf			
791S-AH	304SS Perf	0.062	3/4	20	\$3,876.00	N/A	\$42.50	27	12.2	M6700232
			1	25	\$3,876.00	N/A	\$77.25	28	12.7	M6700608
			1-1/4	32	\$4,316.00	N/A	\$82.25	70	32	M6700681
			1-1/2	40	\$4,316.00	N/A	\$107.50	72	33	M6700770
			2	50	\$7,282.00	N/A	\$154.50	94	43	M6701503
			2-1/2	65	\$8,027.00	N/A	\$221.50	136	62	M6701652
			3	80	\$8,746.00	N/A	\$261.50	140	64	M6702436

Model 791F-AH

Class 125

Cast Iron Duplex Strainer – ASTM A126 Gr. B – 316SS Balls, PTFE Seats –

Flanged Ends – 125# – Knob Type Cover Through 4"

MODEL	STD. BASKET		SIZE		LIST PRICE (Standard only)	ADDERS (ADD TO STANDARD LIST PRICE)		WEIGHT		ORDER CODE (Standard only)
	Material	Size	Inches	mm		ALT. SCREEN		lb.	kg	
						Mesh	Mesh Lined Perf			
791F-AH	304SS Perf	0.062	1	25	\$4,615.00	N/A	\$77.25	33	15	M6700607
			1-1/4	32	\$5,232.00	N/A	\$82.25	60	27	M6700680
			1-1/2	40	\$5,232.00	N/A	\$107.50	62	28	M6700769
			2	50	\$7,777.00	N/A	\$154.50	100	45	M6701502
			2-1/2	65	\$8,303.00	N/A	\$222.00	160	73	M6701651
			3	80	\$9,050.00	N/A	\$261.50	164	74	M6702435
			4	100	\$15,284.00	N/A	\$488.00	350	159	M6703040
		0.125	5	126	\$33,271.00	N/A	\$1,080.00	760	345	M6727441
		6	150	\$33,271.00	N/A	\$1,080.00	770	349	M6703761	

Model 691MF-AB

Class 125

Cast Iron Duplex Strainer – ASTM A126 GrB – Flanged Ends – 125# - Bolted Cover

MODEL	STD. BASKET		SIZE		LIST PRICE (Standard only)	ADDERS (ADD TO STANDARD LIST PRICE)		WEIGHT		ORDER CODE (Standard only)
	Material	Size	Inches	mm		ALT. SCREEN		lb.	kg	
						Mesh	Mesh Lined Perf			
691MF-AB	304SS Perf	0.125	8	200	\$66,008.00	N/A	\$1,890.00	1606	728	M6704166
			10	250	\$94,172.00	N/A	\$2,519.00	2245	1018	M6704580
			12	300	\$103,852.00	N/A	\$3,580.00	2857	1296	M6706542
			14	350	\$122,333.00	N/A	\$4,933.00	3652	1657	M6705341
			16	400	\$150,496.00	N/A	POA*	4400	1996	M6708176

Optional Perforated Screens:

List prices for perforated 304SS are our standard perforations - .033, .045, .062, .125, .156

For perforations larger or smaller, Prices on Application (POA*), Call Factory (CF)

Bronze Body

Model 792S-BH	Class 150
Bronze Body – ASTM B62 - 316SS Balls, PTFE Seats - Screwed Ends	
POA*	
Model 792F-BH	Class 150
Bronze Body – ASTM B62 - 316SS Balls, PTFE Seats - Flanged Ends – 150#	
POA*	
Model 692MF-BB	Class 150
Bronze Body - Flanged Ends – 150#	
POA*	
Model 794S-BH	Class 300
Bronze Body – ASTM B62 - 316SS Balls, PTFE Seats - Screwed Ends	
POA*	
Model 794F-BH	Class 300
Bronze Body – ASTM B62 - 316SS Balls, PTFE Seats- Flanged Ends – 300#	
POA*	
Model 690 MARINE DUPLEX	Class 300
Bronze Body – ASTM B62 - Flanged Ends – 300#	
POA*	

Optional Perforated Screens:
List prices for perforated 304SS are our standard perforations - .033, .045, .062, .125, .156
For perforations larger or smaller, Prices on Application (POA*), Call Factory (CF)

Carbon Steel Body

Model 792S-DH

Class 150

Carbon Steel Duplex Strainer – ASTM WCB - 316SS Balls, PTFE Seats - Screwed Ends - FNPT - Knob Type Cover Through 3"

MODEL	STD. BASKET		SIZE		LIST PRICE (Standard only)	ADDERS (ADD TO STANDARD LIST PRICE)		WEIGHT		ORDER CODE (Standard only)
	Material	Size	Inches	mm		Mesh	Mesh Lined Perf	lb.	kg	
792S-DH	304SS Perf	0.062	3/4	20	\$4,977.00	N/A	\$42.50	27	12.2	M6726971
			1	25	\$4,977.00	N/A	\$77.25	28	12.7	M6700612
			1-1/4	32	\$8,039.00	N/A	\$82.25	70	32	M6700682
			1-1/2	40	\$8,039.00	N/A	\$107.50	72	33	M6700775
			2	50	\$10,648.00	N/A	\$154.50	94	43	M6701507
			2-1/2	65	\$16,265.00	N/A	\$221.50	136	62	-
			3	80	\$17,729.00	N/A	\$261.50	140	64	-

Model 792F-DH (1"-1 1/2")

Class 150

Model 792MF-DH (2"-6")

Carbon Steel Duplex Strainer – ASTM WCB - 316SS Balls, PTFE Seats - Flanged Ends – 150# - Knob Type Cover Through 6"

MODEL	STD. BASKET		SIZE		LIST PRICE (Standard only)	ADDERS (ADD TO STANDARD LIST PRICE)		WEIGHT		ORDER CODE (Standard only)
	Material	Size	Inches	mm		Mesh	Mesh Lined Perf	lb.	kg	
792F-DH	304SS Perf	0.062	1	25	\$6,729.00	N/A	\$77.25	33	15	M6700609
			1-1/4	32	\$9,949.00	N/A	\$82.25	60	27	M6739792
			1-1/2	40	\$9,949.00	N/A	\$107.50	62	28	M6700772
792MF-DH		0.125	2	50	\$11,869.00	N/A	\$154.50	100	45	M6733653
			2-1/2	65	\$19,153.00	N/A	\$221.50	160	73	M6734073
			3	80	\$20,876.00	N/A	\$261.50	164	74	M6734612
			4	100	\$25,746.00	N/A	\$488.00	350	159	M6733012
			5	126	\$48,206.00	N/A	\$1,080.00	760	345	M6734827
			6	150	\$48,206.00	N/A	\$1,080.00	770	349	M6734832

Model 692MF-DB

Class 150

Carbon Steel Duplex Strainer – ASTM WCB - Bronze Seats - Flanged Ends – 150# - Bolted Cover, Gear Operator

MODEL	STD. BASKET		SIZE		LIST PRICE (Standard only)	ADDERS (ADD TO STANDARD LIST PRICE)		WEIGHT		ORDER CODE (Standard only)
	Material	Size	Inches	mm		Mesh	Mesh Lined Perf	lb.	kg	
692MF-DB	304SS Perf	0.125	8	200	POA*	N/A	POA*	1606	728	M6704168
			10	250	POA*	N/A	POA*	2245	1018	M6727558
			12	300	POA*	N/A	POA*	2845	1290	M6705041
			14	350	POA*	N/A	POA*	3652	1657	M6706681
			16	400	POA*	N/A	POA*	-	-	-

Optional Perforated Screens:

List prices for perforated 304SS are our standard perforations - .033, .045, .062, .125, .156
For perforations larger or smaller, Prices on Application (POA*), Call Factory (CF)

Duplex Basket Strainers

Carbon Steel Body

Model 794S-DH

Class 300

Carbon Steel Duplex Strainer – ASTM WCB- 316SS Balls, PTFE Seats - Screwed Ends – FNPT - Bolted Cover

MODEL	STD. BASKET		SIZE		LIST PRICE (Standard only)	ADDERS (ADD TO STANDARD LIST PRICE)		WEIGHT		ORDER CODE (Standard only)
	Material	Size	Inches	mm		Mesh	ALT. SCREEN Mesh Lined Perf	lb.	kg	
794S-DH	304SS Perf	0.062	3/4	20	\$4,805.00	N/A	\$42.50	27	12.2	–
			1	25	\$4,805.00	N/A	\$77.25	28	12.7	–
			1-1/4	32	\$7,757.00	N/A	\$82.25	70	32	–
			1-1/2	40	\$8,356.00	N/A	\$107.50	72	33	M6735887
			2	50	\$11,076.00	N/A	\$154.50	94	43	M6733666
			2-1/2	65	\$16,949.00	N/A	\$221.50	136	62	–
			3	80	\$18,474.00	N/A	\$261.50	140	64	–

Model 794F-DH (1"-1 1/2")

Class 300

Model 794MF-DH (2"-6")

Carbon Steel Duplex Strainer – ASTM WCB - 316SS Balls, PTFE Seats - Flanged Ends – 300# - Bolted Cover

MODEL	STD. BASKET		SIZE		LIST PRICE (Standard only)	ADDERS (ADD TO STANDARD LIST PRICE)		WEIGHT		ORDER CODE (Standard only)	
	Material	Size	Inches	mm		Mesh	ALT. SCREEN Mesh Lined Perf	lb.	kg		
794F-DH	304SS Perf	0.062	1	25	\$4,615.00	N/A	\$77.25	33	15	M6700607	
			1-1/4	32	\$5,232.00	N/A	\$82.25	60	27	M6700680	
			1-1/2	40	\$16,675.00	N/A	\$107.50	62	28	M6738194	
794MF-DH			2	50	\$18,309.00	N/A	\$154.50	100	45	M6733833	
			2-1/2	65	\$25,440.00	N/A	\$221.50	160	73	M6734103	
			3	80	\$26,881.00	N/A	\$261.50	164	74	M6734613	
			4	100	\$35,207.00	N/A	\$488.00	350	159	M6734338	
			0.125	5	126	\$63,369.00	N/A	\$1,080.00	760	345	M6734828
				6	150	\$63,369.00	N/A	\$1,890.00	770	349	M6734833

Model 796F-DH (1"-1 1/2")

Class 300 – Flanges drilled to 600#

Carbon Steel Duplex Strainer – ASTM WCB - 316SS Balls, PTFE Seats - Flanged Ends – 600# - Bolted Cover

MODEL	STD. BASKET		SIZE		LIST PRICE (Standard only)	ADDERS (ADD TO STANDARD LIST PRICE)		WEIGHT		ORDER CODE (Standard only)	
	Material	Size	Inches	mm		Mesh	ALT. SCREEN Mesh Lined Perf	lb.	kg		
796F-DH	304SS Perf	0.062	1	25	\$13,558.00	N/A	POA*	33	15	M6739202	
			1-1/4	32	POA*	N/A	POA*	60	27	–	
			1-1/2	40	POA*	N/A	POA*	62	28	–	
796MF-DH			2	50	POA*	N/A	POA*	100	45	–	
			2-1/2	65	POA*	N/A	POA*	160	73	–	
			3	80	POA*	N/A	POA*	164	74	–	
			4	100	POA*	N/A	POA*	350	159	–	
			0.125	5	126	POA*	N/A	POA*	760	345	–
				6	150	POA*	N/A	POA*	770	349	–

Optional Perforated Screens:

List prices for perforated 304SS are our standard perforations - .033, .045, .062, .125, .156
For perforations larger or smaller, Prices on Application (POA*), Call Factory (CF)

Stainless Steel Body

Model 792S-HH

Class 150

Stainless Steel Duplex Strainer – ASTM A351 CF8M - 316SS Balls, PTFE Seats - Screwed Ends – FNPT - Knob Type Cover

MODEL	STD. BASKET		SIZE		LIST PRICE (Standard only)	ADDERS (ADD TO STANDARD LIST PRICE)		WEIGHT		ORDER CODE (Standard only)
	Material	Size	Inches	mm		ALT. SCREEN		lb.	kg	
						Mesh	Mesh Lined Perf			
792S-HH	304SS Perf	0.062	3/4	20	\$7,045.00	N/A	\$42.50	27	12.2	M6700234
			1	25	\$7,045.00	N/A	\$77.25	28	12.7	M6700613
			1-1/4	32	\$10,565.00	N/A	\$82.25	70	32	M6700683
			1-1/2	40	\$10,565.00	N/A	\$107.50	72	33	M6700776
			2	50	\$14,926.00	N/A	\$154.50	94	43	M6701508
			2-1/2	65	\$25,001.00	N/A	\$221.50	136	62	M6738170
			3	80	\$25,251.00	N/A	\$261.50	140	64	-

Model 792F-HH (1"-11/2")

Model 792MF-HH (2"-6")

Class 150

Stainless Steel Duplex Strainer – ASTM A351 CF8M - 316SS Balls, PTFE Seats - Flanged Ends – 150# - Knob Type Cover

MODEL	STD. BASKET		SIZE		LIST PRICE (Standard only)	ADDERS (ADD TO STANDARD LIST PRICE)		WEIGHT		ORDER CODE (Standard only)
	Material	Size	Inches	mm		ALT. SCREEN		lb.	kg	
						Mesh	Mesh Lined Perf			
792F-HH	304SS Perf	0.062	1	25	\$11,270.00	N/A	\$77.25	33	15	M6700610
			1-1/4	32	\$11,607.00	N/A	\$82.25	60	27	-
			1-1/2	40	\$12,503.00	N/A	\$107.50	62	28	M6700773
792MF-HH		0.062	2	50	\$16,077.00	N/A	\$154.50	100	45	M6733655
			2-1/2	65	\$26,960.00	N/A	\$221.50	160	73	M6734076
			3	80	\$29,383.00	N/A	\$261.50	164	74	M6734739
			4	100	\$38,222.00	N/A	\$488.00	350	159	M6734346
		0.125	5	126	\$58,390.00	N/A	\$1,080.00	760	345	M6734829
			6	150	\$58,390.00	N/A	\$1,080.00	770	349	M6734834

Model 692MF-HH

Class 150

Stainless Steel Duplex Strainer – ASTM A351 CF8M - Stainless Steel Seats - Flanged Ends – 150# - Bolted Cover, Gear Operator

MODEL	STD. BASKET		SIZE		LIST PRICE (Standard only)	ADDERS (ADD TO STANDARD LIST PRICE)		WEIGHT		ORDER CODE (Standard only)
	Material	Size	Inches	mm		ALT. SCREEN		lb.	kg	
						Mesh	Mesh Lined Perf			
692MF-HH	304SS Perf	0.125	8	200	POA*	N/A	POA*	1606	728	-
			10	250	POA*	N/A	POA*	2245	1018	-
			12	300	POA*	N/A	POA*	2845	1290	-
			14	350	POA*	N/A	POA*	3652	1657	-
			16	400	POA*	N/A	POA*	-	-	-

Optional Perforated Screens:

List prices for perforated 304SS are our standard perforations - .033, .045, .062, .125, .156
For perforations larger or smaller, Prices on Application (POA*), Call Factory (CF)

Duplex Basket Strainers

Stainless Steel Body

Model 794S-HH Class 300

Stainless Steel Duplex Strainer – ASTM A351 CF8M - 316SS Balls, PTFE Seats - Screwed Ends – FNPT - Bolted Cover

MODEL	STD. BASKET		SIZE		LIST PRICE (Standard only)	ADDERS (ADD TO STANDARD LIST PRICE)		WEIGHT		ORDER CODE (Standard only)
	Material	Size	Inches	mm		ALT. SCREEN		lb.	kg	
						Mesh	Mesh Lined Perf			
794S-HH	304SS Perf	0.062	3/4	20	\$6,939.00	N/A	\$42.50	27	12.2	M6735693
			1	25	\$6,939.00	N/A	\$77.25	28	12.7	M6700616
			1-1/4	32	\$10,737.00	N/A	\$82.25	70	32	M6736472
			1-1/2	40	\$10,737.00	N/A	\$107.50	72	33	M6736470
			2	50	\$15,623.00	N/A	\$154.50	94	43	M6709324
			2-1/2	65	\$24,108.00	N/A	\$221.50	136	62	-
			3	80	\$25,416.00	N/A	\$261.50	140	64	-

Model 794F-HH (1-11/2")

Model 794MF-HH (2"-6")

Class 300

Stainless Steel Duplex Strainer – ASTM A351 CF8M - 316SS Balls, PTFE Seats - Flanged Ends – 300# - Bolted Cover

MODEL	STD. BASKET		SIZE		LIST PRICE (Standard only)	ADDERS (ADD TO STANDARD LIST PRICE)		WEIGHT		ORDER CODE (Standard only)	
	Material	Size	Inches	mm		ALT. SCREEN		lb.	kg		
						Mesh	Mesh Lined Perf				
794F-HH	304SS Perf	0.062	1	25	\$12,290.00	N/A	\$77.25	33	15	M6700615	
			1-1/4	32	\$15,692.00	N/A	\$82.25	60	27	-	
			1-1/2	40	\$16,901.00	N/A	\$107.50	62	28	M6735171	
794MF-HH			2	50	\$20,866.00	N/A	\$154.50	100	45	M6734547	
			2-1/2	65	\$30,929.00	N/A	\$221.50	160	73	M6734130	
			3	80	\$34,366.00	N/A	\$261.50	164	74	M6734781	
			4	100	\$41,948.00	N/A	\$488.00	350	159	M6734347	
			0.125	5	126	\$74,182.00	N/A	\$1,080.00	760	345	M6734830
				6	150	\$74,182.00	N/A	\$1,890.00	770	349	M6734835

Model 796F-HH (1"-11/2")

Model 796MF-HH (2"-6")

Class 300 – Flanges drilled to 600#

Stainless Steel Duplex Strainer – ASTM A351 CF8M - 316SS Balls, PTFE Seats - Flanged Ends – 600# - Bolted Cover

MODEL	STD. BASKET		SIZE		LIST PRICE (Standard only)	ADDERS (ADD TO STANDARD LIST PRICE)		WEIGHT		ORDER CODE (Standard only)	
	Material	Size	Inches	mm		ALT. SCREEN		lb.	kg		
						Mesh	Mesh Lined Perf				
796F-HH	304SS Perf	0.062	1	25	POA*	N/A	POA*	33	15	-	
			1-1/4	32	POA*	N/A	POA*	60	27	-	
			1-1/2	40	POA*	N/A	POA*	62	28	-	
796MF-HH			2	50	POA*	N/A	POA*	100	45	-	
			2-1/2	65	POA*	N/A	POA*	160	73	-	
			3	80	POA*	N/A	POA*	164	74	-	
			4	100	POA*	N/A	POA*	350	159	-	
			0.125	5	126	POA*	N/A	POA*	760	345	-
				6	150	POA*	N/A	POA*	770	349	-

Optional Perforated Screens:

List prices for perforated 304SS are our standard perforations - .033, .045, .062, .125, .156
For perforations larger or smaller, Prices on Application (POA*), Call Factory (CF)

Ball-Plex Spare Parts

Replacement Knobs Set of Four (4)

PART	SIZE		LIST PRICE
	in.	mm	
Ductile Iron (DI)	¾ - 1½	20 - 40	\$63.25
	2 - 4	50 - 100	\$75.50
	5	125	\$75.50
	6	150	\$130.50

Replacement Handles/ Gear Operator

PART	SIZE		LIST PRICE
	in.	mm	
Handle	¾ - 1½	20 - 40	\$77.00
	2 - 3	50 - 80	\$129.50
Gear Operator	4	100	\$711.50
	5	125	\$711.50
	6	150	\$823.50

Ball-Plex Duplex strainer Spare Parts & Repair Kits

PART	SIZE		LIST PRICE	ORDER CODE
	in.	mm		
SS Ball (2 required)	1	25	\$327.50	-
	1-1/2	40	\$395.50	-
	2	50	\$774.50	-
	2-1/2	65	\$1,103.00	-
	3	80	\$919.50	-
	4	100	\$2,716.00	-
	5	125	\$3,786.00	-
Upper Shaft	1	25	\$82.50	-
	1-1/2	40	\$82.50	-
	2	50	\$190.00	-
	2-1/2	65	\$190.00	-
	3	80	\$239.00	-
	4	100	\$329.50	-
	5	125	\$329.50	-
Lower Shaft	1	25	\$82.50	-
	1-1/2	40	\$82.50	-
	2	50	\$132.50	-
	2-1/2	65	\$132.50	-
	3	80	\$182.00	-
	4	100	\$223.00	-
	5	125	\$223.00	-
Seat Repair kit w/ Buna O-ring kit	3/4 and 1	25	\$141.50	M6758654
	1-1/4 and 1-1/2	40	\$234.00	M6758655
	2	50	\$441.50	M6758656
	2-1/2 and 3	65	\$520.50	M6758657
	4	100	\$856.50	M6758658
	5 and 6	125	\$1,058.00	M6758659
Seat Repair kit w/ EPDM O-ring kit	3/4 and 1	25	\$149.00	M6758660
	1-1/4 and 1-1/2	40	\$234.00	M6758661
	2	50	\$60.00	M6758662
	2-1/2 and 3	65	\$78.00	M6758663
	4	100	\$83.50	M6758664
	5 and 6	125	\$1,058.00	M6758665
Seat Repair kit w/ Viton O-ring kit	3/4 and 1	25	\$157.50	M6758666
	1-1/4 and 1-1/2	40	\$268.00	M6758667
	2	50	\$366.00	M6758668
	2-1/2 and 3	65	\$568.00	M6758669
	4	100	\$855.50	M6758670
	5 and 6	125	\$1,188.00	M6758673

O-Ring kits include Replacements for:

Basket Cover	(2 each)	Shaft, lower	(1 each)
Basket	(2 each)	Basket Housing	(2 each)
Shaft, upper	(2 each)		

**List price for replacement
304SS Screens and Baskets**

SIZE		20 OR 30 MESH SS #11M, #351M, #352M	PERFORATED SS Y STRAINERS	20-30-40-60-80-100 MESH LINED SS Y STRAINERS	PERFORATED SS #155, #165, #166, #185, #186	20-30-40-60-80-100 MESH LINED SS #155, #165 #166, #185, #186	PERFORATED SS #125 BALL-PLEX & DUPLEX	20-30-40-60-80-100 MESH LINED SS #125, BALL-PLEX & DUPLEX STRAINERS
in.	mm							
14,38,1/2	8 - 15	\$17.75	\$24.75	\$37.25	\$117.00	N/A	\$217.50	\$293.50
34	20	\$17.75	\$33.75	\$52.25	\$117.00	N/A	\$217.50	\$293.50
1	25	\$24.75	\$42.00	\$63.25	\$133.00	N/A	\$217.50	\$293.50
1-1/4	32	\$30.25	\$51.00	\$89.25	\$154.00	N/A	\$293.50	\$444.50
1-1/2	40	\$37.25	\$64.75	\$117.00	\$173.00	N/A	\$293.50	\$444.50
2	50	\$52.25	\$99.50	\$171.50	\$203.00	\$418.50	\$293.50	\$444.50
2-1/2	65	N/A	\$171.50	\$337.00	\$299.00	\$584.00	\$427.50	\$675.50
3	80	N/A	\$217.50	\$397.50	\$392.50	\$763.00	\$436.50	\$675.50
3-1/2	90	N/A	\$318.50	\$618.50	\$418.50	\$826.00	\$POA*	\$POA*
4	100	N/A	\$431.00	\$812.00	\$507.00	\$1,013.00	\$890.00	\$1,218.00
5	125	N/A	\$502.00	\$992.00	\$654.00	\$1,294.00	\$1,107.00	\$1,476.00
6	150	N/A	\$678.50	\$1,302.00	\$812.00	\$1,564.00	\$1,476.00	\$1,933.00
8	200	N/A	\$1,029.00	\$1,984.00	\$1,342.00	\$2,630.00	\$2,222.00	\$2,517.00
10	250	N/A	\$1,712.00	\$2,967.00	\$1,871.00	\$3,691.00	\$2,943.00	\$4,071.00
12	300	N/A	\$2,270.00	\$3,613.00	\$2,743.00	\$5,477.00	\$3,691.00	\$5,077.00
14	350	N/A	\$4,096.00	\$7,050.00	\$3,851.00	\$7,606.00	\$POA*	\$POA*
16	400	N/A	\$5,389.00	\$8,651.00	\$POA*	\$POA*	\$POA*	\$POA*
18	450	N/A	\$POA*	\$POA*	\$POA*	\$POA*	\$POA*	\$POA*
20 -24	500 - 600	N/A	\$POA*	\$POA*	\$POA*	\$POA*	\$POA*	\$POA*

*Prices on application for Simplex Strainers 14 and up, and Duplex Strainers 8 - 16

** 6 Ball-Plex (2) Basket

125,125F Knobs (Spare Parts)

SIZE		LIST PRICE (PER KNOB)
in.	mm	
3/8 - 3	10 - 80	\$42.00
4 - 10	100 - 250	\$51.00

**Price Adders for 316SS Screens and Baskets -
Refer page 69 for adders**

**Price Adders for Monel® Screens and Baskets -
Refer page 71 for adders**

Optional Perforated Screens:

List prices for perforated 304SS are our standard perforations - .033, .045, .062, .125, .156
For perforations larger or smaller, Prices on Application (POA*), Call Factory (CF)

MODEL	GASKET TYPE	SIZE															
		in.	¼ – ½	¾	1	1¼	1½	2	2½	3	3½	4	5	6	8	10	12
		mm	8 – 15	20	25	32	40	50	65	80	90	100	125	150	200	250	300
11M	Carbon Steel Tanged Gpht	\$9.00	\$9.00	\$12.50	\$12.50	\$12.50	\$12.50	\$12.50	\$12.50	-	\$17.75	-	-	-	-	-	
155M* 165, 166, 185	BUNA Non-Asbestos	-	-	-	-	-	\$12.50	\$12.50	\$12.50	\$15.00	\$17.75	\$19.75	\$21.25	\$32.25	\$52.25	\$63.25	
185SS	SS Tanged Gpht	-	-	-	\$33.75	\$35.00	\$38.50	\$38.50	\$43.75	\$63.25	\$77.00	\$77.00	\$80.50	\$148.50	\$192.00	-	
125SS, 125FSS	Viton o-ring	\$28.75	\$28.75	\$28.75	-	\$35.00	\$41.00	\$47.50	\$55.75	\$68.25	\$68.25	\$71.75	\$75.50	\$96.00	\$115.50	-	
125, 125F	O-ring BUNA	\$12.50	\$12.50	\$12.50	\$17.75	\$17.75	\$21.25	\$24.75	\$30.25	-	\$30.25	\$32.25	\$33.75	\$42.00	\$51.00	-	
352 1/2	Copper	-	-	-	-	-	-	-	-	-	-	-	-	-	-	-	
581, 582, 581SS, 582SS	SS Spiral Wound Gpht filled	\$21.25	\$21.25	\$23.50	\$24.75	\$28.75	\$26.25	-	-	-	-	-	-	-	-	-	
595	Non-Asbestos	-	-	-	-	-	-	-	-	-	\$23.50	-	\$51.00	\$59.50	\$84.00	-	
625, 625B	Non-Asbestos	\$12.50	\$12.50	\$12.50	\$19.75	\$19.75	-	\$23.50	\$32.25	-	\$35.00	-	\$45.75	-	-	-	
751, 752, 758	Non-Asbestos	\$9.00	\$9.00	\$12.50	\$12.50	\$12.50	-	\$15.00	\$17.75	\$17.75	\$19.75	\$21.25	\$23.50	\$30.25	\$43.75	\$59.50	
764, 765M, 766M, 767	304 SS Spiral Wound	\$42.00	\$43.75	\$49.25	\$71.75	\$78.25	\$82.00	\$82.00	\$90.50	\$90.50	\$126.00	\$134.50	\$152.00	\$165.50	\$264.50	\$328.50	
781, 782	Non-Asbestos	\$12.50	\$12.50	\$12.50	\$17.75	\$17.75	-	\$17.75	\$17.75	\$19.75	\$19.75	\$21.25	\$23.50	\$30.25	\$43.75	\$59.50	
861, 862, 861BC, 862BC	Spiral Wound Non-Asbestos	\$43.75	\$45.75	\$49.25	\$58.25	\$71.75	\$77.00	\$101.50	\$101.50	-	-	-	-	-	-	-	
767, 863M, 864M, 865, 866	316 SS Spiral Wound	\$49.25	\$52.25	\$61.00	\$84.00	\$89.25	\$96.00	\$108.00	\$113.50	\$159.00	\$160.50	\$182.50	\$186.50	\$192.00	\$330.00	\$384.00	
764SS, 765M-SS, 766M-SS, 767SS	304 SS Spiral Wound Non-Asbestos	\$42.00	\$43.75	\$49.25	\$71.75	\$78.25	\$82.00	\$82.00	\$90.50	-	\$126.00	\$150.00	\$160.50	\$192.00	-	-	
781SS, 782SS	316 SS Spiral Wound Tanged Gpht	-	-	-	-	-	\$21.25	\$35.00	\$38.50	\$43.75	\$64.75	\$64.75	\$69.75	\$139.50	\$192.00	\$217.50	
861SS, 861SSBC 862SS-BC 862SS 862SS-BC	316 SS Spiral Wound	\$42.00	\$45.75	\$49.25	\$58.25	\$71.75	\$80.50	\$101.50	\$101.50	-	-	-	-	-	-	-	
863M-SS, 864M-SS, 865SS, 866SS	316 SS Spiral Wound	\$59.50	\$59.50	\$59.50	\$64.75	\$89.25	\$80.50	-	-	-	-	-	-	-	-	-	
911U	Non-Asbestos	-	-	-	-	-	-	\$35.00	\$35.00	\$42.00	\$51.00	\$52.25	\$58.25	\$61.00	\$96.00	\$96.00	

Prices on application for Simplex Strainers 14" and up, and Duplex Strainers 8" – 16"

Optional Perforated Screens:

List prices for perforated 304SS are our standard perforations - .033, .045, .062, .125, .156
For perforations larger or smaller, Prices on Application (POA*), Call Factory (CF)

Cast Iron Body

Model 625 **Class 125**
Cast Iron Body – ASTM A126 Gr. B - Flanged Ends – 125#

POA*



Bronze Body

Model 625-B **Class 150**
Bronze Body – ASTM B62 - Flanged Ends – 150#

POA*



UL Fireline Strainers

Cast Iron Body

Model 911U **Class 125**
Cast Iron Y Strainer – ASTM A126 Gr. B - Flanged Ends – 125# -
UL approved for Fireline Service



MODEL	STD. SCREEN	SIZE		LIST PRICE	WEIGHT		ORDER CODE
	Material	Inches	mm		lb.	kg	
911U	1/4" Perforations	2-1/2	65	\$2,042.00	60	27	M6701667
		3	80	\$2,178.00	65	29	M6702454
		4	100	\$3,628.00	125	57	M6703053
		5	125	\$4,574.00	172	78	M6703410
		6	150	\$5,716.00	210	95	M6703772
		8	200	\$11,093.00	360	163	M6704232
		10	250	\$16,693.00	610	277	M6704626
		12	300	\$33,150.00	1045	474	M6705083

Model 595 **Class 125**
Cast Iron Basket Strainer – ASTM A126 Gr. B - Flanged Ends – 125# -
UL approved for Fireline Service



MODEL	STD. STD. SCREEN	SIZE		LIST PRICE	WEIGHT		ORDER CODE
	Material	Inches	mm		lb.	kg	
595	1/4" Perforations	4	100	\$9,686.00	237	108	M6702940
		6	150	\$10,655.00	382	173	M6703665
		8	200	\$14,173.00	654	297	M6704138
		10	250	\$20,774.00	963	437	M6704560
		12	300	\$42,424.00	1535	696	M6705030

Optional Perforated Screens:
List prices for perforated 304SS are our standard perforations - .033, .045, .062, .125, .156
For perforations larger or smaller, Prices on Application (POA*), Call Factory (CF)

#22 Truncated

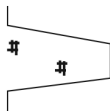

#23 Conicals

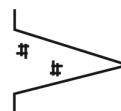

SIZE		CARBON STEEL ½ PERFORATED	20-30-40-60-80-100 MESH LINED CARBON STEEL	TYPE 304 STAINLESS STEEL ½ PERFORATED	20-30-40-80-100 MESH LINED STAINLESS STEEL
in.	mm				
3/4	20	POA*	POA*	POA*	POA*
1	25	POA*	POA*	POA*	POA*
1-3/4	32	POA*	POA*	POA*	POA*
1-1/2	40	\$229.50	\$282.00	\$242.50	\$289.00
2	50	\$229.50	\$282.00	\$242.50	\$289.00
2-1/2	65	\$263.50	\$306.50	\$282.00	\$346.00
3	80	\$263.50	\$368.50	\$325.00	\$368.50
4	100	\$332.00	\$436.50	\$403.50	\$462.00
5	125	\$418.50	\$512.00	\$490.00	\$548.50
6	150	\$476.00	\$555.50	\$512.00	\$634.00
8	200	\$548.50	\$677.00	\$627.50	\$850.00
10	250	\$749.50	\$836.00	\$950.50	\$1,326.00
12	300	\$850.00	\$1,037.00	\$1,240.00	\$1,728.00
14 - 30	350 - 750	\$POA*	\$POA*	\$POA*	\$POA*

*Prices on application
Above prices for 100% and 150% open areas. Price on application for special open areas, other types of materials, perforations and mesh size.

Temporary Plate Strainers

FIGURE #24

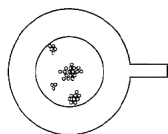

SIZE		CARBON STEEL ½ PERFORATED	20-30-40-60-80-100 MESH LINED CARBON STEEL	TYPE 304 STAINLESS STEEL ½ PERFORATED	20-30-40-80-100 MESH LINED STAINLESS STEEL
in.	mm				
3/4	20	POA*	POA*	POA*	POA*
1	25	POA*	POA*	POA*	POA*
1-1/4	32	POA*	POA*	POA*	POA*
1-1/2	40	\$126.00	\$132.50	\$146.50	\$166.50
2	50	\$126.00	\$132.50	\$146.50	\$166.50
2-1/2	65	\$143.00	\$166.50	\$179.50	\$205.50
3	80	\$177.00	\$181.50	\$205.50	\$224.00
4	100	\$205.50	\$224.00	\$241.50	\$259.50
5	15	\$238.50	\$275.00	\$289.00	\$306.50
6	150	\$259.50	\$317.00	\$310.50	\$354.00
8	200	\$325.00	\$393.00	\$403.50	\$502.00
10	50	\$390.00	\$472.00	\$484.50	\$602.50
12	300	\$476.00	\$584.00	\$792.50	\$965.50
14 - 30	350-750	\$POA*	\$POA*	\$POA*	\$POA*

Optional Perforated Screens:

List prices for perforated 304SS are our standard perforations - .033, .045, .062, .125, .156
For perforations larger or smaller, Prices on Application (POA*), Call Factory (CF)

Y Type

4 - 48
FLANGED

- Model 781 FAB
Class 150
- Model 782 FAB
CLASS 300
- Model 784 FAB
CLASS 600

Class 900 and higher available
Prices on application

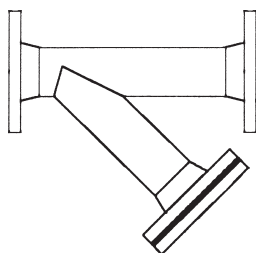

4 - 48
WELD-END

- Model 781 WE FAB
CLASS 150
- Model 782 WE FAB
CLASS 300
- Model 784 WE FAB
CLASS 600

Class 900 and higher available
Prices on application

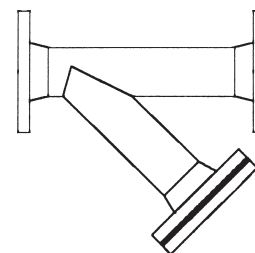

TEE Type

- 2 - 30
- Model 41T-B
CLASS 150
- Model 42T-B
CLASS 300
- Model 44T-B
CLASS 600
- Model 46T-B
CLASS 900
- Model 48T-B
CLASS 1500
- Model 50T-B
CLASS 2500

Prices on application

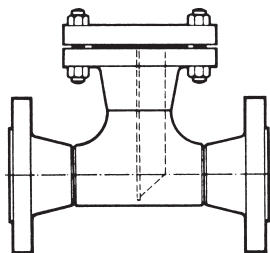

- 2 - 30
- Model 41T-Q
CLASS 150
- Model 42T-Q
CLASS 300

Prices on application

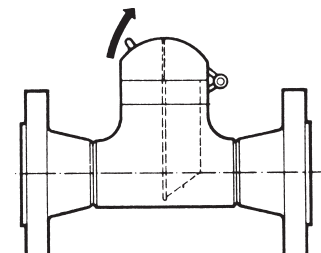

Basket Type

- 4 - 60
- Model 185 FAB-B
CLASS 150
- Model 186 FAB-B
CLASS 300
- Model 188 FAB-B
CLASS 600
- Model 189 FAB-B
CLASS 900

Prices on application

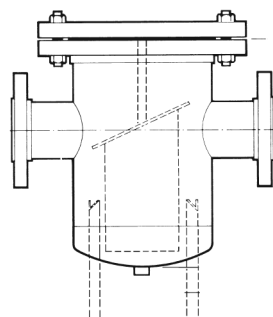

- 4 - 60
- Model 185 FAB-Q
CLASS 150
- Model 186 FAB-Q
CLASS 300

Prices on application

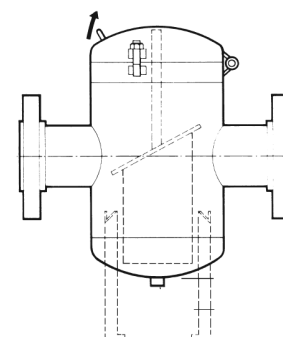

Our manufacturing capacity for special fabricated products is ½ through 72 nominal pipe size. Standard fabricated strainers are available as well as custom designed units. The products on this page and special products are available in various materials and pressure class.

Optional Perforated Screens:

List prices for perforated 304SS are our standard perforations - .033, .045, .062, .125, .156 For perforations larger or smaller, Prices on Application (POA*), Call Factory (CF)

Application and Selection Guide for Pricing

Mueller Steam Specialty fabricated strainers are based upon application and piping/process design parameters to provide the most economical price. Cost saving options include strainer vessel construction for code safe working pressure where it is less than the piping class. The following guide will help summarize the data needed for specification and quotation.

Basic Application Summary:

Type of fluid _____ pH _____ Viscosity _____
 Temperature _____ °F or °C. Pressure _____
 Fluid _____ gpm. Steam _____ lbs./h. Gas _____ cu.ft./min
 Allowable pressure drop _____ psi. Piping design pressure _____ psi.
 Percentage of suspended solids _____%. Specific gravity _____.
 Particle size for removal _____ (in., mm, micron, etc.)
 Type of pipe end connection _____ (flanged, threaded, butt weld, socket weld, sil-braze).
 Strainer mounting position: Vertical _____ or horizontal _____
 National codes and standards which apply (ANSI, BS, DIN, API, etc.): _____

Guide For Specifications And Quotations

Typical Options:

Offsets or special nozzles • Sight flow indicators/inspection ports • Special blow-off down and/or back flushing •
 Sampling or blow-down valves • Sintered metal micron filter elements • Special basket configurations • Reduced inlets or
 outlets • Infinite variety of closures • Conical bottoms • Special drains and bypasses • Jacketing Duplex or manifold units
 • Floorstands • Mounting hardware • Multibasket strainers

Type of strainer _____ Size _____ Working pressure _____
 Piping design pressure _____ psi, Pipe class _____, Size _____
 Design Flow rate _____
 Temperature _____ (F or C). End connections _____
 Options: _____
 Body material _____ Screen or basket material _____
 Lining or coating: external _____ internal _____
 Special basket configuration _____
 Screen or basket perforation size _____ mesh lining in. _____ mesh _____
 Blow-off connection _____ Type of cover _____ Gauge taps _____
 Jacketing: temperature _____ pressure _____ connections _____
 Tagging _____

Optional Perforated Screens:

List prices for perforated 304SS are our standard perforations - .033, .045, .062, .125, .156
 For perforations larger or smaller, Prices on Application (POA*), Call Factory (CF)

Cast Iron Body

Model 1011

Class 125

Cast Iron Suction Diffuser – ASTM A126 Gr. B - Flanged Ends – 125# -
Knob Cover through 8x8" - Bolted Cover above 8x8"



MODEL	STD. SCREEN Material	SIZE		LIST PRICE	WEIGHT		ORDER CODE
		Inches	mm	(Standard only)	lb.	kg	(Standard only)
1011	304SS Perf/Mesh Start up screen included	2x1-1/4	50x32	\$778.50	19	8.6	M6701532
		2x1-1/2	50x40	\$778.50	21	9.5	M6701533
		2x2	50x50	\$811.50	23	10.4	M6701534
		2x2-1/2	50x65	\$811.50	32	14.5	M6701668
		2-1/2x2-1/2	65x65	\$1,067.00	34	15.4	M6701670
		3x2	80x50	\$1,125.00	45	20	M6702455
		3x2-1/2	80x65	\$1,167.00	46	21	M6702458
		3x3	80x80	\$1,262.00	47	21	M6702459
		4x3	100x80	\$1,587.00	61	28	M6703055
		4x4	100x100	\$1,942.00	73	33	M6703057
		5x4	125x100	\$2,010.00	96	44	M6703411
		5x5	125x125	\$2,010.00	101	46	M6703413
		6x4	150x100	\$2,293.00	132	60	M6703773
		6x5	150x125	\$2,468.00	136	62	M6703776
		6x6	150x150	\$2,748.00	139	63	M6703779
		8x6	200x150	\$3,402.00	166	75	M6704240
		8x8	200x200	\$5,461.00	249	113	M6704243
		10x8	250x200	\$6,517.00	276	125	M6704631
		10x10	250x250	\$7,678.00	422	191	M6704628
		12x8	300x200	\$9,035.00	412	187	M6705088
		12x10	300x250	\$9,332.00	491	223	M6705085
12x12	300x300	\$9,332.00	601	273	M6705087		
14x8	350x200	\$10,462.00	CF	CF	-		
14x10	350x250	\$12,678.00	507	230	M6705365		
14x12	350x300	\$15,495.00	601	273	M6705366		
14x14	350x350	\$16,199.00	706	320	M6705367		
16x10	400x250	\$15,200.00	550	249	-		
16x12	400x300	\$16,373.00	660	299	M6705584		
16x14	400x350	\$16,901.00	750	340	M6705585		
16x16	400x400	\$24,646.00	820	372	M6705586		

Larger sizes on request

Optional Perforated Screens:

List prices for perforated 304SS are our standard perforations - .033, .045, .062, .125, .156
For perforations larger or smaller, Prices on Application (POA*), Call Factory (CF)

Spare Parts for 1011, 1011G and 1012 Suction Diffusers

SIZE (INLET X OUTLET)	LIST PRICE		
	ORINGS	KNOBS (EACH)	SCREENS
2 x 1-1/4", 2-1/2" X 2-1/2"	\$18.75	\$43.25	\$68.25
3 X 2, 3 X 3	\$28.75	\$43.25	\$82.50
4 X 3, 4 X 4	\$30.75	\$43.25	\$101.50
5 X 4, 5 X 5	\$33.25	\$51.75	\$159.00
6 X 4, 6 X 6, 8 X 6	\$35.50	\$51.75	\$208.50
8 X 8, 10 X 8, 12 X 8	\$43.25	\$51.75	\$371.00
10 X 10, 12 X 10	\$53.00	\$51.75	\$568.50
12 X 12	\$74.50	\$51.75	\$1,285.00

Spare Parts for 1011, 1011G and 1012 Suction Diffusers

SIZE	ORING	KNOBS	STUDS	NUTS	SCREENS
2x1-1/4"	M6723293	M6723097	-	-	M6716196
2x1-1/2	M6723293	M6723097	-	-	M6716196
2x2	M6723293	M6723097	-	-	M6716196
02.5X2	M6723427	M6723097	-	-	M6716199
2.5X2.5	M6723427	M6723097	-	-	M6701589
3X2	M6723844	M6702455	-	-	M6711689
3X3	M6723844	M6723294	-	-	M6711689
4X2-1/2	M6724183	M6723097	-	-	M6711723
4X3	M6724183	M6723097	-	-	M6711723
4X4	M6724183	M6723097	-	-	M6711723
5X4	M6724401	M6723097	-	-	M6713412
5X5	M6724401	M6723097	-	-	M6713412
6X4	M6724587	M6723294	-	-	M6712919
6X5	M6724587	M6723294	-	-	M6712919
6X6	M6724587	M6723294	-	-	M6712919
8X6	M6724587	M6723294	-	-	M6712919
8X8	M6724901	M6723294	-	-	M6712306
10X8	M6724901	M6723294	-	-	M6712306
10X10	M675146	-	M6724778	M6722434	M6711042
12X8	M6724901	M6723294	M6724778	-	M6712306
12X10	M6725146	-	M6724778	M6722434	M6711042
12X12	M6725146	-	M6724778	M6722434	M6712139
14X10	M6725146	-	M6724778	M6722434	M6711042
14X12	M6725146	-	M6724778	M6722434	M6712139
14X14	M6725297	-	M6724778	M6722434	M6711453
16X10	M6725146	-	M6724778	M6722434	M6711042
16X12	M6725146	-	M6724778	M6722434	M6712139
16X14	M6725297	-	M6724778	M6722434	M6711453
16X16	M6725297	-	M6724778	M6722434	M6711453

Optional Perforated Screens:

List prices for perforated 304SS are our standard perforations - .033, .045, .062, .125, .156
For perforations larger or smaller, Prices on Application (POA*), Call Factory (CF)

Ductile Iron Body

Model 1012

Class 300

Ductile Iron Suction Diffuser – ASTM A395 - Flanged Ends – 300# - Knob Cover through 8x8" - Bolted Cover above 8x8"



MODEL	STD. SCREEN	SIZE		LIST PRICE	WEIGHT		ORDER CODE
	Material	Inches	mm	(Standard only)	lb.	kg	(Standard only)
1012	304SS Perf/Mesh Start up screen included	2x1-1/4	50x32	\$1,156.00	25	11.3	–
		2x1-1/2	50x40	\$1,194.00	25	11.3	–
		2x2	50x50	\$1,358.00	30	13.6	M6701535
		2-1/2x2	65x50	\$1,412.00	35	15.9	–
		2-1/2x2-1/2	65x65	\$1,510.00	39	17.7	–
		3x2	80x50	\$1,980.00	57	26	M6702457
		3x2-1/2	80x65	\$2,089.00	57	26	M6726029
		3x3	80x80	\$2,171.00	63	29	M6727342
		4x3	100x80	\$2,720.00	69	31	M6732662
		4x4	100x100	\$2,876.00	86	39	M6703059
		5x4	125x100	\$3,589.00	125	57	M6703412
		5x5	125x125	\$3,514.00	130	59	–
		6x4	150x100	\$4,662.00	161	73	M6703775
		6x5	150x125	\$5,022.00	155	70	M6703778
		6x6	150x150	\$5,072.00	168	76	M6703781
		8x6	200x150	\$6,548.00	216	98	M6704242
8x8	200x200	\$6,669.00	317	144	M6704244		
10x8	250x200	\$9,072.00	358	162	M6704632		
10x10	250x250	\$12,559.00	473	215	M6704629		

Larger sizes available on request

Optional Perforated Screens:

List prices for perforated 304SS are our standard perforations - .033, .045, .062, .125, .156
For perforations larger or smaller, Prices on Application (POA), Call Factory (CF)

Cast Iron Body

Model 721

Class 125

Cast Iron Triple Duty Valve – ASTM A126 Gr. B - Flanged Ends –
125# - Bolted Yoke/Cover - Position Indicator



MODEL	SIZE		LIST PRICE (Standard only)	WEIGHT		ORDER CODE (Standard only)	ORDER CODE Import
	Inches	mm		lb.	kg		
721	2	50	\$1,294.00	23	10.4	M6701456	M6741733
	2-1/2	65	\$1,473.00	40	18	M6701632	M6741734
	3	80	\$1,576.00	50	23	M6702388	M6741735
	4	100	\$3,193.00	100	45	M6703000	M6741736
	5	125	\$3,746.00	155	70	M6703394	M6741737
	6	150	\$5,139.00	200	91	M6703729	M6741738
	8	200	\$6,970.00	350	159	M6704204	M6741739
	10	250	\$11,490.00	480	218	M6704612	M6741740
	12	300	\$17,719.00	660	299	M6705068	M6741741
	14	350	\$20,903.00	790	358	M6705359	M6741742
	16	400	POA*	1580	717	–	
	18	450	POA*	1860	844	–	
	20	500	POA*	CF	CF	–	
24	600	POA*	CF	CF	–		

Also available as import - Specify 721-N

Model 722

Class 300

Ductile Iron Triple Duty Valve – ASTM A395 - Flanged Ends – 300# - Bolted Yoke/Cover
- Position Indicator



MODEL	SIZE		LIST PRICE (Standard only)	WEIGHT		ORDER CODE
	Inches	mm		lb.	kg	
722	2	50	\$2,208.00	23	10.4	M6701457
	2-1/2	65	\$2,682.00	24	11	M6729937
	3	80	\$2,962.00	33	15	M6702389
	4	100	\$5,538.00	84	38	M6703001
	5	125	\$6,402.00	124	56	M6703395
	6	150	\$8,303.00	156	71	M6703730
	8	200	\$10,897.00	300	136	M6704205
	10	250	\$17,900.00	392	178	M6704613
	12	300	\$27,667.00	496	225	M6705069
	14	350	POA*	917	416	–
	16	400	POA*	1864	846	–

Butt Weld

Model 15A

Class 150



Pressure-Temperature Rating

300psi WOG
21 bar @ 38°C

Flanged

Model 15AF

CLASS 150

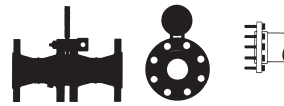

Pressure-Temperature Rating

300psi WOG
21 bar @ 38°C

PART	SIZE		WEIGHT (APPROX.)		PRICE
	in.	mm	lbs.	kgs.	
Forged Steel Flange and Spectacle, Buna-N O-rings	1	25	11	5	POA*
	1-1/2	40	17	7.7	POA*
	2	50	22	10	POA*
	2-1/2	65	29	13	POA*
	3	80	35	16	POA*
	4	100	62	28	POA*
	5	125	77	35	POA*
	6	150	101	46	POA*
	8	200	159	72	POA*
	10	250	220	100	POA*
	12	300	339	154	POA*
	14	350	-	-	POA*
	16	400	-	-	POA*
	18	450	-	-	POA*
	20	500	-	-	POA*
24	600	-	-	POA*	
316 SS Flanges Spectacle Teflon O-rings			-	-	POA*

*Prices on application

MODEL 15AF	SIZE		WEIGHT (APPROX.)		PRICE
	in.	mm	lbs.	kgs.	
Forged Steel Flange and Spectacle, Buna-N O-rings	1	25	17	7.7	POA*
	1-1/2	40	25	11	POA*
	2	50	34	15	POA*
	2-1/2	65	45	20	POA*
	3	80	55	25	POA*
	4	100	92	42	POA*
	5	125	115	52	POA*
	6	150	159	72	POA*
	8	200	237	108	POA*
	10	250	324	147	POA*
	12	300	559	254	POA*
	14	350	-	-	POA*
	16	400	-	-	POA*
	18	450	-	-	POA*
	20	500	-	-	POA*
	24	600	-	-	POA*
	316 SS Flanges Spectacle Teflon O-rings			-	-

*Prices on application

Ductile Iron Body Strainers

Model 758G

Ductile Iron Y Strainer – ASTM A395 - Grooved Ends



MODEL	STD. SCREEN		SIZE		LIST PRICE (Standard only)	ADDERS (ADD TO STANDARD LIST PRICE)				WEIGHT		ORDER CODE (Standard only)
	Material	Size	Inches	mm		ALT. SCREEN		PLUGGED BLOWOFF		lb.	kg	
						Mesh	Mesh Lined Perf	IRON	BRASS			
758G	304SS Perf	0.062	2	50	\$730.50	N/A	\$82.00	\$6.75	\$17.50	12	5.4	M6701472
			2-1/2	65	\$797.00	N/A	\$118.00	\$6.75	\$17.50	18	8.2	M6701638
			3	80	\$856.50	N/A	\$139.00	\$6.75	\$17.50	23	10.4	M6702407
			4	100	\$1,038.00	N/A	\$259.50	\$6.75	\$17.50	42	19	M6703017
		0.125	5	125	\$1,755.00	N/A	\$573.50	\$11.50	\$33.25	80	36	M6703402
			6	150	\$2,385.00	N/A	\$573.50	\$11.50	\$33.25	112	51	M6703746
			8	200	\$3,640.00	N/A	\$1,004.00	\$11.50	\$33.25	205	93	M6704219
			10	250	\$8,372.00	N/A	\$1,339.00	\$11.50	\$33.25	277	126	M6704620
			12	300	\$13,203.00	N/A	\$1,901.00	\$11.50	\$33.25	470	213	M6705078

Model 42T-G-Q

Ductile Iron Body – ASTM A395 - Tee Strainer – Grooved End – Clamped Cover



MODEL	STD. SCREEN		SIZE		LIST PRICE (Standard only)	ADDERS (ADD TO STANDARD LIST PRICE)				WEIGHT		ORDER CODE (Standard only)
	Material	Size	Inches	mm		ALT. SCREEN		PLUGGED BLOWOFF		lb.	kg	
						Mesh	Mesh Lined Perf	IRON	BRASS			
42T-G-Q	304SS Perf	0.062	2	50	POA*	N/A	N/A	N/A	N/A	6.3	2.8	–
			2-1/2	65	POA*	N/A	N/A	N/A	N/A	11.5	5.2	M6701574
			3	80	POA*	N/A	N/A	N/A	N/A	12.5	5.7	M6727327
		0.125	4	100	POA*	N/A	N/A	N/A	N/A	19.8	9.0	–
			5	125	POA*	N/A	N/A	N/A	N/A	30.0	13.6	–
			6	150	POA*	N/A	N/A	N/A	N/A	40.0	18	M6727327
			8	200	POA*	N/A	N/A	N/A	N/A	81.0	37	M6704072
			10	250	POA*	N/A	N/A	N/A	N/A	126.0	57	–
			12	300	POA*	N/A	N/A	N/A	N/A	174.0	79	–

Ductile Iron Body Sure Check™ Valve

Model 74G-IHH

Ductile Iron Body – ASTM A395 - Sure Check™ Valve - Grooved End - SS Discs - Buna N Vulcanized Seats

MODEL	SIZE		LIST PRICE (Standard only)	WEIGHT		ORDER CODE
	Inches	mm		lb.	kg	
74G-IHH	3	80	\$956.50	8	80	M6702398
	4	100	\$1,262.00	13	100	
	5	125	\$1,565.00	20	125	
	6	150	\$1,827.00	29	150	M6747544
	8	200	POA*	46	200	M6749691
	10	250	POA*	66	250	
	12	300	POA*	163	300	

Iron Body Pump Protection Products

Model 1011G

Class 150

Cast Iron Suction Diffuser – ASTM A126 Gr. B - Grooved Inlet, Flanged Outlet –
Groove x 150# - Knob Cover through 8x8" - Bolted Cover above 8x8" -
20 Mesh Startup Screen Included



MODEL	STD. SCREEN	SIZE		LIST PRICE	WEIGHT		ORDER CODE
	Material	Inches	mm	(Standard only)	lb.	kg	(Standard only)
1011G	304SS Perf - .062	2 X 1-1/4	50x32	POA*	14	6.4	–
		2X 1-1/2	50x40	\$892.50	16	7.3	M6727241
		2x2	50x50	POA*	19	8.6	M6740824
		2-1/2x2	50x50	\$971.00	20	9.1	M6701669
		2-1/2x2-1/2	50x50	POA*	22	10.0	–
		3x2	80x50	\$1,280.00	30	14	M6702456
		3X2-1/2	80x65	\$1,341.00	39	18	M6727341
		3x3	80x80	\$1,439.00	40	18	M6702460
		4x3	100x80	\$1,799.00	50	23	M6703056
		4x4	100x100	\$2,029.00	52	24	M6703058
	5x4	125x100	\$2,096.00	80	36	–	
	5x5	125x125	\$2,785.00	85	39	M6703414	
	304SS Perf - .125	6x4	150x100	\$3,128.00	106	48	M6703774
		6x5	150x125	\$3,224.00	110	50	M6703777
		6x6	150x150	\$3,323.00	113	51	M6703780
		8x6	200x150	\$3,914.00	167	76	M6704241
		8x8	200x200	\$5,022.00	222	101	M6729978
		10x8	250x200	\$6,736.00	236	107	M6730322
		10x10	250x250	\$8,810.00	243	110	–
		12x8	250x200	POA*	CF	CF	–
12x10		300x250	POA*	CF	CF	–	
12x12		300x300	POA*	CF	CF	–	

Model 722G

Class 300

Ductile Iron Triple Duty Control Chek® Valve – ASTM A395 -
Grooved End - Bolted Yoke/Cover - Position Indicator



MODEL	SIZE		LIST PRICE	WEIGHT		ORDER CODE
	Inches	mm	(Standard only)	lb.	kg	(Standard only)
722G	2	50	\$2,338.00	34	15.4	M6701458
	2-1/2	65	\$2,598.00	40	18	M6701633
	3	80	\$2,945.00	50	23	M6702390
	4	100	\$4,325.00	100	45	M6703002
	5	125	\$4,932.00	155	70	M6703396
	6	150	\$6,920.00	200	91	M6703731
	8	200	POA*	350	159	M6704206
	10	250	POA*	480	218	M6704614
	12	300	POA*	660	299	M6730724
14	350	POA*	790	358	–	

How to Order a Sure Check™

Ordering Information: Important! To assist you in ordering the proper Sure Check™ Valve for your installation the following information is helpful: operating pressure, temperature, flow rates and/or velocity and the type of pump used in the installation. If corrosive fluids are involved, we need to know that also.

Example:

8.0-74-DHD-T-W-X

Eight inch model 74, carbon steel body, 316 SS shaft, carbon steel disc, body finished for metal-to-metal seat with 316L SS welded overlay, Inconel 600 spring, special feature is welded 316L SS overlay on disc.

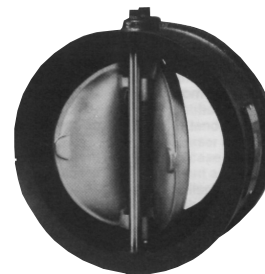

Example:

6.0-71-AHI-3-H-O

Six inch, model 71, cast iron body, 316 SS shaft, ductile iron disc, Buna-N seat, 316 SS spring, no special features.

6.0 - 71 - AHI - 3 - H - O

SIZE
MODEL NO.

ITEM	MATERIAL	CODE	MATERIAL	CODE
	Carbon Steel	D	Al. Bronze	K
	Cast Iron	A	Aluminum	J
	316 SS	H	Ductile Iron	I
Shaft	316 SS	H	Monel	Q
Disc	Carbon Steel	D	316 SS	H
	Ductile	I	Aluminum	J
	Al. Bronze	K	Overlay-See Special Feature	
Seat	Buna-N (-20° TO 250°F)	3	Monel overlay	Q
	EPDM (-40° TO 300°F)	6	316L SS overlay	T
	Teflon (-200° TO 450°F)	7	410 SS overlay	F
	Viton (-20° TO 400°F)	4		
			Stellite #6 overlay	V
	Repeat body material code in this position for metal to metal seat without overlay.			
Spring	316 SS (up to 250°F)	H	Inconel 600 (up to 650°F)	W
	Inconel X (up to 1000°F)	X	Monel	Q

SPECIAL FEATURE

Use X to indicate special features including metal overlay on body or disc. Include full description. Place O in this position if no special feature is required.

Material Specifications:

BODY:

- Cast Iron ASTM A126-B
- Carbon Steel ASTM A216 WCB
- 316 SS (CF8M) ASTM B62
- Al. Bronze ASTM B148
- Aluminum ASTM B26-52T Gr. SG 70A
- Ductile Iron ASTM A395

SHAFT:

- 316SS ASTM A479
- Monel

DISCS:

- Ductile Iron ASTM A395
- Al. Bronze ASTM B148
- 316 SS (CF8M) ASTM A351
- Carbon Steel ASTM A216 WCB
- Aluminum ASTM B26-52T Gr. SG 70A

ELASTOMER SEATS:

- Buna-N
- EPDM
- Teflon
- Viton

SPECIAL FEATURES:

- Welded Metal Overlays
- Micron Smooth Finished Ends
- Ring Joint Ends
- Grooved Ends
- Drain Connections
- Rubber Lined
- Consult factory, we can overlay with most weldable materials.

Double Disc Wafer Sure Check™ Valves

Iron Body

Model 71

Class 125

Iron Body Wafer Style – ASTM A126 Gr. B -

Double Disc - 316SS DISC - Buna-N Seat Standard



MODEL	STD. TRIM		SIZE		LIST PRICE (Standard only)	ADDERS (ADD TO STANDARD LIST PRICE)			WEIGHT		ORDER CODE	
	Disc	Seat	Inches	mm		ALT. DISC I - Ductile/ Nickel	ALT. SEAT Metal-to-Metal	ALT. SPRING W - Inconel	lb.	kg	(Standard only)	Import
71-AHH-3H	316SS	Buna-N	2	50	\$350.00	POA*	N/A	\$132.50	4	1.8	M6701429	M6740583
			2-1/2	65	\$406.00	POA*	N/A	\$178.50	6	2.7	M6701621	M6740584
			3	80	\$469.00	POA*	N/A	\$310.50	8	3.6	M6702356	M6740585
			4	100	\$602.50	POA*	N/A	\$343.50	14	6.4	M6702960	M6740586
			5	125	\$913.50	POA*	N/A	\$383.00	18	8.2	M6703384	M6740587
			6	150	\$1,072.00	POA*	N/A	\$416.00	27	12.2	M6703689	M6740588
			8	200	\$2,188.00	POA*	N/A	\$442.50	50	23	M6704175	M6740589
			10	250	\$3,602.00	POA*	N/A	\$489.00	70	32	M6704584	M6740590
			12	300	\$4,898.00	POA*	N/A	\$700.00	108	49	M6705046	M6740591
			14	350	\$9,014.00	POA*	N/A	\$1,057.00	170	77	M6705344	-
			16	400	\$12,206.00	POA*	N/A	\$1,057.00	225	102	M6705566	-
			18	450	\$15,424.00	POA*	N/A	\$1,123.00	260	118	M6705758	-
			20	500	\$16,817.00	POA*	N/A	\$1,122.00	300	136	M6705880	-
24	600	\$23,372.00	POA*	N/A	\$1,188.00	480	218	M6706037	-			
30	750	POA*	POA*	N/A	POA*	1050	476	M6706177	-			

Model 71U-AHB

Class 125

Iron Body Wafer Style – ASTM A126 Gr. B - Double Disc - Bronze Disc - Buna-N Seat - UL Approved

MODEL	STD. TRIM		SIZE		LIST PRICE	WEIGHT		ORDER CODE
	Disc	Seat	Inches	mm		lb.	kg	
71U-AHB-3H	Bronze	Buna-N	4	100	\$941.50	15	7	M6702966
			6	150	\$1,488.00	33	15	M6703697
			8	200	\$2,270.00	58	26	M6704181
			10	250	\$3,597.00	89	40	M6704589
			12	300	\$4,890.00	160	73	M6705051

Cast Ductile Iron Body

Model 72

Class 150

Ductile Iron Body Wafer Style – ASTM A395 - Double Disc - 316 Disc -
Buna-N Seat Standard - FM Approved, sizes 2" - 14"



MODEL	STD. TRIM		SIZE		LIST PRICE (Standard only)	ADDERS (ADD TO STANDARD LIST PRICE)				WEIGHT		ORDER CODE (Standard only)
	Disc	Seat	Inches	mm		ALT. DISC		ALT. SEAT	ALT. SPRING	lb.	kg	
						I - Ductile/ Nickel	H - 316SS	Metal-to-Metal	W - Inconel			
72-IHH-3H	316SS	Buna-N	2	50	\$610.50	POA*	No charge	N/A	\$132.50	5	2.3	M6701455
			2-1/2	65	\$719.00	POA*	No charge	N/A	\$178.50	8	3.6	M6727247
			3	80	\$828.00	POA*	No charge	N/A	\$310.50	10	4.5	M6702387
			4	100	\$1,049.00	POA*	No charge	N/A	\$343.50	16	7.3	M6702996
			5	125	\$1,524.00	POA*	No charge	N/A	\$383.00	21	9.5	M6727439
			6	150	\$2,037.00	POA*	No charge	N/A	\$416.00	29	13.2	M6703725
			8	200	\$2,579.00	POA*	No charge	N/A	\$442.50	52	24	M6704202
			10	250	\$4,074.00	POA*	No charge	N/A	\$488.50	93	42	M6704608
			12	300	\$5,435.00	POA*	No charge	N/A	\$700.00	147	67	M6705066
			14	350	\$10,942.00	POA*	No charge	N/A	\$1,057.00	220	100	M6705357
			16	400	POA*	POA*	POA*	N/A	\$1,056.00	240	109	-
			18	450	POA*	POA*	POA*	N/A	\$1,122.00	280	127	M6743776
			20	500	POA*	POA*	POA*	N/A	\$1,122.00	400	181	
			24	600	POA*	POA*	POA*	N/A	\$1,188.00	560	254	M6743775
30	750	POA*	POA*	POA*	N/A	POA*	1100	499	-			

Model 74

Class 300

Ductile Iron Body Wafer Style – ASTM A395 - Double Disc - 316 Disc -
Buna-N Seat Standard



MODEL	STD. TRIM		SIZE		LIST PRICE (Standard only)	ADDERS (ADD TO STANDARD LIST PRICE)				WEIGHT		ORDER CODE (Standard only)
	Disc	Seat	Inches	mm		ALT. DISC		ALT. SEAT	ALT. SPRING	lb.	kg	
						I - Ductile/ Nickel	H - 316SS	Metal-to-Metal	W - Inconel			
74-IHH-3H	316SS	Buna-N	2	50	\$688.00	POA*	No charge	N/A	\$132.50	6	2.7	M6738484
			2-1/2	65	\$943.00	POA*	No charge	N/A	\$178.50	8	3.6	M6734344
			3	80	\$956.50	POA*	No charge	N/A	\$310.50	12	5.4	M6747583
			4	100	\$1,228.00	POA*	No charge	N/A	\$343.50	17	7.7	M6746328
			5	125	\$1,923.00	POA*	No charge	N/A	\$383.00	28	12.7	M6738839
			6	150	\$1,991.00	POA*	No charge	N/A	\$416.00	35	16	M6753723
			8	200	\$2,990.00	POA*	No charge	N/A	\$442.50	73	33	M6748000
			10	250	\$4,379.00	POA*	No charge	N/A	\$488.50	130	59	-
			12	300	\$7,031.00	POA*	No charge	N/A	\$700.00	171	78	M6746072
			14	350	\$11,259.00	POA*	No charge	N/A	\$1,057.00	228	103	M6748387
			16	400	\$15,834.00	POA*	No charge	N/A	\$1,056.00	315	143	M6756742
			18	450	POA*	POA*	POA*	N/A	\$1,122.00	415	188	-
			20	500	POA*	POA*	POA*	N/A	\$1,122.00	570	259	-
			24	600	POA*	POA*	POA*	N/A	\$1,188.00	780	354	-
30	750	POA*	POA*	POA*	N/A	POA*	1400	635	-			

Cast Bronze Body

Model 72

Class 150

Cast Al. Bronze Body – Wafer Style – 150# – Al. Bronze Disc – Buna-N Seat



MODEL	STD. TRIM		SIZE		LIST PRICE (Standard only)
	Disc	Seat	Inches	mm	
72-KHK	Al. Bronze	Buna-N	All		POA*
72-KQK	Al. Bronze	Buna-N			POA*

Model 74

Class 300

Cast Al. Bronze Body – Wafer Style – 300# – Al. Bronze Disc – Buna-N Seat



MODEL	STD. TRIM		SIZE		LIST PRICE (Standard only)
	Disc	Seat	Inches	mm	
72-KHK	Al. Bronze	Buna-N	All		POA*
72-KQK	Al. Bronze	Buna-N			POA*

Carbon Steel Body

Model 72

Class 150

Carbon Steel Body Wafer Style – ASTM WCB - Double Disc - Carbon Steel Disc - Buna-N Seat Standard



MODEL	STD. TRIM		SIZE		LIST PRICE (Standard only)	ADDERS (ADD TO STANDARD LIST PRICE)				WEIGHT		ORDER CODE (Standard only)
	Disc	Seat	Inches	mm		ALT. DISC		ALT. SEAT	ALT. SPRING	lb.	kg	
						I - Ductile/ Nickel	H - 316SS	Metal-to-Metal	W - Inconel			
72-DHD-3H	CS	Buna-N	2	50	\$982.50	N/A	\$234.50	No charge	\$132.50	5	2.3	M6701438
			2-1/2	65	\$1,177.00	N/A	\$432.50	No charge	\$178.50	8	3.6	M6701625
			3	80	\$1,223.00	N/A	\$545.50	No charge	\$310.50	10	4.5	M6702367
			4	100	\$1,634.00	N/A	\$431.50	No charge	\$343.50	16	7.3	M6702973
			5	125	\$2,147.00	N/A	\$511.50	No charge	\$383.00	21	9.5	M6703388
			6	150	\$2,187.00	N/A	\$522.00	No charge	\$416.00	29	13.2	M6703703
			8	200	\$3,280.00	N/A	\$818.50	No charge	\$442.50	52	24	M6704186
			10	250	\$5,201.00	N/A	\$1,028.00	No charge	\$488.50	93	42	M6704593
			12	300	\$7,110.00	N/A	\$1,614.00	No charge	\$700.00	147	67	M6705054
			14	350	\$12,041.00	N/A	\$2,480.00	No charge	\$1,057.00	220	100	M6705351
			16	400	POA*	N/A	POA*	No charge	\$1,056.00	240	109	-
			18	450	POA*	N/A	POA*	No charge	\$1,122.00	280	127	M6705760
			20	500	POA*	N/A	POA*	No charge	\$1,122.00	400	181	M6730618
			24	600	POA*	N/A	POA*	No charge	\$1,188.00	560	254	M6706039
30	750	POA*	N/A	POA*	No charge	POA*	1100	499	M6727614			

Model 74

Class 300

Carbon Steel Body Wafer Style – ASTM WCB - Double Disc - Carbon Steel Disc - Buna-N Seat Standard



MODEL	STD. TRIM		SIZE		LIST PRICE (Standard only)	ADDERS (ADD TO STANDARD LIST PRICE)				WEIGHT		ORDER CODE (Standard only)
	Disc	Seat	Inches	mm		ALT. DISC		ALT. SEAT	ALT. SPRING	lb.	kg	
						I - Ductile/ Nickel	H - 316SS	Metal-to-Metal	W - Inconel			
74-DHD-3H	CS	Buna-N	2	50	\$1,293.00	N/A	\$234.50	No charge	\$132.50	6	2.7	M6701461
			2-1/2	65	\$1,446.00	N/A	\$432.00	No charge	\$178.50	8	3.6	M6733276
			3	80	\$1,574.00	N/A	\$546.00	No charge	\$310.50	12	5.4	M6702394
			4	100	\$1,871.00	N/A	\$431.00	No charge	\$343.50	17	7.7	M6703004
			5	125	\$2,394.00	N/A	\$511.50	No charge	\$383.00	28	12.7	-
			6	150	\$2,841.00	N/A	\$522.00	No charge	\$416.00	35	15.9	M6703732
			8	200	\$4,247.00	N/A	\$818.50	No charge	\$442.50	73	33	M6704208
			10	250	\$5,789.00	N/A	\$1,028.00	No charge	\$488.50	120	54	-
			12	300	\$8,201.00	N/A	\$1,615.00	No charge	\$700.00	171	78	M6705071
			14	350	\$12,509.00	N/A	\$2,480.00	No charge	\$1,056.00	228	103	-
			16	400	POA*	N/A	POA*	No charge	\$1,056.00	315	143	M6733778
			18	450	POA*	N/A	POA*	No charge	\$1,122.00	415	188	-
			20	500	POA*	N/A	POA*	No charge	\$1,122.00	570	259	M6735464
			24	600	POA*	N/A	POA*	No charge	\$1,188.00	780	354	-
30	750	POA*	N/A	POA*	No charge	POA*	CF	CF	-			

Cast Carbon Steel Body

Model 76 Class 600

Cast Carbon Steel Body – WCB - Wafer Style – 600# - Carbon Steel Disc - Metal-to-Metal Seat Standard – POA*

MODEL	STD. TRIM		SIZE		LIST PRICE (Standard only)
	Disc	Seat	Inches	mm	
76-DHD	CS	Metal	All		POA*
76-DHH	SS	Metal			POA*



Model 77 Class 900

Cast Bronze Body - Wafer Style – 900# - Carbon Steel Disc - Metal-to-Metal Seat Standard – POA*

MODEL	STD. TRIM		SIZE		LIST PRICE (Standard only)
	Disc	Seat	Inches	mm	
77-DHD	CS	Metal	All		POA*
77-DHH	SS	Metal			POA*



Model 78 Class 1500

Cast Bronze Body - Wafer Style – 1500# - Carbon Steel Disc - Metal-to-Metal Seat Standard – POA*

MODEL	STD. TRIM		SIZE		LIST PRICE (Standard only)
	Disc	Seat	Inches	mm	
78-DHD	CS	Metal	All		POA*
78-DHH	SS	Metal			POA*



Stainless Steel Body

Model 72

Class 150

Stainless Steel Body Wafer Style – ASTM A351 CF8M - Double Disc -

Stainless Steel Disc - Buna-N Seat Standard



MODEL	STD. TRIM		SIZE		LIST PRICE (Standard only)	ADDERS (ADD TO STANDARD LIST PRICE)				WEIGHT		ORDER CODE (Standard only)
	Disc	Seat	Inches	mm		ALT. DISC I - Ductile/ Nickel	ALT. SEAT 4 - Viton H - Metal-to-Metal		ALT. SPRING W - Inconel	lb.	kg	
72-HHH-3H	SS	Buna-N	2	50	\$1,473.00	N/A	\$106.00	No charge	\$132.50	5	2.3	M6701450
			2-1/2	65	\$2,004.00	N/A	\$106.00	No charge	\$178.50	7.5	3.4	M6701629
			3	80	\$2,332.00	N/A	\$132.50	No charge	\$310.50	9.5	4.3	M6702381
			4	100	\$2,518.00	N/A	\$185.00	No charge	\$343.50	16	7.3	M6702988
			5	125	\$4,253.00	N/A	\$185.00	No charge	\$383.00	21	9.5	M6703391
			6	150	\$4,253.00	N/A	\$198.50	No charge	\$416.00	29	13.2	M6703718
			8	200	\$8,043.00	N/A	\$264.50	No charge	\$442.50	52	24	M6704196
			10	250	\$12,062.00	N/A	\$792.50	No charge	\$488.50	93	42	M6704603
			12	300	\$18,695.00	N/A	\$792.50	No charge	\$700.00	147	67	M6705062
			14	350	\$29,910.00	N/A	\$1,056.00	No charge	\$1,056.00	220	100	M6705354
			16	400	POA*	N/A	POA*	No charge	\$1,056.00	240	109	M6705574
			18	450	POA*	N/A	POA*	No charge	\$1,122.00	280	127	–
			20	500	POA*	N/A	POA*	No charge	\$1,122.00	400	181	–
24	600	POA*	N/A	POA*	No charge	\$1,188.00	560	254	M6730345			
30	750	POA*	N/A	POA*	No charge	POA*	CF	CF	–			

Model 74

Class 300

Stainless Steel Body Wafer Style – ASTM A351 CF8M - Double Disc -

Stainless Steel Disc - Buna-N Seat Standard



MODEL	STD. TRIM		SIZE		LIST PRICE (Standard only)	ADDERS (ADD TO STANDARD LIST PRICE)				WEIGHT		ORDER CODE (Standard only)
	Disc	Seat	Inches	mm		ALT. DISC I - Ductile/ Nickel	ALT. SEAT 4 - Viton H - Metal-to-Metal		ALT. SPRING W - Inconel	lb.	kg	
74-HHH-3H	SS	Buna-N	2	50	\$1,685.00	N/A	\$106.00	No charge	\$132.50	5	2.3	M6701465
			2-1/2	65	\$1,938.00	N/A	\$106.00	No charge	\$178.50	7.5	3.4	–
			3	80	\$2,448.00	N/A	\$132.00	No charge	\$310.50	9.5	4.3	M6702400
			4	100	\$2,464.00	N/A	\$185.00	No charge	\$343.50	16	7.3	M6703012
			5	125	\$4,211.00	N/A	\$185.00	No charge	\$383.00	21	9.5	–
			6	300	\$5,322.00	N/A	\$198.00	No charge	\$416.00	29	13.2	M6703741
			8	200	\$9,366.00	N/A	\$264.00	No charge	\$442.50	52	24	M6704213
			10	250	\$13,692.00	N/A	\$792.00	No charge	\$488.50	93	42	M6734407
12	300	\$17,469.00	N/A	\$792.00	No charge	\$700.00	147	67	–			

Cast Iron

Model 1600D Class 125

Cast Iron - A126 Gr. B

MODEL	SIZE	LIST PRICE	WEIGHT (LBS)	WEIGHT (KG)	ORDER CODE
1600D	2	\$1,569.00	7	3.2	M6708372
	2.5	\$2,352.00	11	5.0	M6730626
	3	\$2,352.00	12	5.4	M6708373
	4	\$3,277.00	15	6.8	M6708375
	5	\$4,179.00	27	12.2	M6708377
	6	\$4,501.00	38	17.2	M6708379
	8	\$5,479.00	60	27.2	M6708380
	10	\$6,890.00	86	39.0	M6708382
	12	\$13,650.00	168	76.2	M6708383

Model 1602D Class 250

Cast Iron - A126 Gr. B

MODEL	SIZE	LIST PRICE	WEIGHT (LBS)	WEIGHT (KG)	ORDER CODE
1602D	2	POA*	-		
	2.5	POA*	-		
	3	POA*	-		
	4	\$3,762.00	17	7.7	M6708376
	5	\$4,860.00	30	13.6	M6708378
	6	\$5,016.00	40	18.1	M6739294
	8	\$8,276.00	75	34.0	M6708381
	10	POA*			
	12	POA*			

Carbon Steel

Model 1601A Class 150

Carbon Steel - WCB

MODEL	SIZE	LIST PRICE	WEIGHT (LBS)	WEIGHT (KG)	ORDER CODE
1601A	2	\$2,032.00	5	2.3	M6708285
	2.5	\$2,032.00	7	3.2	M6708288
	3	\$2,235.00	10	4.5	M6708289
	4	\$2,524.00	15	6.8	M6708291
	5	\$5,071.00	27	12.2	M6708294
	6	\$6,505.00	35	15.9	M6708295
	8	\$7,758.00	56	25.4	M6708298
	10	\$11,253.00	80	36.3	M6708301
	12	\$18,853.00	155	70.3	M6708304

Model 1601AC Class 150

Carbon Steel - WCB - 316SS trim - PTFE Seal

MODEL	SIZE	LIST PRICE	WEIGHT (LBS)	WEIGHT (KG)	ORDER CODE
1601AC	2	\$2,745.00	5	2.3	M6708331
	2.5	\$3,448.00	7	3.2	M6708333
	3	\$3,248.00	10	4.5	M6708335
	4	\$4,249.00	15	6.8	M6708338
	5	\$5,308.00	27	12.2	M6708341
	6	\$6,779.00	35	15.9	M6708343
	8	\$8,064.00	56	25.4	M6708346
	10	\$11,566.00	80	36.3	M6708349
	12	\$19,880.00	155	70.3	M6708351

Model 1601AF Class 150

Carbon Steel - WCB - 401SS trim - Metal-to-Metal Seal

MODEL	SIZE	LIST PRICE	WEIGHT (LBS)	WEIGHT (KG)	ORDER CODE
1601AF	2	\$3,630.00	5	2.3	M3708412
	2.5	POA*			
	3	\$3,630.00	10	4.5	M6708414
	4	\$3,975.00	15	6.8	M6708416
	5	\$5,839.00	27	12.2	M6708419
	6	\$7,288.00	35	15.9	M6708420
	8	POA*			
	10	POA*			
	12	POA*			

Carbon Steel

Model 1603A Class 300

300 Class - Carbon Steel - WCB

MODEL	SIZE	LIST PRICE	WEIGHT (LBS)	WEIGHT (KG)	ORDER CODE
1603A	2	\$2,724.00	7	3.2	M6708286
	2.5	POA*			
	3	\$3,128.00	12	5.4	M6708290
	4	\$3,128.00	17	7.7	M6708292
	5	\$6,505.00			
	6	\$7,523.00	43	19.5	M6708296
	8	\$9,224.00	58	26.3	M6708299
	10	\$21,720.00	100	45.4	M6708302
	12	\$21,720.00	232	105.2	M6708304

Model 1603AC Class 300

Carbon Steel - WCB - 316SS trim - PTFE Seal

MODEL	SIZE	LIST PRICE	WEIGHT (LBS)	WEIGHT (KG)	ORDER CODE
1603AC	2	\$2,885.00	7	3.2	M6708332
	2.5	\$3,731.00	9	4.1	M6708334
	3	\$3,731.00	12	5.4	M6708336
	4	\$4,782.00	17	7.7	M6708339
	5	\$6,936.00	27	12.2	M6708376
	6	\$7,617.00	43	19.5	M6708344
	8	\$13,658.00	58	26.3	M6727740
	10	\$20,604.00	100	45.4	M6743662
	12	POA*			

Model 1603AF Class 300

WCB - 410SS trim - Metal-to-Metal Seal

MODEL	SIZE	LIST PRICE	WEIGHT (LBS)	WEIGHT (KG)	ORDER CODE
1603AF	2	\$3,630.00	7	3.2	M6708413
	2.5	POA*			
	3	\$3,731.00	12	5.4	M6708415
	4	\$4,782.00	17	7.7	M6708417
	5	\$7,523.00			
	6	\$9,036.00	43	19.5	M6708421
	8	POA*			
	10	POA*			
	12	POA*			

Carbon Steel

Model 1605A Class 600

Carbon Steel - WCB

MODEL	SIZE	LIST PRICE	WEIGHT (LBS)	WEIGHT (KG)	ORDER CODE
1605A	2	\$2,774.00	7	3.2	M6708286
	2.5	POA*			
	3	\$3,128.00	12	5.4	M6708290
	4	\$4,013.00	19	8.6	M6708293
	5	POA*			
	6	\$7,523.00	45	20.4	M6708297
	8	\$9,271.00	88	39.9	M6708300
	10	\$23,805.00	150	68.0	M6708303
	12	POA*			

Model 1605AC Class 600

600 Class - Carbon Steel - WCB - 316SS trim - PTFE Seat

MODEL	SIZE	LIST PRICE	WEIGHT (LBS)	WEIGHT (KG)	ORDER CODE
1605AC	2	\$2,885.00	7	3.2	M6708332
	2.5	\$3,731.00	9	4.1	M6708334
	3	\$3,731.00	12	5.4	M6708336
	4	\$4,796.00	19	8.6	M6708340
	5	POA*			
	6	\$6,997.00	45	20.4	M6708345
	8	\$12,591.00	88	39.9	M6708347
	10	\$33,271.00	150	68.0	M6727441
	12	\$23,293.00	236	107.0	M6708352

Stainless Steel

Model 1601C Class 150

Stainless Steel - A351 - CF8M

MODEL	SIZE	LIST PRICE	WEIGHT (LBS)	WEIGHT (KG)	ORDER CODE
1601C	2	\$2,644.00	5	2.3	M6708356
	2.5	POA*			
	3	\$2,729.00	10	4.5	M6708359
	4	\$5,292.00	15	6.8	M6708361
	5	\$5,674.00	27	12.2	M6708363
	6	\$7,458.00	35	15.9	M6708364
	8	\$10,525.00	56	25.4	M6708366
	10	\$15,923.00	80	36.3	M6708367
	12	\$23,259.00	155	70.3	M6708369

Model 1603C Class 300

Stainless Steel - A351 - CF8M

MODEL	SIZE	LIST PRICE	WEIGHT (LBS)	WEIGHT (KG)	ORDER CODE
1603C	2	\$2,644.00	5	2.3	M6708357
	2.5	POA*			
	3	\$3,264.00	10	4.5	M6708360
	4	\$5,292.00	15	6.8	M6708362
	5	POA*			
	6	\$8,460.00	43	19.5	M6708365
	8	\$14,571.00	56	25.4	M6732688
	10	\$19,847.00	100	45.4	M6708368
	12	\$28,361.00	236	107.0	M6734249

Prices on Application (POA*), Call Factory (CF)

Center Guided Silent Check Valves



Wafer Type



Compact Wafer Type



Globe Type

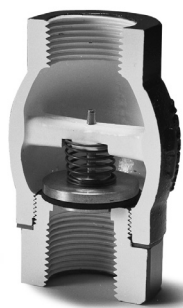

Screwed End Type

BODY MATERIALS		ASTM DESIGNATION	MODEL NUMBER CODE			
A	Semi-Steel (Cast Iron)	A-126 Class B	<p style="text-align: center;">EXAMPLE: #101M - A - T - " "</p> <div style="display: flex; justify-content: space-around; align-items: center;"> <div style="text-align: center;"> <p>BODY TYPE</p> </div> <div style="text-align: center;"> <p>BODY MATERIAL</p> </div> <div style="text-align: center;"> <p>TRIM</p> </div> <div style="text-align: center;"> <p>PUT SPECIAL FEATURE CODE HERE (see below)</p> </div> </div> <p>These numbers describe valves furnished with standard trim. For any other type of trim refer to guide located at left and substitute the correct letter indicating the trim material you require.</p>			
B	Bronze, 85-5-5-5	B-62				
C	Bronze, M Metal	B-61				
D	Carbon Steel	A-216 Gr. WCB				
E	Carbon Moly	A-217 Gr. WC1				
F	Stainless, Type 410	A-296 Gr. CA-15				
G	Stainless, Type 304	A-296 Gr. CF8				
H	Stainless, Type 316	A-351 Gr. CF8M				
I	Ductile Iron	A-395				
J	Aluminum	B-26				
K	Al. Bronze					
TRIM MATERIALS		ASTM DESIGNATION			GUIDE PINS	
Q	Bronze, M Metal	B-61			Stainless, Type 304	A-479
R	Stainless, Type 410	A-296 Gr. CA-15	Silicon Bronze	B-98		
SPRINGS		ASTM DESIGNATION	SPECIAL FEATURE CODES			
	Stainless, Type 302	A-276	3	Stainless, Type 304		
	Inconel	600	6	Buna-N		
			4	Viton		
			X	Inconel X-750 Spring		
			E	Epoxy Coating		
			M	Metal to Metal Seat		
			Q	Monel 400		

Standard Spring is 302SS
 Buna-N or EPDM Seats are available, POA*
 Other material, overlays, sizes and pressure ratings available, POA*, Call Factory (CF)

Cast Iron Body

MODELS 91A, 92A **Class 150**

Cast Iron Compact Wafer Style – ASTM A126 Gr.B - 316SS Disc Standard - 316SS Seat Standard - Compact design, use with 125# or 150# Flanges



MODEL	STANDARD TRIM		SIZE		LIST PRICE	WEIGHT		ORDER CODE	ORDER CODE
	Disc	Seat	Inches	mm	Standard Only	lbs	kg	(Standard Only)	(Import)
91 AT	316SS	316SS	1-1/2	35	\$444.50	4	1.8	M6700796	M6710750
			2	50	\$539.50	5	2.3	M6701530	M6741054
			2-1/2	65	\$587.00	8	3.6	M6701665	M6741055
			3	80	\$625.50	10	4.5	M6702451	M6741056
			4	100	\$798.50	18	8.2	M6703049	M6741057
			5	125	\$1,059.00	28	12.7	M6703409	M6741058
			6	150	\$1,405.00	38	17	M6703771	M6741059
92 AT	316SS	316SS	8	200	\$2,381.00	86	39	M6704235	M6741060
			10	250	\$4,119.00	163	74	M6737621	M6741061
			12	300	\$7,859.00	269	122	M6747426	M6741062

Cast Iron Body

Model 101

Class 125

Cast Iron Body – ASTM A126 Gr. B - Full Flange Wafer Type - 316SS Disc Standard - 316SS Seat Standard - Use with 125# or 150# Flanges



MODEL	STD. TRIM		SIZE		LIST PRICE	WEIGHT		ORDER CODE
	Disc	Seat	Inches	mm	(Standard only)	lb.	kg	(Standard only)
101MAT	316SS	316SS	1	25	\$482.50	10	4.5	M6749331
			1-1/4	32	\$499.00	13	5.9	M6746481
			1-1/2	40	\$625.50	15	6.8	M6700694
			2	50	\$720.50	20	9.1	M6701278
			2-1/2	65	\$865.00	25	11.3	M6701537
			3	80	\$904.50	28	12.7	M6702173
			4	100	\$1,114.00	38	17	M6702785
			5	125	\$1,757.00	53	24	M6703327
			6	150	\$2,304.00	70	32	M6703520
			8	114	\$3,836.00	114	52	M6704021
10	178	\$4,909.00	178	81	M6704472			

Model 105

Class 125

Cast Iron Body – ASTM A126 Gr. B - Flange Globe Type - 316SS Standard - 316SS Seat Standard - Use with 125# or 150# Flanges



MODEL	STD. TRIM		SIZE		LIST PRICE	WEIGHT		ORDER CODE	ORDER CODE
	Disc	Seat	Inches	mm	(Standard only)	lb.	kg	(Standard only)	(Import)
105MAT	316SS	316SS	2	50	\$900.50	20	9.1	M6701288	M6741044
			2-1/2	65	\$1,210.00	24	10.9	M6701546	M6741045
			3	80	\$1,425.00	32	14.5	M6702185	M6741046
			4	100	\$2,010.00	56	25	M6702794	M6741047
			5	125	\$2,803.00	74	34	M6744954	M6741048
			6	150	\$3,524.00	95	43	M6703532	M6741049
			8	200	\$6,342.00	178	81	M6704028	M6741050
			10	250	\$8,101.00	265	120	M6704479	M6741051
			12	300	\$13,382.00	454	206	M6704980	M6741052
			14	350	\$18,309.00	598	271	M6705305	M6747425
			16	400	\$20,244.00	840	381	M6705541	-
			18	450	\$24,254.00	892	405	M6748614	-
			20	500	\$33,015.00	1140	517	M6751443	-
			24	550	\$40,857.00	1540	699	M6738190	-

Standard Spring is 302SS

Buna-N or EPDM Seats are available, POA*

Other material, overlays, sizes and pressure ratings available, POA*, Call Factory (CF)

Cast Iron Body

Model 103

Class250

Cast Iron Body – ASTM A126 Gr. B - Full Flange Wafer Type - 316SS Disc Standard - 316SS Seat Standard - Use with 250# or 300# Flanges



MODEL	STD. TRIM		SIZE		LIST PRICE	WEIGHT		ORDER CODE
	Disc	Seat	Inches	mm	(Standard only)	lb.	kg	(Standard only)
103MAT	316SS	316SS	1	25	\$839.00	12	5.4	M6751439
			1-1/4	32	\$927.00	16	7.3	M6736066
			1-1/2	40	\$1,105.00	19	8.6	M6748629
			2	50	\$1,306.00	25	11.3	M6701284
			2-1/2	65	\$1,586.00	29	13.2	M6701542
			3	80	\$1,825.00	34	15.4	M6702179
			4	100	\$1,925.00	54	24	M6741064
			5	125	\$3,165.00	75	34	M6703331
			6	150	\$4,603.00	94	43	M6703527

Model 107

Class 250

Cast Iron Body – ASTM A126 Gr. B - Flange Globe Type - 316SS Disc Standard - 316SS Seat Standard - Use with 250# or 300# Flanges



MODEL	STD. TRIM		SIZE		LIST PRICE	ADDERS (ADD TO STANDARD LIST PRICE)	WEIGHT		ORDER CODE
	Disc	Seat	Inches	mm	(Standard only)	ALT. TRIM T - 316SS Disc, Seat	lb.	kg	(Standard only)
107MAT	316SS	316SS	2	50	\$1,900.00	No charge	24	10.9	M6727225
			2-1/2	65	\$2,051.00	No charge	31	14.1	M6744479
			3	80	\$2,445.00	No charge	44	20.0	M6702192
			4	100	\$3,264.00	No charge	74	34	M6702805
			5	125	\$4,247.00	No charge	105	48	M6703337
			6	150	\$5,826.00	No charge	134	61	M6703540
			8	200	\$7,055.00	No charge	230	104	M6704034
			10	250	\$10,060.00	No charge	344	156	M6704485
			12	300	\$16,760.00	No charge	520	236	M6704986
			14	350	\$22,327.00	No charge	725	329	M6705307
			16	400	\$30,635.00	No charge	1000	454	M6705544
			18	450	\$39,586.00	No charge	1350	612	M6752757
			20	500	\$51,829.00	No charge	1775	805	—
			24	550	POA*	No charge	CF	CF	—

Also available as Import to 14" Specify 105MAT-N

Standard Spring is 302SS

Buna-N or EPDM Seats are available, POA*

Other material, overlays, sizes and pressure ratings available, POA*, Call Factory (CF)

Cast Iron Body

Model 303

Class 125

Cast Iron Body – ASTM A126 Gr. B - Screwed End Type – FNPT -
Bronze Disc Standard - Bronze Seat Standard



MODEL	STD. TRIM		SIZE		LIST PRICE (Standard only)	ADDERS (ADD TO STANDARD LIST PRICE)	WEIGHT		ORDER CODE (Standard only)
	Disc	Seat	Inches	mm			lb.	kg	
303AP	Bronze	EPDM	1/4	8	\$254.50	ALT. TRIM T - 316SS Disc, Seat \$55.00	0.94	0.4	M6700103
			3/8	10	\$254.50	\$55.00	0.94	0.4	M6700121
			1/2	15	\$254.50	\$55.00	0.94	0.4	M6700146
			3/4	20	\$266.00	\$85.00	1.13	0.5	M6700197
			1	25	\$276.50	\$108.50	1.81	0.8	M6700568
			1-1/4	32	\$365.00	\$117.00	4.19	1.9	M6700657
			1-1/2	40	\$443.00	\$132.50	4.31	2	M6700722
			2	50	\$607.00	\$146.00	5.31	2	M6701339

CF**

Bronze Body

Model 101Mbp

Class 150

Bronze Body – ASTM B62 - Full Flange Wafer Type - Bronze Disc Standard -
Bronze Seat Standard



POA*

Model 105Mbp

Class 150

Bronze Body – ASTM B62 - Full Flange Globe Type – 150# - Bronze Disc
Standard - Bronze Seat Standard



POA*

Model 103Mbp

Class 300

Bronze Body – ASTM B62 - Full Flange Wafer Type - Bronze Disc
Standard - Bronze Seat Standard



POA*

Model 109Mbp

Class 300

Bronze Body – ASTM B62 - Full Flange Globe Type – 300# - Bronze Disc
Standard - Bronze Seat Standard



POA*

Model 303Bp

Class 600

Bronze Body – ASTM B62 - Screwed End Type - FNPT -
Bronze Disc Standard - EPDM Seat Standard



POA*

Standard Spring is 302SS
Buna-N or EPDM Seats are available, POA*
Other material, overlays, sizes and pressure ratings available, POA*, Call Factory (CF)

Cast Carbon Steel Body

Model 101

Class 150

Cast Carbon Steel Body – ASTM A216 WCB - Full Flange Wafer Type - Stainless Steel Disc Standard - Stainless Steel Seat Standard - Use with 150# Flanges



MODEL	STD. TRIM		SIZE		LIST PRICE	ADDERS (ADD TO STANDARD LIST PRICE)	WEIGHT		ORDER CODE
	Disc	Seat	Inches	mm	(Standard only)	ALT. TRIM	lb.	kg	(Standard only)
101MDT	316SS	316SS	1	25	\$1,587.00	POA*	10	4.5	M6700549
			1-1/4	32	POA*	POA*	13	5.9	–
			1-1/2	40	\$1,737.00	POA*	15	6.8	M6700695
			2	50	\$2,094.00	POA*	20	9.1	M6701280
			2-1/2	65	\$2,524.00	POA*	25	11.3	M6701539
			3	80	\$2,933.00	POA*	28	12.7	M6702175
			4	100	\$3,998.00	POA*	38	17	M6702787
			5	125	\$5,020.00	POA*	53	24	M6730002
			6	150	\$6,478.00	POA*	70	32	M6703522
			8	114	\$9,383.00	POA*	114	52	M6704022
10	178	\$13,222.00	POA*	178	81	M6704474			

Model 105

Class 150

Flange Globe Type – 150# - Stainless Steel Disc Standard - Stainless Steel Seat Standard - Use with 150# Flanges



MODEL	STD. TRIM		SIZE		LIST PRICE	ADDERS (ADD TO STANDARD LIST PRICE)	WEIGHT		ORDER CODE
	Disc	Seat	Inches	mm	(Standard only)	ALT. TRIM	lb.	kg	(Standard only)
105MDT	316SS	316SS	2	50	\$2,284.00	POA*	20	9.1	M6701290
			2-1/2	65	\$2,744.00	POA*	26	11.8	M6701547
			3	80	\$3,064.00	POA*	32	14.5	M6702188
			4	100	\$4,056.00	POA*	52	24	M6702798
			5	125	\$5,100.00	POA*	65	29	M6703335
			6	150	\$6,295.00	POA*	84	38	M6703534
			8	200	\$8,799.00	POA*	156	71	M6704030
			10	250	\$15,240.00	POA*	250	113	M6704480
			12	300	\$18,717.00	POA*	400	181	M6704982
			14	350	POA*	POA*	580	263	M6705306
			16	400	POA*	POA*	850	386	M6705542
			18	450	POA*	POA*	1100	499	M6705737

Standard Spring is 302SS

Buna-N or EPDM Seats are available, POA*

Other material, overlays, sizes and pressure ratings available, POA*, Call Factory (CF)

Cast Carbon Steel Body

Model 103

Class 300

Cast Carbon Steel Body – ASTM A216 WCB - Full Flange Wafer Type - 316SS Disc Standard - 316SS Seat Standard - Use with 300# Flanges



MODEL	STD. TRIM		SIZE		LIST PRICE	ADDERS (ADD TO STANDARD LIST PRICE)	WEIGHT		ORDER CODE
	Disc	Seat	Inches	mm	(Standard only)	ALT. TRIM	lb.	kg	(Standard only)
103MDT	316SS	316SS	1	25	\$2,195.00	POA*	12	5.4	M6706682
			1-1/4	32	\$2,019.00	POA*	16	7.3	M6700644
			1-1/2	40	\$2,036.00	POA*	19	8.6	M6700698
			2	50	\$2,427.00	POA*	25	11.3	M6701285
			2-1/2	65	\$3,169.00	POA*	29	13.2	M6701543
			3	80	\$3,702.00	POA*	34	15.4	M6702181
			4	100	\$4,524.00	POA*	54	24	M6702791
			5	125	\$5,570.00	POA*	75	34	M6703332
			6	150	\$7,421.00	POA*	94	43	M6703528
			8	200	POA*	POA*	150	68	M6704025
10	250	POA*	POA*	226	103	M6704476			

Model 109MDT

Class 300

Cast Carbon Steel Body – ASTM A216 WCB - Full Flange Globe Type - 316SS Disc Standard - 316SS Seat Standard



POA*

Model 131DT

Class 600

Cast Carbon Steel Body – ASTM A216 WCB - Full Flange Wafer Type - 316SS Disc Standard - 316SS Seat Standard



POA*

Model 113DT

Class 600

Cast Carbon Steel Body – ASTM A216 WCB - Full Flange Globe Type - 316SS Disc Standard - 316SS Seat Standard



POA*

Standard Spring is 302SS
Buna-N or EPDM Seats are available, POA*
Other material, overlays, sizes and pressure ratings available, POA*, Call Factory (CF)

Cast Stainless Steel Body

Model 101

Class 150

Cast Stainless Steel Body – ASTM A351 CF8M - Full Flange Wafer Type - Stainless Steel Disc Standard -
Stainless Steel Seat Standard - Use with 150# Flanges



MODEL	STD. TRIM		SIZE		LIST PRICE (Standard only)	ADDERS (ADD TO STANDARD LIST PRICE) ALT. TRIM	WEIGHT		ORDER CODE (Standard only)
	Disc	Seat	Inches	mm			lb.	kg	
101MHT	316SS	316SS	1	25	\$1,903.00	POA*	10	4.5	-
			1-1/4	32	\$2,044.00	POA*	13	5.9	-
			1-1/2	40	\$2,334.00	POA*	15	6.8	-
			2	50	\$3,051.00	POA*	20	9.1	-
			2-1/2	65	\$3,592.00	POA*	25	11.3	-
			3	80	\$4,090.00	POA*	28	12.7	-
			4	100	\$6,089.00	POA*	38	17	-
			5	125	\$7,074.00	POA*	53	24	-
			6	150	\$8,868.00	POA*	70	32	-
			8	114	POA*	POA*	114	52	-
10	178	POA*	POA*	178	81	-			

Model 105

Class 150

Cast Stainless Steel Body – ASTM A351 CF8M - Flange Globe Type – 150# - Stainless Steel Disc Standard -
Stainless Steel Seat Standard - Use with 150# Flanges



MODEL	STD. TRIM		SIZE		LIST PRICE (Standard only)	ADDERS (ADD TO STANDARD LIST PRICE) ALT. TRIM	WEIGHT		ORDER CODE (Standard only)
	Disc	Seat	Inches	mm			lb.	kg	
105MHT	316SS	316SS	2	50	\$3,344.00	POA*	20	9.1	M6701291
			2-1/2	65	\$4,117.00	POA*	26	11.8	M6701548
			3	80	\$5,069.00	POA*	32	14.5	M6702190
			4	100	\$7,060.00	POA*	52	24	M6702802
			5	125	\$9,155.00	POA*	65	29	-
			6	150	\$11,150.00	POA*	84	38	M6703538
			8	200	\$15,765.00	POA*	156	71	M6704032
			10	250	\$22,323.00	POA*	250	113	M6704482
			12-18		POA*	POA*	POA*	POA*	-

Model 103

Class 300

Cast Stainless Steel Body – ASTM A351 CF8M - Full Flange Wafer Type - Stainless Steel Disc Standard -
Stainless Steel Seat Standard - Use with 300# Flanges



MODEL	STD. TRIM		SIZE		LIST PRICE (Standard only)	ADDERS (ADD TO STANDARD LIST PRICE) ALT. TRIM	WEIGHT		ORDER CODE (Standard only)
	Disc	Seat	Inches	mm			lb.	kg	
103MHT	316SS	316SS	1	25	\$2,908.00	POA*	12	5.4	M6700553
			1-1/4	32	\$2,919.00	POA*	16	7.3	-
			1-1/2	40	\$3,256.00	POA*	19	8.6	M6700699
			2	50	\$3,721.00	POA*	25	11.3	M6735707
			2-1/2	65	\$4,734.00	POA*	29	13.2	-
			3	80	\$5,884.00	POA*	34	15.4	M6702182
			4 - 10	100 - 250	POA*	POA*	CF	CF	-

Standard Spring is 302SS

Buna-N or EPDM Seats are available, POA*

Other material, overlays, sizes and pressure ratings available, POA*, Call Factory (CF)

Cast Stainless Steel Body

Model 303HT **Class 300**
 Cast Stainless Steel Body – ASTM A351 CF8M -
 Screwed End Type – FNPT - 316SS Disc Standard -
 EPDM Seat Standard



POA*

Model 109MHT **Class 300**
 Cast Stainless Steel Body – ASTM A351 CF8M -
 Full Flange Globe Style – 300# - 316SS Disc Standard - 316SS Seat
 Standard



POA*

Model 131HT **Class 600**
 Cast Stainless Steel Body – ASTM A351 CF8M -
 Full Flange Wafer Type – 600# - 316SS Disc Standard - 316SS Seat
 Standard



POA*

Model 113HT **Class 600**
 Cast Stainless Steel Body – ASTM A351 CF8M -
 Full Flange Globe Style – 600# - 316SS Disc Standard - 316SS Seat
 Standard



POA*

Standard Spring is 302SS
 Buna-N or EPDM Seats are available, POA*
 Other material, overlays, sizes and pressure ratings available, POA*, Call Factory (CF)

How to order Mueller Steam Specialty Model 88M Butterfly Valves

Example: 04.0-88IHH61

This is a 4 lugged body valve with a ductile iron body, 316 SS stem, 316 SS Disc, EPDM Seat and a ten position handle

4.0 - 88 - IHH - 6 - 1

SIZE: _____

MODEL: _____
88-Full Lug (Replaces previous Model 66M)

BODY: _____
I-Ductile Iron

STEM: _____
H-316SS (Available 2 – 12 only. Specify 431 SS for 14 – 48 sizes)
P-431SS

DISC: _____
H-316SS

SEAT: _____
4-Viton
6-EPDM

OPERATOR: _____
1-10-Position Lever handle (Lockable in both open and closed positions)
5-Gear Operator (Recommended for 10 and above)



Ductile Iron Body

Model 88 EPDM Seated

Ductile Iron Body – ASTM A395 - Lug Style - 316SS Stem Standard (2"-12"), 4
31SS Stem Standard (14"-24") - 316SS Disc Standard - EPDM Seat Standard -
10 Position Lockable Lever Handle Standard to 10" - Gear Operator Standard 12" and larger

MODEL	STD. TRIM			SIZE		LIST PRICE		WEIGHT		ORDER CODE
	Disc	Stem	Seat	Inches	mm	(Standard only)	Gear Operator (-*5)	lb.	kg	(Standard only)
88-IHH-61	316SS	316SS	EPDM	2	50	\$156.00	--	15	7	M6717867
				2-1/2	65	\$188.50	\$137.00	15	7	M6717868
				3	80	\$188.50	\$137.00	18	8	M6717869
				4	100	\$270.00	\$137.00	20	10	M6717870
				5	125	\$318.00	\$137.00	30	14	M6717871
				6	150	\$381.50	\$137.00	32	15	M6717872
				8	200	\$612.00	--	52	24	M6717873
				10	250	\$1,066.00	--	71	32	M6717874
88-IHH-65 (With Gear Operator)	316SS	316SS	EPDM	8	200	\$776.50	Std	68	31	M6717878
				10	250	\$1,276.00	Std	90	41	M6717879
				12	300	\$1,631.00	Std	140	64	M6718076
88-IPH-65	316SS	431SS	EPDM	14	350	\$2,775.00	Std	189	86	M6717886
				16	400	\$4,440.00	Std	273	124	M6717887
				18	450	\$4,863.00	Std	340	154	M6717888
				20	500	\$6,856.00	Std	465	210	M6717889
				24	600	\$9,302.00	Std	675	306	M6717890

Model 88 Viton Seated

Ductile Iron Body – ASTM A395 - Lug Style - 316SS Stem Standard (2"-12"),
431SS Stem Standard (14"-24") - 316SS Disc Standard - Viton Seat -
10 Position Lockable Lever Handle Standard to 10" - Gear Operator Standard 12" and larger

MODEL	STD. TRIM			SIZE		LIST PRICE		WEIGHT		ORDER CODE
	Disc	Stem	Seat	Inches	mm	(Standard only)	Gear Operator (-*5)	lb.	kg	(Standard only)
88-IHH-41	316SS	316SS	Viton	2	50	\$231.00	\$137.50	21	9.5	M6717902
				2-1/2	65	\$263.00	\$137.00	25	11	M6717903
				3	80	\$263.00	\$137.00	26	12	M6717904
				4	100	\$307.50	\$137.00	30	14	M6717905
				5	125	\$504.00	\$137.00	34	15	M6717906
				6	150	\$531.50	\$137.00	39	18	M6717907
				8	200	\$799.50	--	67	30	M6717908
				10	250	\$1,253.00	--	90	41	M6717916
88-IPH-45	316SS	431SS	Viton	12	300	\$2,342.00	Std	128	58	M6717917
				14	350	\$3,485.00	Std	179	81	M6717918
				16	400	\$5,709.00	Std	285	129	M6717919
				18	450	\$6,134.00	Std	340	154	M6717920
				20	500	\$8,124.00	--	465	210	M6717921
				24	600	\$10,573.00	--	675	306	M6717922

Basket Strainers Screens Adder - SS316

PERFORATED SCREEN ADDERS	LIST PRICE ADDER
.033,.045,.062,.125, 5/32"	Disc
1/2"	\$11.50
3/4"	\$16.75
1"	\$21.00
1-1/4"	\$34.75
1-1/2"	\$42.75
2"	\$45.50
2-1/2"	\$64.75
3"	\$86.50
4"	\$117.00
5"	\$188.00
6"	\$188.00
8"	\$242.00
10"	\$282.00
12"	\$351.50
14"	\$458.50
16"	\$755.00

MESH-LINED SCREEN ADDERS	LIST PRICE ADDER
20,30,40,60,80,100 mesh	
1/2"	\$15.50
3/4"	\$22.50
1"	\$29.25
1-1/4"	\$45.50
1-1/2"	\$58.00
2"	\$64.75
2-1/2"	\$101.00
3"	\$129.50
4"	\$191.00
5"	\$229.50
6"	\$232.50
8"	\$316.00
10"	\$394.50
12"	\$465.00
14"	\$916.50
16"	\$984.00

"Y" Strainers - 316 Stainless Steel Screen Adders

MESH SCREEN	LIST PRICE ADDER
20-30	
1/4"	\$3.00
3/8"	\$3.00
1/2"	\$3.00
3/4"	\$5.75
1"	\$7.50
1-1/4"	\$8.50
1-1/2"	\$11.50
2"	\$12.50

PERFORATED SCREEN	LIST PRICE ADDER
.033,.045,.062,.125,5/32"	
1/4"	\$8.50
3/8"	\$8.50
1/2"	\$8.50
3/4"	\$12.50
1"	\$16.75
1-1/4"	\$26.50
1-1/2"	\$33.25
2"	\$36.00
2-1/2"	\$48.50
3"	\$67.75
4"	\$91.00
5"	\$146.00
6"	\$146.00
8"	\$184.50
10"	\$217.00
12"	\$272.00
14"	\$351.50
16"	\$581.00

MESH-LINED SCREEN	LIST PRICE ADDER
20,30,40,60,80,100 mesh	
1/4"	\$11.50
3/8"	\$11.50
1/2"	\$11.50
3/4"	\$18.25
1"	\$22.50
1-1/4"	\$34.75
1-1/2"	\$44.50
2"	\$48.50
2-1/2"	\$77.25
3"	\$101.00
4"	\$149.00
5"	\$177.50
6"	\$177.50
8"	\$242.00
10"	\$303.50
12"	\$358.50
14"	\$542.50
16"	\$755.00

150 and 200 Mesh Lined Screen Adders - 304SS

DESCRIPTION	SIZE (Inches)	LIST PRICE ADDER 150 or 200 mesh lined
Threaded/Solder/Socket Weld	1/4"	\$33.25
Y Strainers, Basket Strainers	3/8"	\$33.25
	1/2"	\$33.25
Duplex Strainers: Use List Price x 2	3/4"	\$46.75
	1"	\$85.50
	1-1/4"	\$89.50
	1-1/2"	\$116.00
	2"	\$171.00
	2-1/2"	\$219.00
	3"	\$285.50
	4"	\$531.50
All Flanged Products	3/4"	\$123.00
Y Strainers, Basket Strainers	1"	\$123.00
	1-1/4"	\$123.00
Duplex Strainers: Use List Price x 2	1-1/2"	\$123.00
	2"	\$176.50
	2-1/2"	\$251.50
	3"	\$297.00
	4"	\$555.00
	5"	\$1,228.00
	6"	\$1,228.00
	8"	\$2,149.00
	10"	\$2,863.00
	12"	\$4,068.00

"Y" Strainers

1/4" Perforated screen 304SS

SIZE	LIST PRICE
1/4"	\$8.50
3/8"	\$8.50
1/2"	\$8.50
3/4"	\$12.50
1"	\$16.75
1-1/4"	\$26.50
1-1/2"	\$33.25
2"	\$36.00
2-1/2"	\$48.50
3"	\$67.75
4"	\$91.00
5"	\$146.00
6"	\$146.00
8"	\$184.50
10"	\$217.00
12"	\$272.00
14"	\$351.50
16"	\$581.00

Basket Strainers

1/4" Perforated screen 304SS

SIZE	LIST PRICE ADDER
1/2"	\$11.50
3/4"	\$16.75
1"	\$21.00
1-1/4"	\$34.75
1-1/2"	\$42.75
2"	\$45.50
2-1/2"	\$64.75
3"	\$86.50
4"	\$117.00
5"	\$188.00
6"	\$188.00
8"	\$242.00
10"	\$282.00
12"	\$351.50
14"	\$458.50
16"	\$755.00
14"	\$351.50
16"	\$581.00

Monel Screen Adders for Basket Strainers

PERFORATED SCREENS	LIST PRICE ADDER
.033, .045, .062, .125, 5/32"	
1/2"	\$362.00
3/4"	\$362.00
1"	\$362.00
1-1/4"	\$503.50
1-1/2"	\$503.50
2"	\$503.50
2-1/2"	\$890.50
3"	\$890.50
4"	\$1,262.00
5"	\$1,500.00
6"	\$1,500.00
8"	\$2,909.00
10"	\$3,987.00
12"	\$6,009.00
14"	\$6,775.00
16"	\$7,411.00

MESH-LINED SCREENS	LIST PRICE ADDER
20,30,40,60,80,100 mesh	
1/2"	\$430.00
3/4"	\$430.00
1"	\$430.00
1-1/4"	\$604.00
1-1/2"	\$604.00
2"	\$604.00
2-1/2"	\$1,295.00
3"	\$1,295.00
4"	\$2,076.00
5"	\$2,578.00
6"	\$2,578.00
8"	\$3,541.00
10"	\$4,586.00
12"	\$6,915.00
14"	\$11,882.00
16"	\$13,236.00

Monel Screen Adders For Y-Strainers

MODELS 11M, 351M & 352M ONLY	LIST PRICE ADDER
MESH 20-30	
1/4"	\$18.25
3/8"	\$18.25
1/2"	\$18.25
3/4"	\$26.50
1"	\$36.00
1-1/4"	\$42.75
1-1/2"	\$52.50
2"	\$58.00

PERFORATIONS	LIST PRICE ADDER
.033, .045, .062, .125, 5/32"	
1/4"	\$29.25
3/8"	\$29.25
1/2"	\$29.25
3/4"	\$42.75
1"	\$55.25
1-1/4"	\$84.00
1-1/2"	\$107.50
2"	\$117.00
2-1/2"	\$158.50
3"	\$227.00
4"	\$497.00
5"	\$957.50
6"	\$957.50
8"	\$1,807.00
10"	\$2,759.00
12"	\$3,265.00
14"	\$3,549.00
16"	\$4,245.00

5/32" PERFORATION, LINED WITH MESH	LIST PRICE ADDER
(20,30,40,60,80,100 mesh)	
1/4"	\$58.00
3/8"	\$58.00
1/2"	\$58.00
3/4"	\$71.50
1"	\$77.25
1-1/4"	\$142.00
1-1/2"	\$142.00
2"	\$301.50
2-1/2"	\$458.50
3"	\$458.50
4"	\$719.00
5"	\$1,149.00
6"	\$1,149.00
8"	\$2,307.00
10"	\$3,193.00
12"	\$3,902.00
14"	\$6,411.00
16"	\$6,982.00

Drilled Tapped and Plugged Gauge Ports

PRODUCT RANGE	ALL
PORT SIZE	1/8" & 1/4" ONLY
	CALL FOR LARGER THREADED PORT SIZES
NET PRICE ADDER	\$62.25 per strainer (NORMALLY 2 WILL BE SPECIFIED)
NET PRICE INCLUDES	DRILLING, TAPPING, AND INSTALLING PLUG OF APPROPRIATE MATERIAL TESTING OF UNIT COMPLETED AFTER FINAL ASSEMBLY WITH PORTS PLUGGED

NACE Certification MR01-75

SIZE	NET PRICE ADDER
1/2"	\$41.75
3/4"	\$41.75
1"	\$41.75
1-1/4"	\$41.75
1-1/2"	\$41.75
2"	\$55.25
2-1/2"	\$55.25
3"	\$55.25
4"	\$69.00
5"	\$69.00
6"	\$69.00
8"	\$96.25
10"	\$96.25
12"	\$131.00
14"	\$131.00

NACE Certification includes:
MTR with hardness
Class III Bolting
All NACE-Compliant Materials of Construction

PMI Testing (Using Niton XER Portable Analyzer)

Model# XL 3t900	\$93.25 NET each/ line item
-----------------	-----------------------------

Net Adders, Epoxy Paint

FDA Approved (NSF-61 Corvell Gray), Fusion Bonded (Black Beauty), Two Part wet

Y and Basket Strainers

SIZE	NET PRICE ADDER
1/2"	\$344.00
3/4"	\$344.00
1"	\$344.00
1-1/4"	\$344.00
1-1/2"	\$344.00
2"	\$344.00
2-1/2"	\$344.00
3"	\$412.00
4"	\$515.00
5"	\$651.50
6"	\$789.00
8"	\$1,063.00
10"	\$1,303.00
12"	\$1,578.00

Duplex Strainers

SIZE	NET PRICE ADDER
1/2"	\$686.00
3/4"	\$686.00
1"	\$686.00
1-1/4"	\$686.00
1-1/2"	\$686.00
2"	\$686.00
2-1/2"	\$686.00
3"	\$823.50
4"	\$1,029.00
5"	\$1,303.00
6"	\$1,578.00
8"	\$2,126.00
10"	\$2,606.00
12"	\$3,154.00

Oxygen Cleaning

Cleaned For Industrial Gases

Y STRAINERS	NET PRICE ADDER
1/2"	\$82.50
3/4"	\$82.50
1"	\$82.50
1-1/4"	\$103.50
1-1/2"	\$103.50
2"	\$103.50
2-1/2"	\$124.00
3"	\$124.00
4"	\$172.00
5"	\$275.50
6"	\$275.50
10"	\$3,987.00
12"	\$6,009.00
14"	\$6,775.00
16"	\$7,411.00

BASKET STRAINERS	NET PRICE ADDER
1/2"	\$103.50
3/4"	\$103.50
1"	\$117.00
1-1/4"	\$138.00
1-1/2"	\$138.00
2"	\$172.00
2-1/2"	\$220.00
3"	\$220.00
4"	\$275.50
5"	\$412.00
6"	\$412.00
8"	\$618.00
12"	\$6,009.00
14"	\$6,775.00
16"	\$7,411.00

SURE CHECK	NET PRICE ADDER
2"	\$69.00
2-1/2"	\$69.00
3"	\$69.00
4"	\$82.50
5"	\$99.00
6"	\$117.00
8"	\$172.00
10"	\$206.50
12"	\$275.50
6"	\$412.00
8"	\$618.00
12"	\$6,009.00
14"	\$6,775.00
16"	\$7,411.00

MODEL 303 SILENT CHECK	NET PRICE ADDER
1/2"	\$82.50
3/4"	\$82.50
1"	\$82.50
1-1/4"	\$82.50
1-1/2"	\$82.50
2"	\$82.50

SILENT CHECK, WAFER	NET PRICEADDER
1"	\$82.50
1-1/4"	\$82.50
1-1/2"	\$103.50
2"	\$110.00
2-1/2"	\$124.00
3"	\$138.00
4"	\$172.00
5"	\$206.50
6"	\$241.00
8"	\$275.50

SILENT CHECK, GLOBE STYLE	\$3,528.00
2"	\$124.00
2-1/2"	\$138.00
3"	\$172.00
4"	\$192.50
5"	\$220.00
6"	\$275.50
8"	\$412.00

\$243.50

CLEANING INCLUDES:

Cleaning for Industrial gases, including non-medical oxygen Per MSS Specification
Units are individually bagged and tagged as cleaned Customer special specifications are POA

Notes

For Technical Assistance Call Your Authorized Mueller Steam Specialty Representative.



A WATTS Brand

USA: Tel: (800) 334-6259 • Fax: (800) 421-6772 • MuellerSteam.com
Latin America: Tel: (52) 55-4122-0138 • MuellerSteam.com